Replacement Parts Manual

SOF- SERIES OIL HORIZONTAL FURNACES

General Notes

- Revised and/or additional pages may be issued from time to time.
- A complete and current manual consists of pages shown in the following contents section.

Important

- Contact the installing and/or local Bard distributor for all parts requirements. Make sure you have the complete model and serial number available from the unit rating plates.

Contents

Description	Page
Cabinets, Blowers, and Heat Exchangers	
♦ Exploded View	1
♦ Usage List	2
Burner Components	
♦ Exploded View	3
♦ Usage Lists	4
Cross Reference Listing	
♦ Bard vs. Vendor Part Numbers	5



Bard Manufacturing Company, Inc.
Bryan, Ohio 43506

Since 1914...Moving ahead, just as planned.

Manual: 2110-919B
File: Tab III
Date: 04-07-98

CABINETS, BLOWERS, and HEAT EXCHANGERS

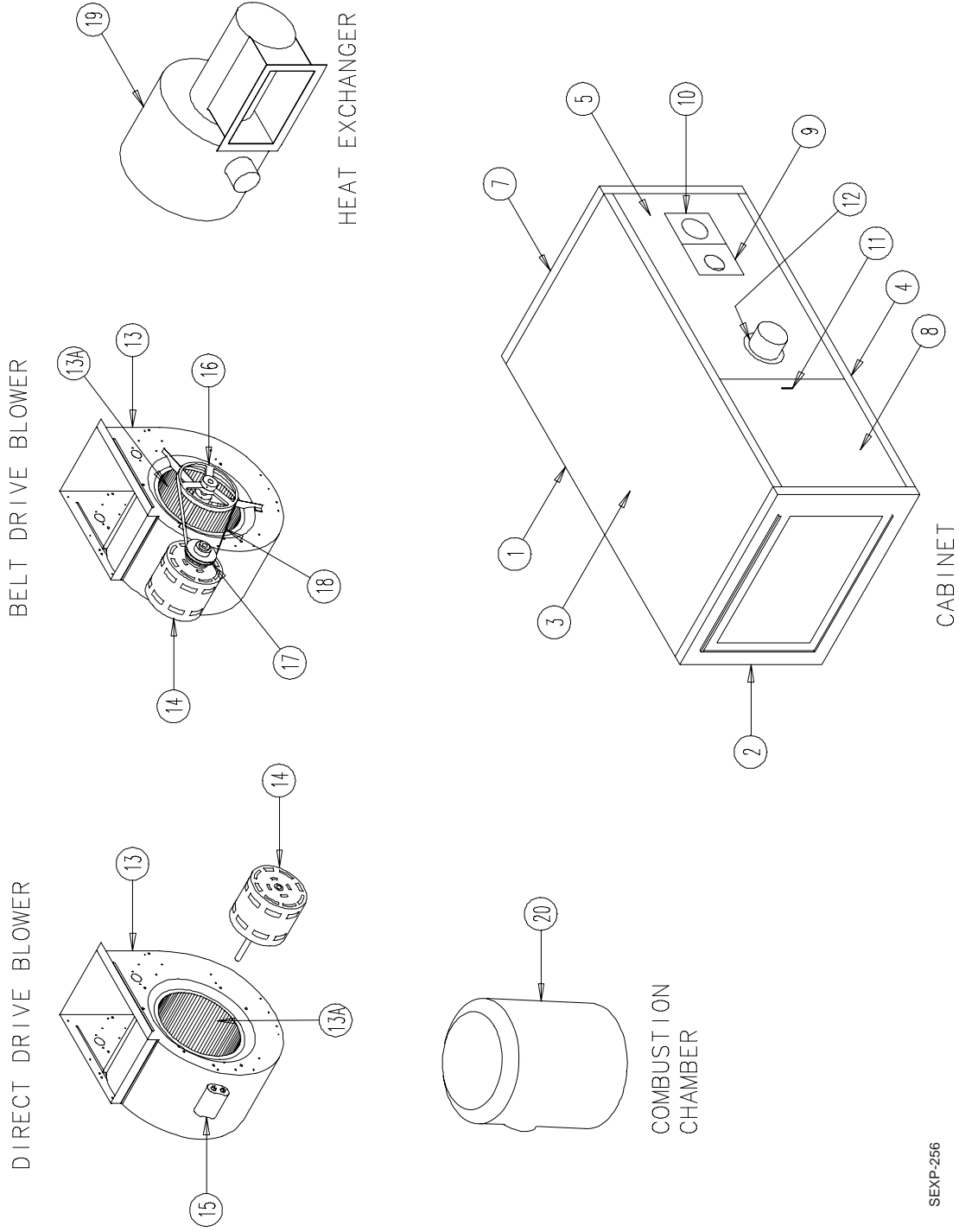

SEXP-256

CABINETS, BLOWERS, and HEAT EXCHANGERS

ITEM	DESCRIPTION	SOF075D36A	SOF100D36A	SOF120D48A	SOF140D60A	SOF175D60A	SOF265B90A
1	Rear Panel	9049-001	9049-001	9049-002	9049-002	9049-003	9049-004
2	Inlet Panel - includes Filter Rack	9049-005	9049-005	9049-006	9049-006	9049-007	9049-008
3	Top Panel	9049-009	9049-009	9049-010	9049-010	9049-011	9049-012
4	Bottom Panel	9049-013	9049-013	9049-014	9049-014	9049-015	9049-016
5	Front Panel	9049-017	9049-017	9049-018	9049-018	9049-019	9049-020
*	Blower Divider Panel	9049-021	9049-021	9049-022	9049-022	9049-023	9049-024
7	Discharge Panel	9049-025	9049-025	9049-026	9049-026	9049-027	9049-028
8	Blower Access Door	9049-029	9049-029	9049-030	9049-030	9049-031	9049-032
9	Upper Oil Door	9049-033	9049-033	9049-033	9049-033	9049-033	9049-033
*	Upper Oil Door Gasket	9049-070	9049-070	9049-070	9049-070	9049-070	9049-070
10	Lower Oil Door	9049-034	9049-034	9049-034	9049-034	9049-034	9049-034
*	Lower Oil Door Gasket	9049-071	9049-071	9049-071	9049-071	9049-071	9049-071
11	Door Handle	9049-035	9049-035	9049-035	9049-035	9049-035	9049-035
12	Finish Collar	9049-036	9049-036	9049-037	9049-037	9049-038	9049-039
13	Blower Assembly - Housing and Wheel	9049-040	9049-040	9049-041	9049-041	9049-041	9049-042
13A	Blower Wheel Only	9049-043	9049-043	9049-044	9049-044	9049-044	9049-045
14	Motor	9049-046	9049-047	9049-048	9049-048	9049-049	9049-050
*	Direct Drive Motor Mount	NR	NR	NR	NR	9049-072	N/A
15	Motor Capacitor	8552-002	8552-002	8552-005	8552-005	8550-033	N/A
16	Blower Pulley - Belt Drive	N/A	N/A	N/A	N/A	N/A	9049-051
17	Motor Pulley - Belt Drive	N/A	N/A	N/A	N/A	N/A	9049-052
18	Belt	N/A	N/A	N/A	N/A	N/A	9049-053
19	Heat Exchanger	9049-054	9049-055	9049-56	9049-057	9049-058	9049-059
20	Combustion Chamber	9049-060	9049-060	9049-061	9049-061	9049-061	9049-062
*	Air Filter - Disposable Fiberglass	20 x 20 (1)	20 x 20 (1)	20 x 25 (1)	20 x 25 (1)	16 x 25 (2)	16 x 16 (4)
*	Barometric Damper	9049-063	9049-063	9049-063	9049-063	9049-064	9049-065
*	Wire Harness	9049-066	9049-066	9049-067	9049-067	9049-068	9049-068
*	Fan Control Limit	9049-073	9049-073	9049-073	9049-073	9049-069	9049-069

BURNER COMPONENTS

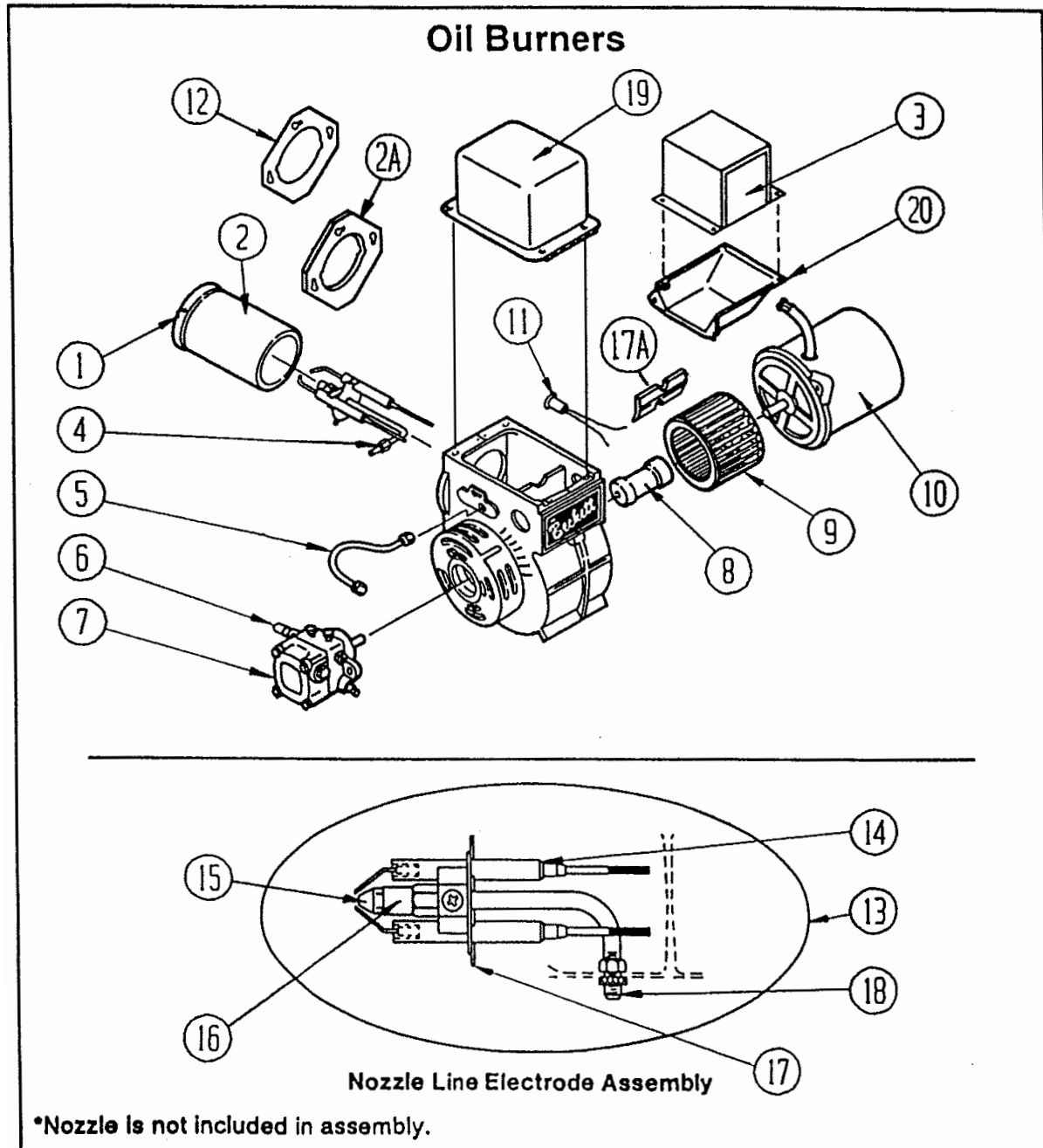

BURNER COMPONENTS

Drawing No.	Bard Part No.	Beckett Part No.	Description	SOF075	SOF100	SOF120	SOF140	SOF175	SOF265
1	9022-050	51360	F3 Head Kit *	X	X	X	X		
1	9022-026	F12	Head					X	
1	9022-075	F31	Head						X
2	9022-076	329076	Air Tube – Stainless Steel	X	X	X	X	X	X
2A	9022-077	323001BK	Flange	X	X	X	X	X	X
3	9022-056	7022U	Primary Control	X	X	X	X	X	X
4	9022-007	571801	Bulkhead Fitting	X	X	X	X	X	X
5	9022-008	5636	Connector Tube	X	X	X	X	X	X
6	9022-009	2256	Pump Outlet Elbow	X	X	X	X	X	X
7	9022-010	2460U	Pump – Single Stage	X	X	X	X	X	X
8	9022-011	2454	Coupling	X	X	X	X	X	X
9	9022-045	2999U	Blower Wheel	X	X	X	X	X	X
10	9022-013	2456U	Motor 1/7 HP 3450 RPM	X	X	X	X	X	X
11	9022-054	7006U	Cad Cell	X	X	X	X	X	X
12	9022-030	3416	Mounting Flange Gasket	X	X	X	X	X	X
13	9022-014	NL90YH	Nozzle Line Electrode Assembly	X	X	X	X	X	X
14	9022-017	5780	Electrode Insulator Assembly	X	X	X	X	X	X
15	See Note 1	Nozzle	.50 GPH 70 Deg. Hollow	X					
15	See Note 1	Nozzle	.75 GPH 70 Deg. Hollow		X				
15	See Note 1	Nozzle	.85 GPH 70 Deg. Hollow			X			
15	See Note 1	Nozzle	1.10 GPH 70 Deg. Hollow				X		
15	See Note 1	Nozzle	1.35 GPH 70 Deg. Hollow					X	
15	See Note 1	Nozzle	2.00 GPH 70 Deg. Hollow						X
16	9022-016	213U	Nozzle Adapter	X	X	X	X	X	X
17	9022-035	3383P	Static Plate	X	X	X	X	X	
17A	9022-078	3708	Low Fire Baffle	X	X	X	X		
18	9022-018	3666	Bulkhead Fitting Locknut	X	X	X	X	X	X
19	9022-057	2442U	Ignition Transformer	X	X	X	X	X	X
20	9022-058	5770	Electrical Box Kit	X	X	X	X	X	X

* Includes Ceramic Heat Shield 9022-048 (31517) and Retainer 9022-049 (3716)

NOTE 1: These are the specified nozzle sizes for the rated 140 PSIG pump pressure. Obtain nozzles from local supply house.

BARD vs. VENDOR PART NUMBER CROSS REFERENCE

Bard Part No.	Vendor Part No.		Bard Part No.	Vendor Part No.
8552-002	5MFD 370V		9049-035	DH175
8552-005	10MFD 370V		9049-036	90FC
8552-033	20MFD 370V		9049-037	140FC
			9049-038	230FC
			9049-039	350FC
9049-001	126B		9049-040	PD0909U
9049-002	1213G		9049-041	PD1212U
9049-003	122A		9049-042	PD1215U
9049-004	23C		9049-043	WHEELASSY 9
9049-005	126G		9049-044	WHEELASSY 12
9049-006	1213F		9049-045	WHEELASSY 15
9049-007	122B		9049-046	MTR13DD
9049-008	130C		9049-047	MTR12DD
9049-009	126DRT		9049-048	MTR34DD
9049-010	1213BRT		9049-049	MTR1DD
9049-011	122F		9049-050	MTR1.5BD
9049-012	23A		9049-051	7"
9049-013	126DLT		9049-052	4" Adj.
9049-014	1213BLT		9049-053	AP-44
9049-015	122E		9049-054	HT/EXC SO90
9049-016	23B		9049-055	HT/EXC SO120
9049-017	126F		9049-056	HT/EXC SO140
9049-018	1213C		9049-057	HT/EXC SO175
9049-019	125E		9049-058	HT/EXC SO230
9049-020	23E		9049-059	HT/EXC SO350
9049-021	126A		9049-060	V65
9049-022	21461B		9049-061	V150
9049-023	125D		9049-062	V350
9049-024	131A		9049-063	6 BT (6")
9049-025	127A		9049-064	7 BT (7")
9049-026	129H		9049-065	9 BT (9")
9049-027	125A		9049-066	WHS90
9049-028	22B		9049-067	WHS140
9049-029	126C		9049-068	WHS140-350
9049-030	1213B		9049-069	L4064B 5"
9049-031	122D		9049-070	216061G
9049-032	26A		9049-071	216062SG
9049-033	216061		9049-072	DD MTR BRK 12
9049-034	216062S		9049-073	L40464B 11-1/2"