



Climate Control Solutions

Bard Manufacturing Company, Inc.  
Bryan, Ohio 43506

## MODELS:

QRASP3-X, QRASP3-4, QRASP3-V

QRASP5-X, QRASP5-4, QRASP5-V

## MODEL FEATURES

This Installation Instruction covers the installation of the Bard Q-Tec Return Air Acoustical Plenum.

The QRASP3 Series fits cabinet sizes that are 42" wide and includes Bard QW2S and QW3S Models.

The QRASP5 Series fits cabinet sizes that are 48" wide and includes Bard QW4S and QW5S Models.

The -X code in the model number designates a beige pre-paint finish.

The -4 code in the model number designates a buckeye gray pre-paint finish.

The -V code in the model number designates a slate vinyl clad front door with buckeye gray pre-painted side extensions.

Once the QRASP is installed, it will have no effect on the full and complete serviceability of the unit in which it is applied.

All work will be able to be performed without removal of the Sound Plenum.

**NOTE: It is highly recommended that the unit be connected to the wall sleeve or wall bracket with the side trim installed prior to installing the QRASP.**

1. Uncarton the assembly from Box 1 of 2 and locate the accessory bag that contains additional fasteners required to install the assembly onto the unit front.
2. Use a T-25 torx drive to remove the screws from the unit front (as marked in Figure 1).
3. Locate the sidepiece with "UL" stamped into it. (Hint: it has a ½ hinge attached to it.) (See Figure 2, Number 1.) This panel will secure to the Upper Left of the unit front using one screw that was removed in Step #2.
4. Locate the sidepiece with "LL" stamped into it. (Hint: it has a ½ hinge attached to it.) (See Figure 2, Number 2.) This panel will attach to the Lower Left of the unit front using one screw that was removed in Step #2.
5. Acquire two of the torx-headed screws provided in the accessory hardware kit and drive screws down from the Upper Left side into the Lower Left side (See Figure 2, Number 3).
6. Locate the side panel without any letters stamped into it (See Figure 2, Number 4). This panel will secure to the Upper Right of the unit front using two screws that were removed in Step #2.
7. Locate the side panel with the letter "L" stamped into it (See Figure 2, Number 5). This panel will attach to the Lower Right of the unit front using one screw that was removed in Step #2.
8. Acquire two of the torx-headed screws provided in the accessory hardware kit and drive screws down from the Upper Right side into the Lower Right side (See Figure 2, Number 3).
9. Locate the Sheet-Metal Top (top piece has a longer rear flange {single bend} where it contacts unit front than what bottom piece has). Acquire four of the torx-headed screws provided in the accessory hardware kit (See Figure 2, Number 7). Use the screws to attach the top – driving the (4) screws in from the Upper Sides to secure in place.
10. Locate the Sheet-Metal Bottom (bottom piece has a shorter rear flange {single bend} where it contacts unit front than what top piece has). Acquire four of the torx-headed screws provided in the accessory hardware kit (See Figure 2, Number 8). Use the screws to attach the bottom – driving the (4) screws in from the Lower Sides to secure into place.
11. Locate two self-drilling screws (hex-headed) provided in the accessory hardware kit. Making sure the sides are in good alignment – drive the screws into the unit front through the Lower Left and Lower Right sides (See Figure 2, Numbers 9 & 10).
12. Open up Box 2 of 2 removing all parts from the box.
13. Locate the Lower Left side with "LL" stamped in it at what will be the bottom rear corner once installed onto the unit. (Hint: it has only partial slots punched into it.) (See Figure 3, Number 1.)
14. Locate one of the End Fills that will fit inside the end of the Lower Left side in the end that does not have slots with the insulation facing up (interior) and secure with four torx-headed screws provided in the accessory hardware kit (See Figure 3, Number 2).
15. Locate the center partition that fits the Lower Left side with the insulation facing upward as shown (See Figure 3, Number 3). Secure in place with four torx-headed screws provided in the accessory hardware kit.

## MODEL FEATURES (Cont'd.)

16. Locate one of the Upper Sides (they are identical and have slots running the entire length of the back). Locate it vertically to the Lower Left side and drive screws downward to secure the two parts together using four screws provided in the accessory hardware kit (See Figure 3, Number 4).
17. Locate an End Fill to fit into the Upper Left side that puts the insulation on the interior of the assembly and secure with four torx-headed screws provided in the accessory hardware kit (See Figure 3, Number 5).
18. Secure the Left Side Assembly to the QRASP front and unit side with 12 torx-headed screws provided in the accessory hardware kit.
19. Locate the Lower Right side with "L" stamped in it at what will be the bottom rear corner once installed onto the unit. (Hint: it has only partial slots punched into it.) (See Figure 3, Number 6.)
20. Locate one of the End Fills that will fit inside the end of the Lower Right side in the end that does not have slots with the insulation facing up (interior) and secure with four torx-headed screws provided in the accessory hardware kit. (See Figure 3, Number 7.)
21. Locate the center partition that fits the Lower Right side with the insulation facing upward as shown (See Figure 3, Number 8). Secure in place with four torx-headed screws provided in the accessory hardware kit.
22. Locate the second Upper Sides (upper sides are identical and have slots running the entire length of the back). Locate it vertically to the Lower Right side and drive screws downward to secure the two parts together using four screws provided in the accessory hardware kit (See Figure 3, Number 9).
23. Locate the remaining End Fill to fit into the Upper Right side that puts the insulation on the interior of the assembly and secure with four torx-headed screws provided in the accessory hardware kit (See Figure 3, Number 10).
24. Secure the Right Side Assembly to the QRASP Front and Unit Side with 12 torx-headed screws provided in the accessory hardware kit.
25. Secure the Left Side Assembly to the QRASP Front and Unit Side with 12 torx-headed screws provided in the accessory hardware kit.
26. Locate the Upper Door. (Hint: it has single latch and offset bend.) (See Figure 4, Number 1.) Hang door on the hinge halves of the Upper Left side.
27. Locate the Lower Door. (Hint: it has two latches.) (See Figure 4, Number 2.) Hang door on the hinge halves of the Lower Left side.
28. Locate three torx-headed screws from the accessory hardware kit (See Figure 4, Number 3). Drive screws downward from Upper Door into the Lower Door to secure the two pieces together.
29. Swing doors closed and clasp the latches shut. The latches are pre-adjusted at the factory, but should be evaluated for any required final adjustment.

FIGURE 1

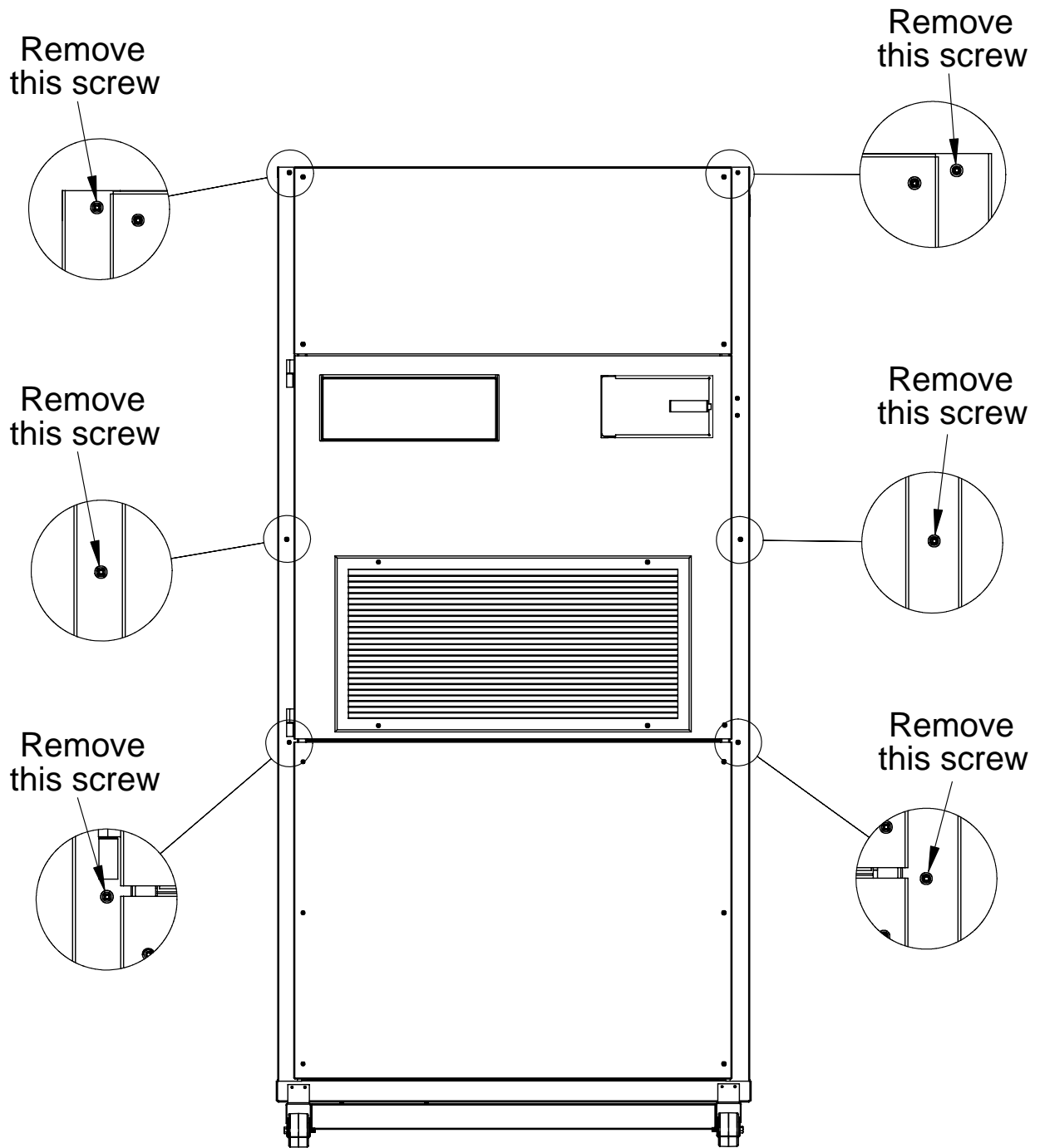

MIS-1982

FIGURE 2

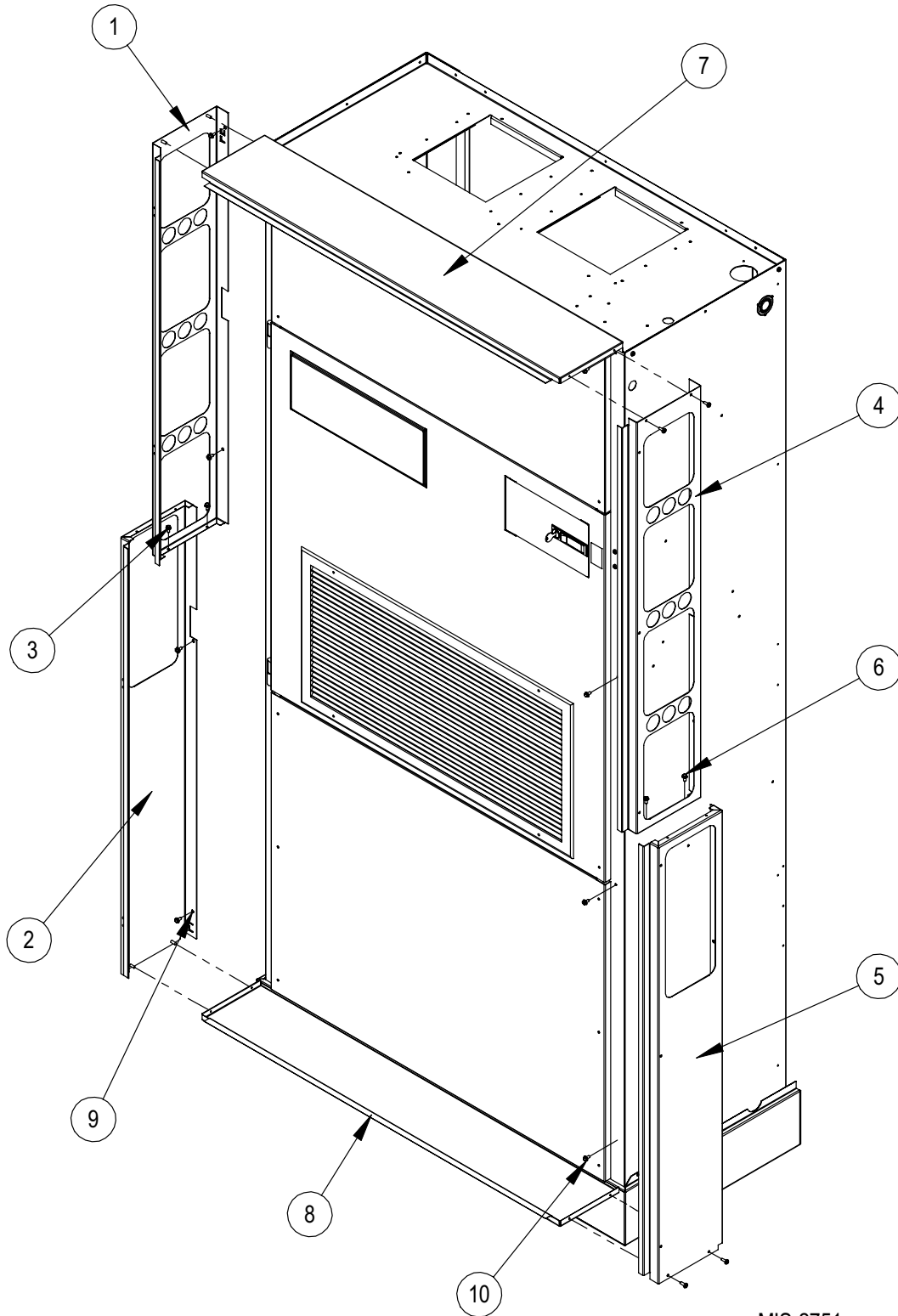

MIS-2751

FIGURE 3

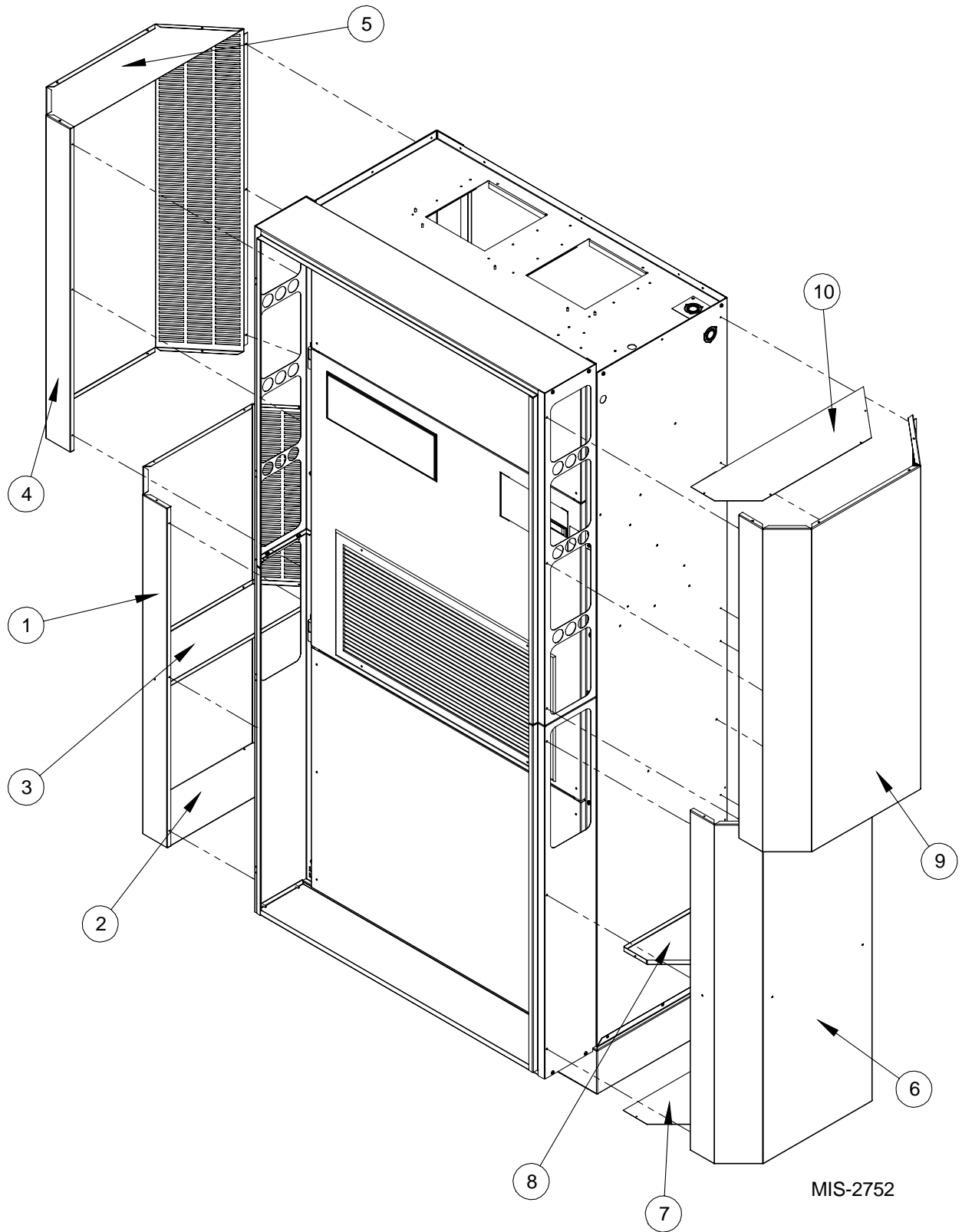

MIS-2752

FIGURE 4

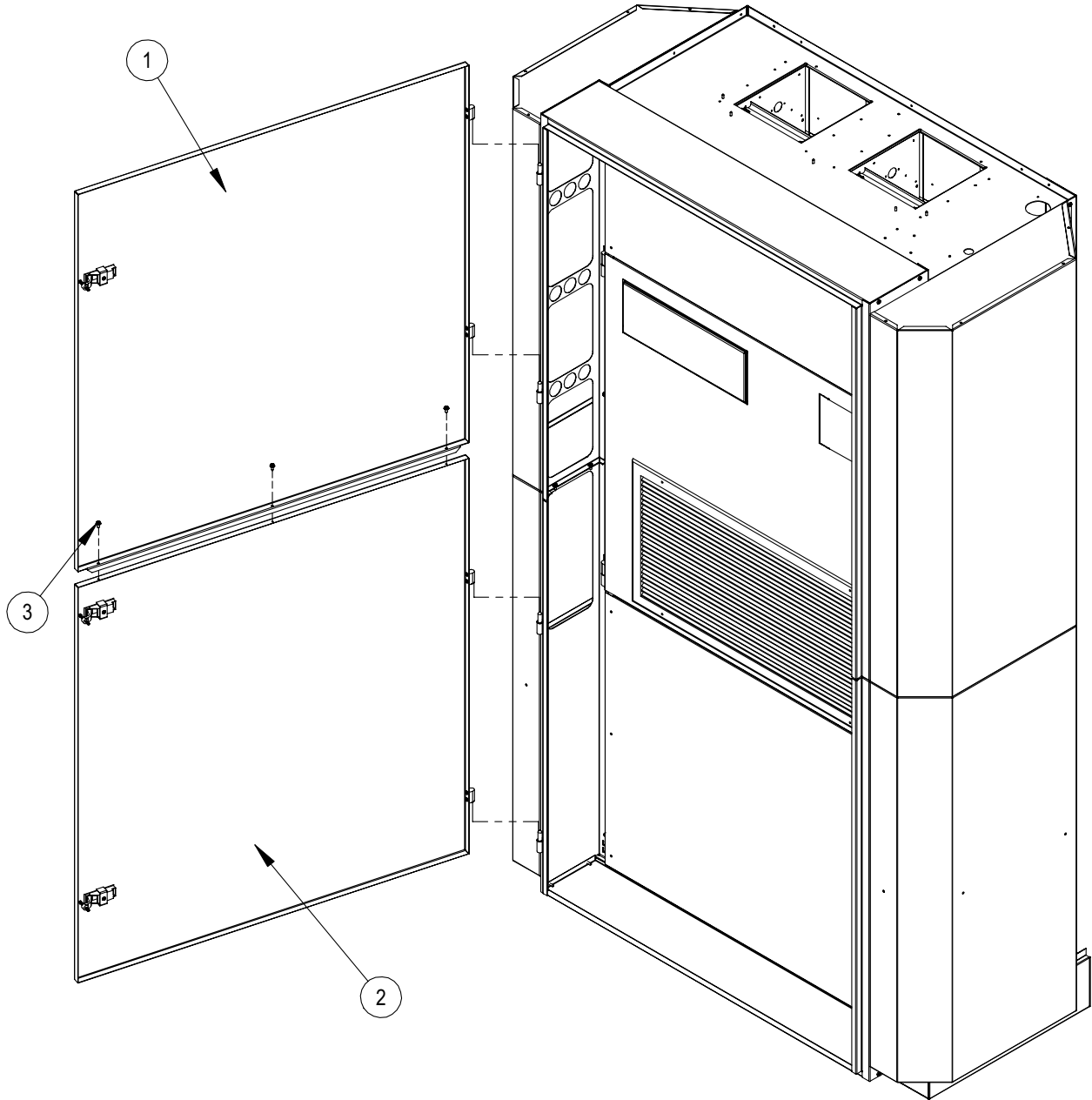

MIS-2753