

# REPLACEMENT PARTS MANUAL

## SPLIT HEAT PUMPS

MODELS: 42HPQ4, 48HPQ5, 60HPQ5

Manual 2110-053

Revision E

Date 07-20-94

Supersedes 12-20-93

\*\*\*\*\*  
\* GENERAL NOTES \*  
\*\*\*\*\*

\*Revised and/or additional pages may be issued from time to time.  
\*A complete and current manual consists of pages dated as shown in the following index.

\*\*\*\*\*  
\*\* INDEX \*\*  
\*\*\*\*\*

<u>Page Description</u>	<u>Page</u>	<u>Date</u>	<u>Supersedes</u>
Functional and Cabinet Components--Exploded View	1	07-11-89	
" " " --Usage List	2	04-06-93	01-06-90
Functional and Cabinet Components--Exploded View	3	07-11-89	
" " " --Usage List	4	04-06-93	02-15-91
Control Panel--Layout	5	07-11-89	
" " --Usage List	6	07-20-94	01-06-90
Control Panel--Layout	7	07-11-89	
" " --Usage List	8	07-20-94	12-20-93

\*\*\*\*\*  
\*\*\* IMPORTANT \*\*\*  
\*\*\*\*\*

Contact the installing and/or local Bard distributor for all parts requirements. Make sure you have the complete model and serial number available from the unit rating plate.

BARD MANUFACTURING COMPANY

BRYAN, OHIO 43506

FUNCTIONAL AND CABINET COMPONENTS

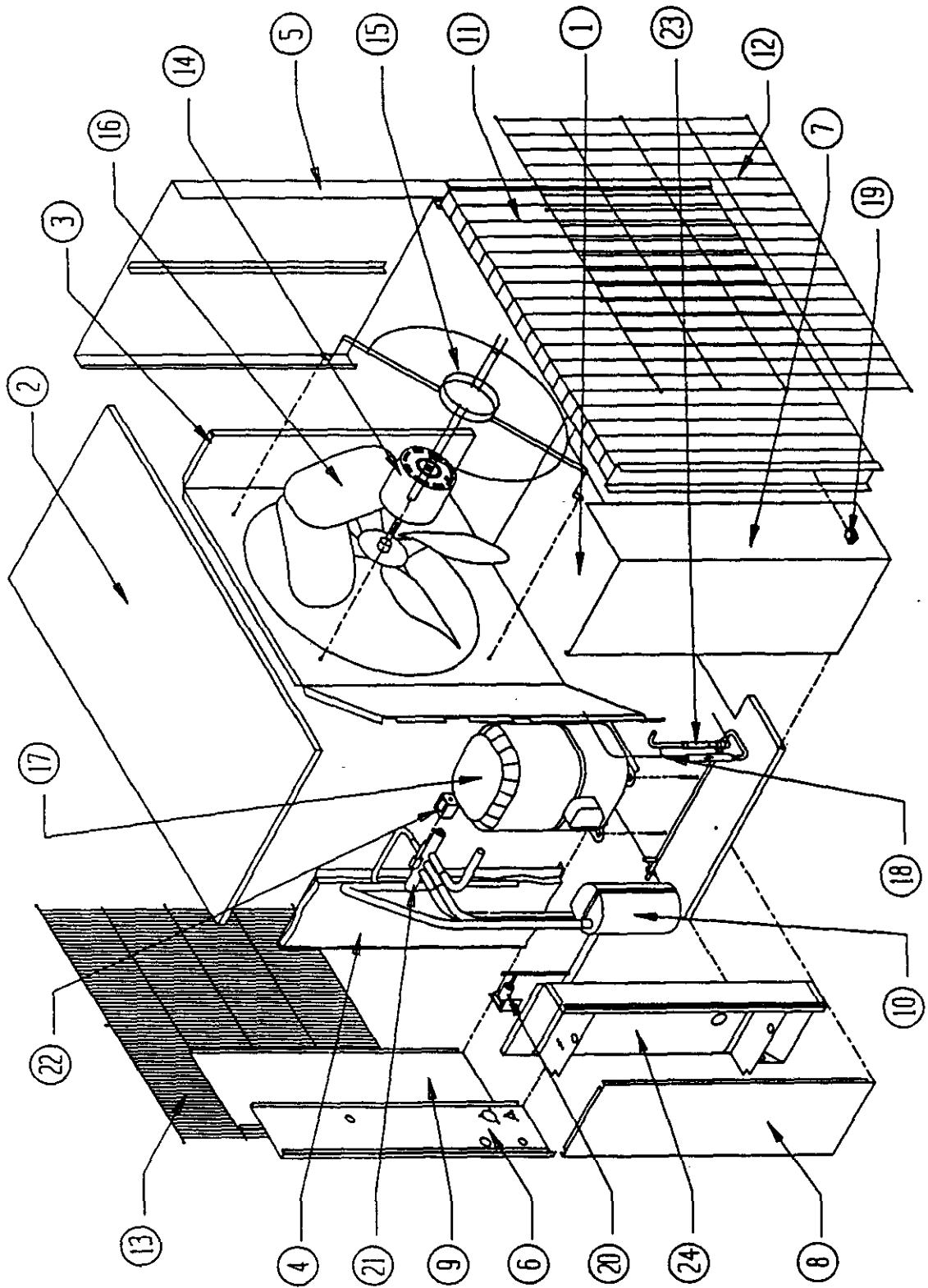

Date: 7-11-89  
Supersedes:

FUNCTIONAL AND CABINET COMPONENTS

Dwg. No.	Part No.	Description	4	4	4	4	4	4	6	6	6
			H P Q 4	H P Q 4	H P Q 4	H P Q 5	H P Q 5	H P Q 5	H P Q 5	H P Q 5	H P Q 5
			B	C		B	C		B	C	
1	127-020	Base	X	X	X	X	X	X	X	X	X
2	506-019	Top	X	X	X	X	X	X	X	X	X
3	124-003	Fan Shroud	X	X	X	X	X	X	X	X	X
4	520-021	Compressor Partition	X	X	X	X	X	X	X	X	X
5	101-026	Side Right	X	X	X	X	X	X	X	X	X
6	148-035	Corner Control Box	X	X	X	X	X	X	X	X	X
7	149-034	Corner Condenser	X	X	X	X	X	X	X	X	X
8	132-022	Control Panel Cover	X	X	X	X	X	X	X	X	X
9	552-018	Door Compressor Access	X	X	X	X	X	X	X	X	X
10	5202-011	Accumulator				X	X	X			
10	5202-016	Accumulator	X	X	X						
10	5202-018	Accumulator							X	X	X
11	5051-037	Condenser Coil	X	X	X						
11	5051-029	Condenser Coil				X	X	X	X	X	X
12	7051-005	Grille Condenser	X	X	X	X	X	X	X	X	X
13	7051-004	Grille--Inlet	X	X	X	X	X	X	X	X	X
14	8105-035	Motor--Fan 1/3	X	X		X	X		X	X	
14	8105-030	Motor--Fan 1/3 HP 460V			X			X			X
15	8200-004	Motor Mount Fan	X	X	X	X	X	X	X	X	X
16	5151-017	Fan Blade FA2430-4B	X	X	X	X	X	X	X	X	X
17	8000-063	Compressor CRK3-0325	X								
17	8000-088	Compressor AV145RT		X							
17	8000-089	Compressor AV145TT			X						
17	8000-081	Compressor AV168ET				X					
17	8000-082	Compressor AV169RT					X				
17	8000-083	Compressor AV169TT						X			
17	8000-074	Compressor AG134ET							X		
17	8000-075	Compressor AG134RT								X	
17	8000-049	Compressor AG133UT									X
18	800-0115	Capillary Tube Assembly	X	X	X						
18	800-0114	Capillary Tube Assembly				X	X	X			
18	800-0113	Capillary Tube Assembly							X	X	X
19	8408-017	Defrost Thermostat	X	X	X	X	X	X	X	X	X
20	8406-067	High Pressure Switch	X	X	X	X	X	X	X	X	X
21	5650-006	Reversing Valve (See Note A)	X	X	X	X	X	X			
21	5650-010	Reversing Valve (See Note A)							X	X	X
21	5650-015	Reversing Valve (See Note B)	X	X	X	X	X	X			
21	5650-019	Reversing Valve (See Note B)							X	X	X
22	5650-008	Solenoid Coil (See Note A)	X	X	X	X	X	X	X	X	X
22	5650-023	Solenoid Coil (See Note B)	X	X	X	X	X	X	X	X	X
23	5651-036	Check Valve	X	X	X	X	X	X	X	X	X
24	*	Control Panel									
		*See control panel drawing									

NOTE A: For units produced before date code D93.

NOTE B: For units products with date code D93 and after.

Date: 04-06-93  
Supersedes: 01-06-90

FUNCTIONAL AND CABINET COMPONENTS

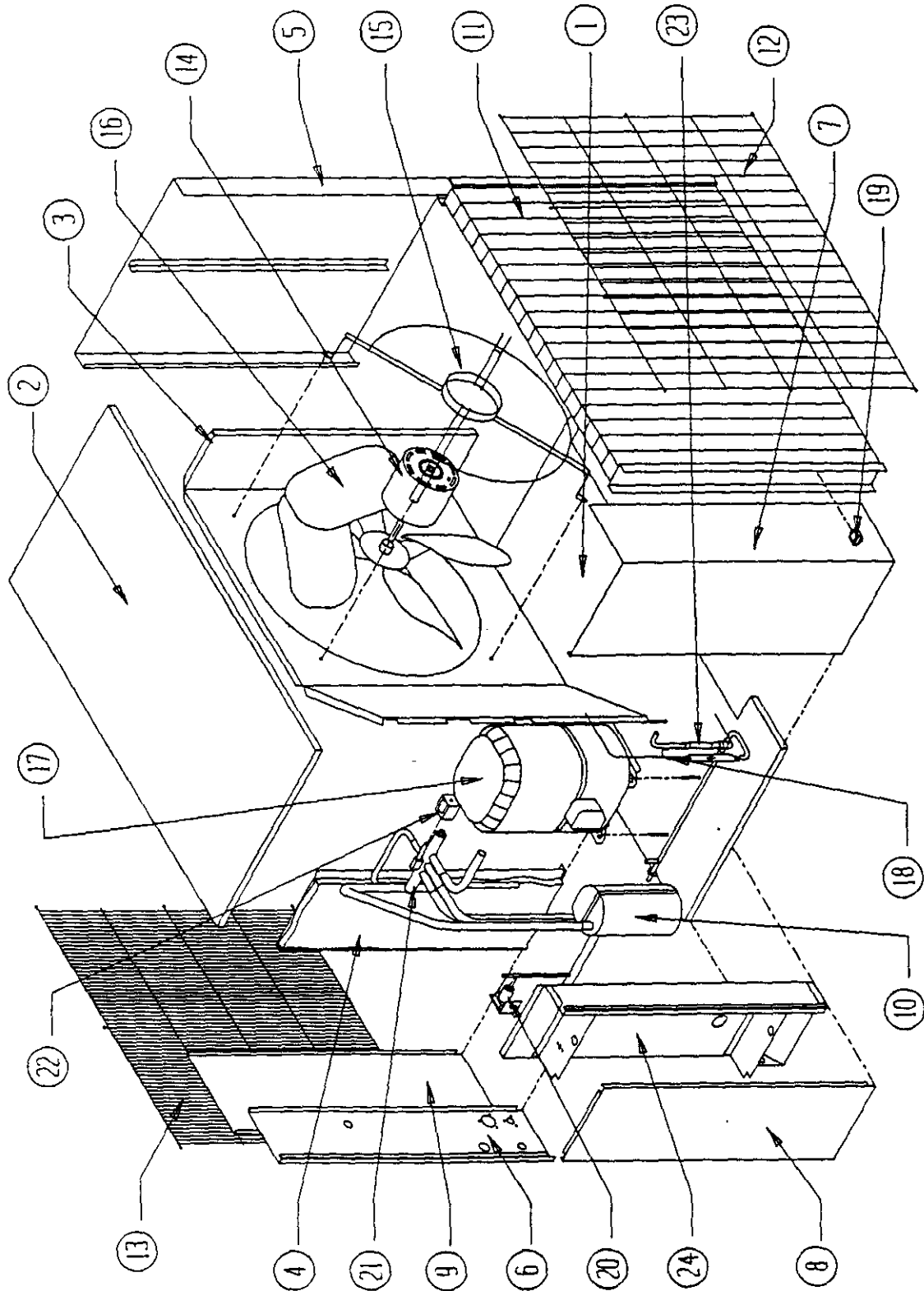

Date: 7-11-89  
Supersedes:

FUNCTIONAL AND CABINET COMPONENTS

Dwg. No.	Part No.	Description	4	4	4	4	4	4	6	6	6
			H	H	H	H	H	H	H	H	H
			P	P	P	P	P	P	P	P	P
			Q	Q	Q	Q	Q	Q	Q	Q	Q
			4	4	4	5	5	5	5	5	5
			D	E	F	E	F	G	E	F	G
1	127-020	Base	X	X	X	X	X	X	X	X	X
2	506-019	Top	X	X	X	X	X	X	X	X	X
3	124-003	Fan Shroud	X	X	X	X	X	X	X	X	X
4	520-021	Compressor Partition	X	X	X	X	X	X	X	X	X
5	101-026	Side Right	X	X	X	X	X	X	X	X	X
6	148-035	Corner Control Box	X	X	X	X	X	X	X	X	X
7	149-034	Corner Condenser	X	X	X	X	X	X	X	X	X
8	132-022	Control Panel Cover	X	X	X	X	X	X	X	X	X
9	552-018	Door Compressor Access	X	X	X	X	X	X	X	X	X
10	5202-011	Accumulator				X	X	X			
10	5202-016	Accumulator	X	X	X						
10	5202-018	Accumulator							X	X	X
11	5051-037	Condenser Coil	X	X	X						
11	5051-029	Condenser Coil				X	X	X	X	X	X
12	7051-005	Grille Condenser	X	X	X	X	X	X	X	X	X
13	7051-004	Grille--Inlet	X	X	X	X	X	X	X	X	X
14	8105-014	Motor--Fan 1/3	X	X	X	X	X	X	X	X	X
15	8200-004	Motor Mount Fan	X	X	X	X	X	X	X	X	X
16	5151-026	Fan Blade FA2430-4B	X	X	X	X	X	X	X	X	X
17	8000-039	Compressor	X								
17	8000-088	Compressor		X							
17	8000-089	Compressor			X						
17	8000-081	Compressor						X			
17	8000-082	Compressor				X					
17	8000-083	Compressor					X				
17	8000-078	Compressor							X		
17	8000-079	Compressor								X	
17	8000-077	Compressor									X
18	800-0115	Capillary Tube Assembly	X	X	X						
18	800-0114	Capillary Tube Assembly				X	X	X			
18	800-0022	Capillary Tube Assembly							X	X	X
19	8408-016	Defrost Thermostat	X	X	X	X	X	X	X	X	X
20	8406-067	High Pressure Switch	X	X	X	X	X	X	X	X	X
21	5650-006	Reversing Valve (See Note A)	X	X	X	X	X	X			
21	5650-010	Reversing Valve (See Note A)							X	X	X
21	5650-015	Reversing Valve (See Note B)	X	X	X	X	X	X			
21	5650-019	Reversing Valve (See Note B)							X	X	X
22	5650-008	Solenoid Coil (See Note A)	X	X	X	X	X	X	X	X	X
22	5650-023	Solenoid Coil (See Note B)	X	X	X	X	X	X	X	X	X
23	5651-036	Check Valve	X	X	X	X	X	X	X	X	X
24	*	Control Panel *See control panel drawing									

NOTE A: For units produced before date code D93.

NOTE B: For units produced with date code D93 and after.

Date: 04-06-93  
Supersedes: 02-15-91

2110-053

CONTROL PANEL

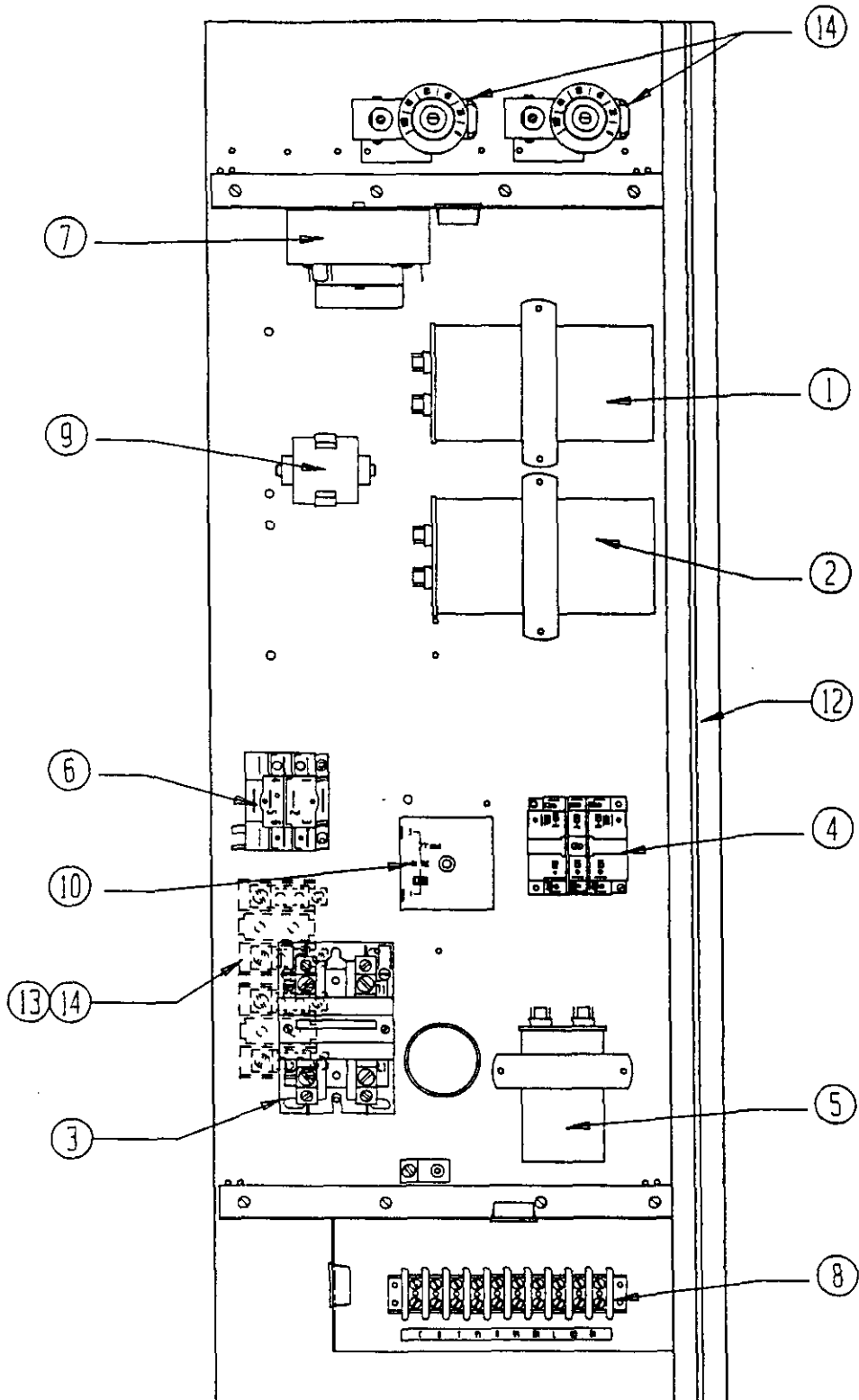

Date: 7-11-89  
Supersedes:

CONTROL PANEL

Dwg. No.	Part No.	Description	4	4	4	4	4	4	6	6	6
			2	2	2	8	8	8	0	0	0
			H	H	H	H	H	H	H	H	H
			P	P	P	P	P	P	P	P	P
			Q	Q	Q	Q	Q	Q	Q	Q	Q
			4	4	4	5	5	5	5	5	5
			B	B	C	B	C	B	C	B	C
1	8552-030	Capacitor 40/440V	x			x					
1	8552-043	Capacitor 45/370V							x		
2	8552-043	Capacitor 45/370V							x		
3	8401-010	Contactor--Comp 30A	x			x					
3	8401-002	Contactor--Comp 25A		x	x		x	x			x
3	8401-011	Contactor--Comp 30A								x	
3	8401-001	Contactor--Comp 35A							x		
4	8201-074	Relay Defrost	x	x	x	x	x	x	x	x	x
5	8552-005	Capacitor 10/370V	x	x		x	x		x	x	
5	8552-026	Capacitor 15/370V			x			x			x
6	8201-024	Relay--Compressor Fault	x			x			x		
7	8612-012	Timer	x	x	x	x	x	x	x	x	x
8	8607-011	Terminal Block	x	x	x	x	x	x	x	x	x
9	SK108	Low Voltage Kit	Fld Ins			Fld Ins			Fld Ins		
10	CGAH-404	5 Min. Time Delay	<-----Field Installed----->								
11	8408-008	Outdoor Thermostat	<-----Field Installed----->								
12	117-042	Control Panel	x	x	x	x	x	x	x	x	x
13	8607-013	Terminal Block									
14	134-051	Terminal Block Barrier									
	4040-110	Wiring Diagram	x			x					
	4040-111	Wiring Diagram							x		
	4040-210	Wiring Diagram		x			x			x	
	4040-310	Wiring Diagram			x			x			x

Date: 7-20-94  
Supersedes: 1-06-90

CONTROL PANEL

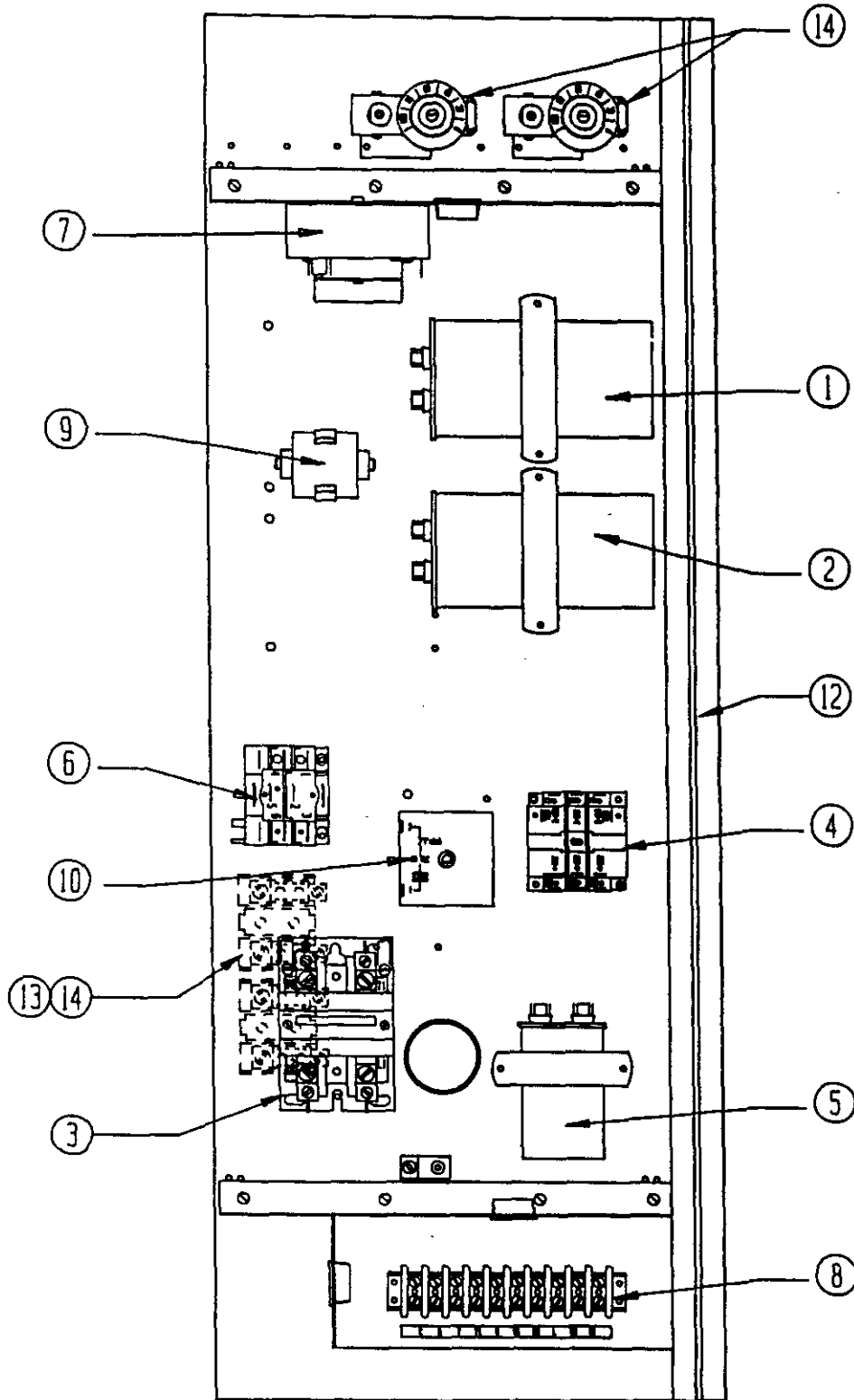

Date: 7-11-89  
Supersedes:



CONTROL PANEL

Dwg. No.	Part No.	Description	4	4	4	4	4	4	6	6	6
			2	2	2	8	8	8	0	0	0
			H	H	H	H	H	H	H	H	H
			P	P	P	P	P	P	P	P	P
			Q	Q	Q	Q	Q	Q	Q	Q	Q
			4	4	4	5	5	5	5	5	5
			D	E	F	E	F	G	E	F	G
1	8552-028	Capacitor 35/440V	x								
1	8552-030	Capacitor 40/370V						x			x
2	8552-034	Capacitor 15/440V									x
3	8401-010	Contact--Comp 30A	x					x			
3	8401-002	Contact--Comp 25A		x	x	x	x			x	
3	8401-025	Contact--Comp 35A							x		x
4	8201-074	Relay Defrost	x	x	x	x	x	x	x	x	x
5	8552-005	Capacitor 10/370V	x	x	x	x	x	x	x	x	x
6	8201-024	Relay--Compressor Fault									
7	8612-012	Timer	x	x	x	x	x	x	x	x	x
8	8607-011	Terminal Block	x	x	x	x	x	x	x	x	x
9	SK108	Low Voltage Kit	Fld Ins			Fld Ins			Fld Ins		
10	CGAH-404	5 Min. Time Delay	<-----Field Installed----->								
11	8408-008	Outdoor Thermostat	<-----Field Installed----->								
12	117-042	Control Panel	x	x	x	x	x	x	x	x	x
13	8607-013	Terminal Block			2		2			2	
14	134-051	Terminal Block Barrier			x		x			x	
	4040-410	Wiring Diagram	x					x			
	4040-510	Wiring Diagram		x		x			x		
	4040-610	Wiring Diagram			x		x			x	
	4040-411	Wiring Diagram									x

Date: 7-20-94  
Supersedes: 12-20-93

