REPLACEMENT PARTS MANUAL

WALL-MOUNTED PACKAGE AIR CONDITIONER

Models:

W17A2-A

W18A2-A

W24A2-A

W24A2-B

W24A2-C

W24A2-D

W24A2-F

General Notes

- Revised and/or additional pages may be issued from time to time.
- A complete and current manual consists of pages shown in the following contents section.

Important

- Contact the installing and/or local Bard distributor for all parts requirements. Make sure to have the complete model and serial number available from the unit rating plates.

Contents

| <u>Description</u> | <u>Page</u> |
|-----------------------|-------------|
| Cabinet Components | |
| ♦ Exploded View | 2 |
| ♦ Usage List | 3 |
| Functional Components | |
| ♦ Exploded View | 4 |
| ♦ Usage List | 5 |
| Control Panel | |
| ♦ Layout View | 6 |
| ♦ Usage List | 7 |
| Blower Assembly | |
| ♦ Exploded View | 8 |
| ♦ Usage List | 8 |



Bard Manufacturing Company, Inc.
Bryan, Ohio 43506
www.bardhvac.com

Manual: 2110-1407G
Supersedes: 2110-1407F
Date: 5-11-18

CABINET COMPONENTS

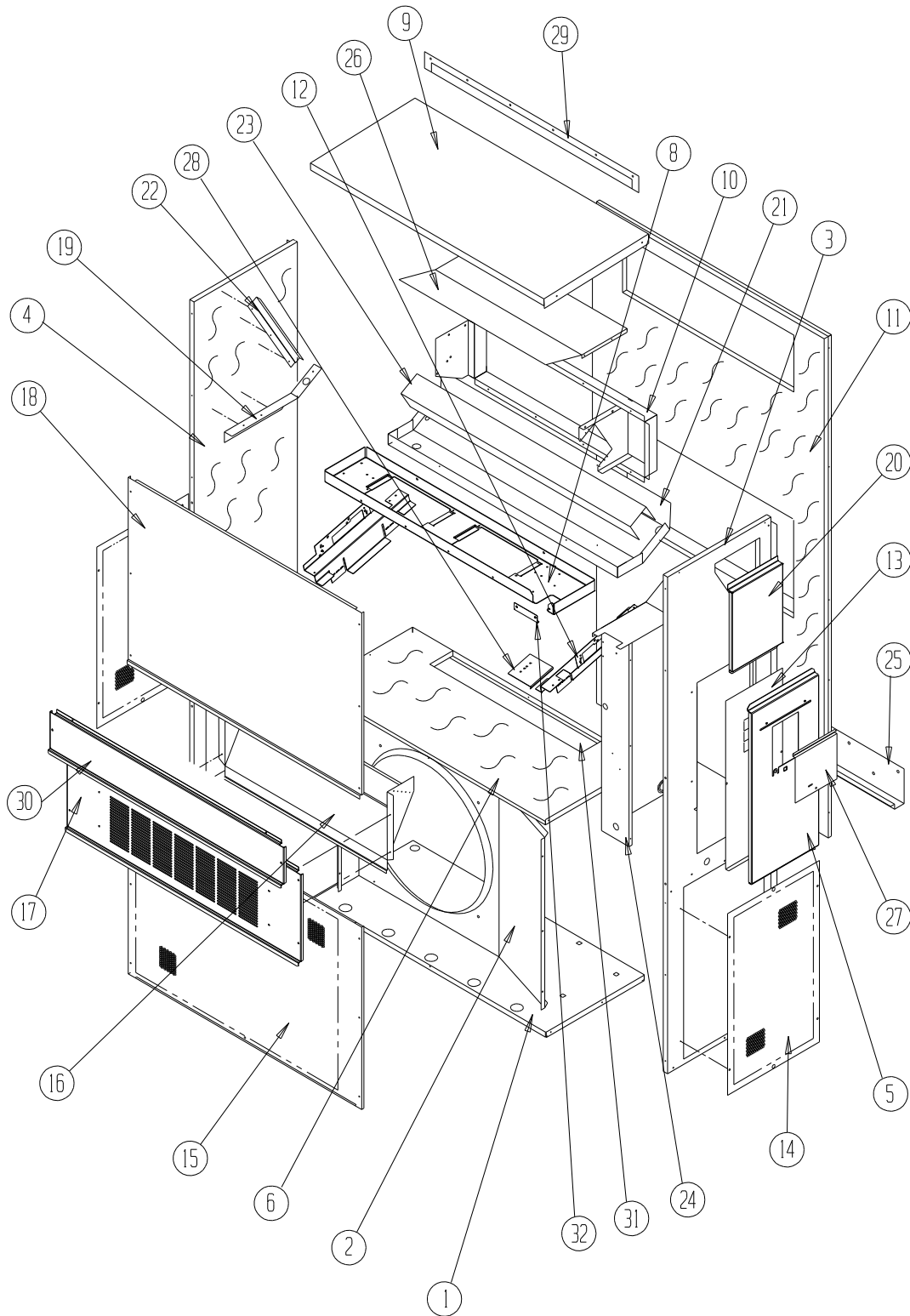

SEXP-684

CABINET COMPONENTS

| Dwg No. | Part Number | Description | W17/18A2-A | W24A2-A, B, D | W24A2-F, C |
|---------|------------------------|--|------------|---------------|------------|
| 1 | 127-467 | Lower Base | X | X | X |
| 1 | 127-469 ② | Lower Base | X | X | X |
| 2 | 125-023 | Fan Shroud | X | X | X |
| 2 | 125-056 ② | Fan Shroud | X | X | X |
| 3 | S501-684-* ① | Right Side | X | X | X |
| 3 | S501-899-* ①③ | Right Side | X | X | X |
| 3 | S501-720 ② | Right Side | X | X | X |
| 4 | S501-711-* ① | Left Side | X | X | X |
| 4 | S501-900-* ①③ | Left Side | X | X | X |
| 4 | S501-721 ② | Left Side | X | X | X |
| 5 | S533-228 ① | Control Panel Cover (Outer) | X | X | X |
| 5 | S533-235 ② | Control Panel Cover (Outer) | X | X | X |
| 6 | S521X479 | Condenser Partition | X | X | X |
| 6 | S521X524 | Condenser Partition | X | X | X |
| 8 | 121X480 | Blower Partition | X | X | X |
| 9 | S507-311-* ① | Top | X | X | X |
| 9 | S507-360-* ①③ | Top | X | X | X |
| 9 | S507-317 ② | Top | X | X | X |
| 10 | S111X032 | Outlet Air Frame Assembly | X | X | X |
| 11 | S508-097 | Back | X | X | X |
| 11 | S508-334 ③ | Back | X | X | X |
| 11 | S508-220 ② | Back | X | X | X |
| 12 | 113X480 | Filter Bracket | 2 | 2 | 2 |
| 13 | S132-104 | Control Panel Cover (Inner) | X | X | |
| 13 | S132-172 | Control Panel Cover (Inner) | | | X |
| 14 | 118-056-* ① | Side Grille | 2 | 2 | 2 |
| 14 | 118-067 ② | Side Grille | 2 | 2 | 2 |
| 15 | 118-050-* ① | Condenser Grille | X | X | X |
| 15 | 118-076 ② | Condenser Grille | X | X | X |
| 16 | BFAD-2 | Fresh Air Damper Assembly | X | X | X |
| 17 | S553-537-* ① | Vent Option Door | X | X | X |
| 17 | S553-646-* ①③ | Vent Option Door | X | X | X |
| 17 | S553-539 ① | Vent Option Door with ERV | X | X | X |
| 17 | S553-547 ② | Vent Option Door | X | X | X |
| 18 | S514-240-* ① | Upper Front | X | X | X |
| 18 | S514-298-* ①③ | Upper Front | X | X | X |
| 18 | S514-236 ② | Upper Front | X | X | X |
| 19 | 105X850 | Side Support | X | X | X |
| 20 | S543-175-* ① | Right Side Cover Plate (Outer) | X | X | X |
| 20 | S543-185 ② | Right Side Cover Plate (Outer) | X | X | X |
| 21 | S123-126 | Drain Pan | X | X | X |
| 21 | S123-147 ③ | Drain Pan | X | X | X |
| 21 | S123-140 ② | Drain Pan | X | X | X |
| 22 | 147-044 | Evaporator Support | X | X | X |
| 23 | 137-694 | Bottom Evaporator Fill | X | X | X |
| 24 | Control Panel Assembly | See Control Panel Assy. Drawing & Parts List Assy. | X | X | X |
| 25 | 113-140 | Bottom Mounting Bracket | X | X | X |
| 26 | 135X127 | Heat Shield | X | X | X |
| 27 | S153-218 ① | Disconnect Access Door | X | X | X |
| 27 | S153-405 ② | Disconnect Access Door | X | X | X |
| 28 | 137-259 | Fill Plate | X | X | X |
| 29 | 113-141-* ① | Top Rain Flashing | X | X | X |
| 29 | 113-361 ② | Top Rain Flashing | X | X | X |
| 30 | S553-538-* ① | Filter Door | X | X | X |
| 30 | S553-647-* ①③ | Filter Door | X | X | X |
| 30 | S553-551 ② | Filter Door | X | X | X |
| 31 | S536-176 | Cond. Partition Block Off Plate | X | X | X |
| 31 | S536-775 ③ | Cond. Partition Block Off Plate | X | X | X |
| 32 | 105-1302 | Grommet Retainer | X | X | X |

① Exterior cabinet parts are manufactured with various paint color options. To ensure the proper paint color is received, reference the following codes: Beige -X, White -1, Buckeye Gray -4, Desert Brown -5, Dark Bronze -8

② Note: Exterior cabinet parts are manufactured from stainless steel Code "S"

③ Nonfiberglass insulation option

FUNCTIONAL COMPONENTS

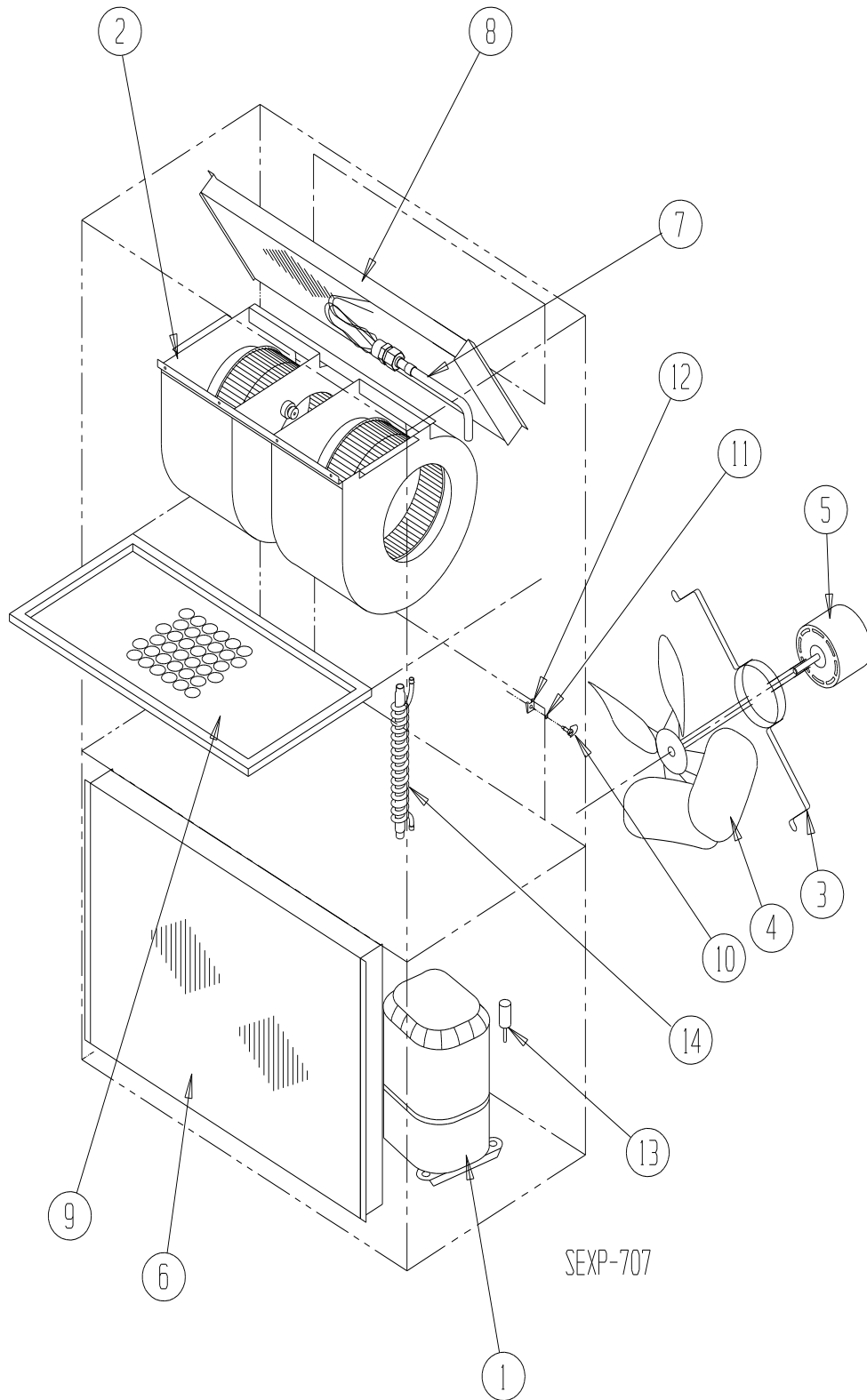

FUNCTIONAL COMPONENTS

| Dwg No. | Part Number | Description | W17A2-A | W18A2-A | W24A2-A | W24A2-B | W24A2-C | W24A2-D | W24A2-F |
|---------|-------------|---|---------|---------|---------|---------|---------|---------|---------|
| 1 | 8000-313 | Compressor | X | X | | | | | |
| 1 | 8000-314 | Compressor | | | X | | | | |
| 1 | 8000-315 | Compressor | | | | X | | | |
| 1 | 8000-316 | Compressor | | | | | X | | X |
| 1 | 8000-317 | Compressor | | | | | | X | |
| 2 | S900-326 | Blower Assembly | | | X | X | | X | X |
| 2 | S900-327 | Blower Assembly | | | | | X | | |
| 2 | S900-291 | Blower Assembly | X | X | | | | | |
| 3 | 8200-001 | Fan Motor Mount | X | X | X | X | X | X | X |
| 4 | 5151-033 | Fan Blade | X | X | X | X | | X | X |
| 4 | 5151-046 | Fan Blade | | | | | X | | |
| 5 | 8103-016 | Condenser Motor | X | X | X | X | | X | X |
| 5 | 8103-020 | Condenser Motor | | | | | X | | |
| 6 | 5051-184BX | Condenser Coil | X | X | | | | | |
| 6 | 5051-185BX | Condenser Coil | | | X | X | X | X | X |
| 7 | 800-0427 | Distributor Assembly | | X | | | | | |
| 7 | 800-0428 | Distributor Assembly | | | X | X | X | X | X |
| 7 | 800-0437 | Distributor Assembly | X | | | | | | |
| 8 | 917-0218BX | Evaporator Coil with Distributor Assembly | X | | | | | | |
| 8 | 917-0219BX | Evaporator Coil with Distributor Assembly | | X | | | | | |
| 8 | 917-0220BX | Evaporator Coil with Distributor Assembly | | | X | X | X | X | X |
| 9 | 7004-011 | Air Filter 1" Throw-Away | X | X | X | X | X | X | X |
| 9 | 7003-032 | Air Filter 1" Washable ① | X | X | X | X | X | X | X |
| 9 | 7004-025 | Air Filter 2" Pleated ① | X | X | X | X | X | X | X |
| 10 | 1171-022 | 1/4" Turn Fastener | X | X | X | X | X | X | X |
| 11 | 1171-024 | 1/4" Turn Retainer | X | X | X | X | X | X | X |
| 12 | 1171-023 | 1/4" Receptacle | X | X | X | X | X | X | X |
| 13 | 1804-0385 | High Pressure Switch (Flare) | X | X | X | X | X | X | X |
| 13 | 1804-0386 | Low Pressure Switch (Flare) | X | X | X | X | X | X | X |
| 14 | 5204-001 | Subcooling Heat Exchanger | X | | | | | | |
| NS | CMA-28 | Low Ambient Control (Flare) ① | | | X | X | X | X | X |
| NS | 5201-021 | Filter Drier | X | X | X | X | X | X | X |
| NS | 6031-009 | Coremax Valve Core | X | X | X | X | X | X | X |

NS – Not Shown

① – Optional on these models

CONTROL PANEL

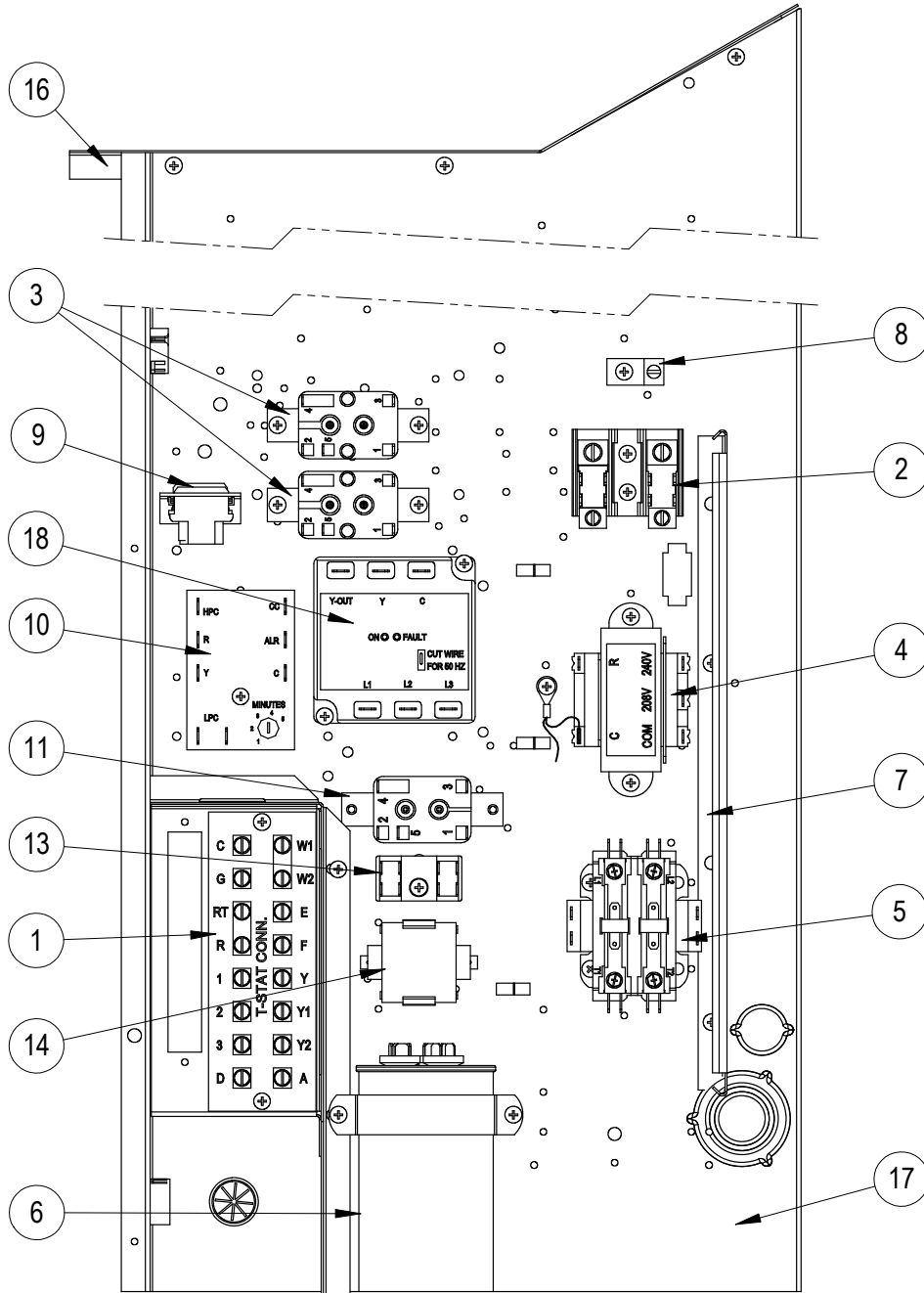

SEXP-685 A

CONTROL PANEL

| Dwg No. | Part Number | Description | W17/18A2-A | W24A2-A | W24A2-B | W24A2-C | W24A2-D | W24A2-F |
|---------|-------------|-------------------------------------|------------|---------|---------|---------|---------|---------|
| 1 | 8607-034 | Low Voltage Terminal Strip | X | X | X | X | X | X |
| 2 | 8607-013 | Terminal Block 2 Pole | X | X | | | X | 2 |
| 2 | 8607-014 | Terminal Block 3 Pole | | | X | X | | |
| 3 | 8201-009 | Blower Control Relay | 2 | X | X | | X | X |
| 3 | 8201-032 | Blower Control Relay | | | | X | | |
| 4 | 8407-068 | Transformer | X | X | X | | X | X |
| 4 | 8407-069 | Transformer | | | | X | | |
| 5 | 8401-006 | Compressor Contactor | X | X | | | X | |
| 5 | 8401-002 | Compressor Contactor | | | X | X | | X |
| 6 | 8552-046 | Compressor Capacitor | X | | | | | |
| 6 | 8552-051 | Compressor Capacitor | | X | | | X | |
| 6 | 8552-002 | Outdoor Motor Capacitor | | | X | X | | X |
| 7 | 135-122 | Wire Shield | X | X | X | X | X | X |
| 8 | 8611-006 | Ground Terminal | X | X | X | X | X | X |
| 9 | 3000-968 | 6 Pin Connector | X | X | X | X | X | X |
| 10 | 8201-164 | Compressor Control Module (Opt.) | X | X | X | X | X | X |
| 11 | 8201-062 | Alarm Relay (Optional) | X | X | X | X | X | X |
| 13 | 8607-017 | Terminal Block (Optional) | X | X | X | X | X | X |
| 14 | 8551-004 | Start Device (PTCR) (Optional) | X | X | | | X | |
| 16 | 117X137 | Control Panel Top | X | X | X | X | X | X |
| 17 | 117X123 | Control Panel | X | X | X | X | X | X |
| 18 | 8201-126 | Phase Monitor | | | X | X | | X |
| NS | 8615-035 | Circuit Breaker 20A 2 Pole (Opt.) ① | X | | | | | X |
| NS | 8615-036 | Circuit Breaker 25A 2 Pole (Opt.) ① | | X | | | | |
| NS | 8615-067 | Toggle Disconnect (Optional) ① | | | | X | | X |
| NS | 8615-056 | Circuit Breaker 15A 3 Pole (Opt.) ① | | | X | | | |
| NS | 4095-170 | Wiring Diagram | X | | | | | |
| NS | 4095-169 | Wiring Diagram | | X | | | X | |
| NS | 4095-260 | Wiring Diagram | | | X | | | |
| NS | 4095-360 | Wiring Diagram | | | | X | | |
| NS | 4095-636 | Wiring Diagram | | | | | | X |

NS = Not Shown

① Circuit breakers listed are for units without electric heat, "OZ" models. Hot gas bypass models not available without electric heat. See Heater Replacement Parts Manual for units with electric heat.

