REPLACEMENT PARTS MANUAL

WALL-MOUNTED PACKAGE AIR CONDITIONER

Models:

W18A2-A10HPD107

W24A2-A10HPD107

W30A2-A15HPD107

General Notes

- Revised and/or additional pages may be issued from time to time.
- A complete and current manual consists of pages shown in the following contents section.

Important

- Contact the installing and/or local Bard distributor for all parts requirements. Make sure to have the complete model and serial number available from the unit rating plates.

Contents

Description	Page
Cabinet Components	
♦ Exploded View	2
♦ Usage List	3
Functional Components	
♦ Exploded View	4
♦ Usage List	5
Control Panel	
♦ Layout View	6
♦ Usage List	7
Blower Assembly	
♦ Exploded View	8
♦ Usage List	8
Ventilation Package	
♦ Layout View	9
♦ Usage List	9



Climate Control Solutions

Bard Manufacturing Company, Inc.
Bryan, Ohio 43506
www.bardhvac.com

Manual: 2110-1542
Supersedes: **NEW**
Date: 3-6-18

CABINET COMPONENTS

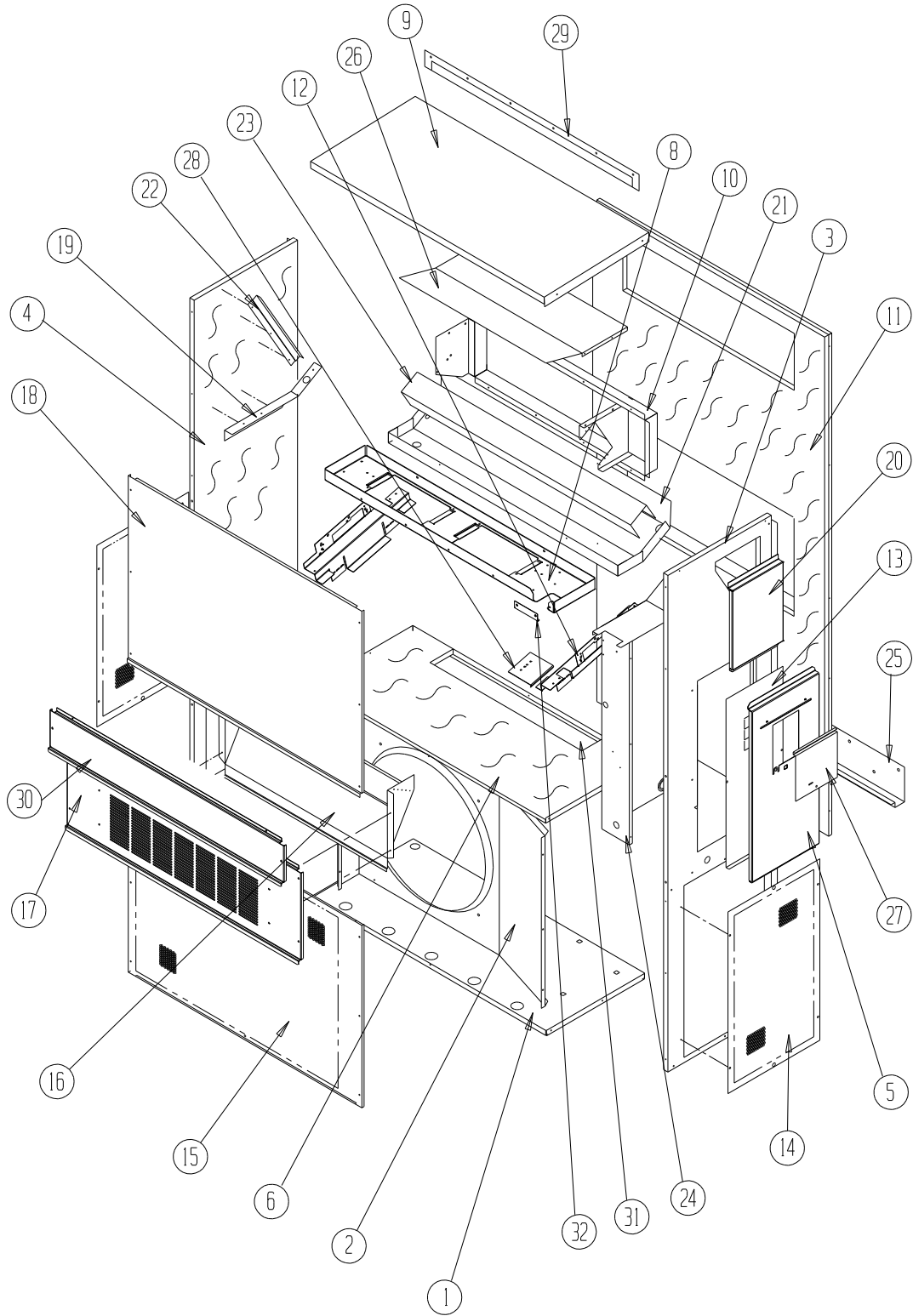

SEXP-684

CABINET COMPONENTS

Dwg No.	Part Number	Description	W18A2-A10HPDI07	W24A2-A10HPDI07	W30A2-A15HPDI07
1	127-467	Lower Base	X	X	
1	127-473	Lower Base			X
2	125-023	Fan Shroud	X	X	
2	125-057	Fan Shroud			X
3	S501-684-X	Right Side	X	X	X
4	S501-711-X	Left Side	X	X	X
5	S533-228-X	Control Panel Cover (Outer)	X	X	X
6	S521X479	Condenser Partition	X	X	
6	S521X466	Condenser Partition			X
8	121X480	Blower Partition	X	X	
8	121X467	Blower Partition			X
9	S507-311-X	Top	X	X	
9	S507-308-X	Top			X
10	S111X032	Outlet Air Frame Assembly	X	X	
10	S111X030	Outlet Air Frame Assembly			X
11	S508-097	Back	X	X	
11	S508-222	Back			X
12	113X480	Filter Bracket	2	2	2
13	S132-104	Control Panel Cover (Inner)	X	X	X
14	118-056-X	Side Grille	2	2	2
15	118-050-X	Condenser Grille	X	X	
15	118-059-X	Condenser Grille			X
16	Vent Package	See Ventilation Package Drawing & Parts List	X	X	X
17	S553-576-X	Vent Option Door	X	X	
17	S553-577-X	Vent Option Door			X
18	S514-240-X	Upper Front	X	X	
18	S514-241-X	Upper Front			X
19	105X850	Side Support	X	X	X
20	S543-175-X	Right Side Cover Plate (Outer)	X	X	X
21	S123-126	Drain Pan	X	X	
21	S123-127	Drain Pan			X
22	147-044	Evaporator Support	X	X	X
23	137-694	Bottom Evaporator Fill	X	X	
23	137-685	Bottom Evaporator Fill			X
24	Control Panel Assembly	See Control Panel Assy. Drawing & Parts List Assy.	X	X	X
25	113-140	Bottom Mounting Bracket	X	X	X
26	135X127	Heat Shield	X	X	
26	135X123	Heat Shield			X
27	S153-218-X	Disconnect Access Door	X	X	X
28	137-259	Fill Plate	X	X	X
29	113-141-X	Top Rain Flashing	X	X	
29	113-149-X	Top Rain Flashing			X
30	S553-538-X	Filter Door	X	X	
30	S553-524-X	Filter Door			X
31	S536-176	Cond. Partition Block Off Plate	X	X	
31	S536-498	Cond. Partition Block Off Plate			X
32	105-1302	Grommet Retainer	X	X	X

FUNCTIONAL COMPONENTS

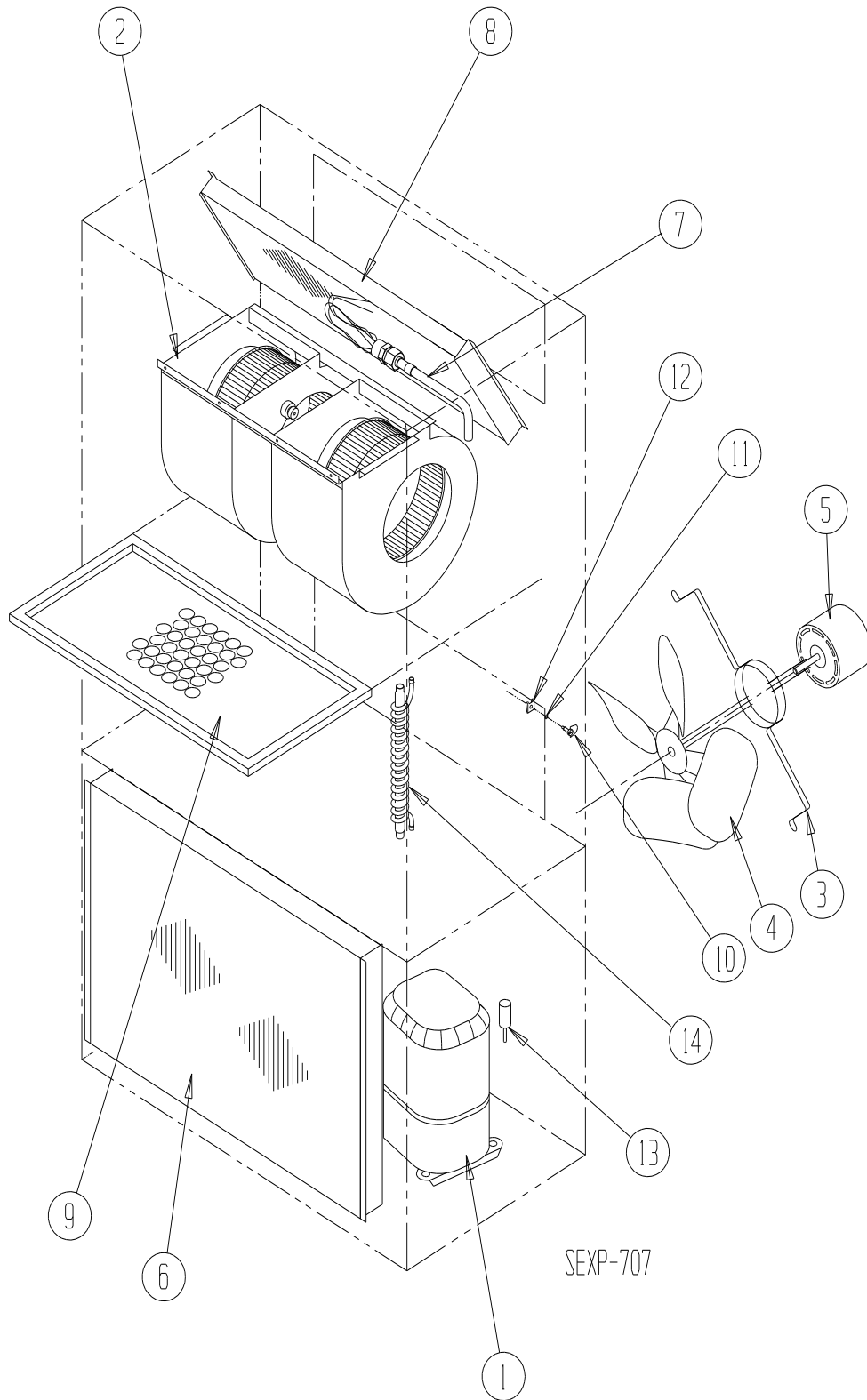

FUNCTIONAL COMPONENTS

Dwg No.	Part Number	Description	W18A2-A10HPD107	W24A2-A10HPD107	W30A2-A15HPD107
1	8000-313	Compressor	X		
1	8000-314	Compressor		X	
1	8000-298	Compressor			X
2	S900-326	Blower Assembly		X	
2	S900-291	Blower Assembly	X		
2	S900-231	Blower Assembly			X
3	8200-001	Fan Motor Mount	X	X	X
4	5151-033	Fan Blade	X	X	
4	5151-045	Fan Blade			X
5	8103-016	Condenser Motor	X	X	
5	8103-013	Condenser Motor			X
6	5051-184BX	Condenser Coil	X		
6	5051-185BX	Condenser Coil		X	
6	5051-181BX	Condenser Coil			X
7	800-0427	Distributor Assembly	X		
7	800-0428	Distributor Assembly		X	
7	800-0429	Distributor Assembly			X
8	917-0219BX	Evaporator Coil with Distributor Assembly	X		
8	917-0220BX	Evaporator Coil with Distributor Assembly		X	
8	917-0224BX	Evaporator Coil with Distributor Assembly			X
9	7004-025	Air Filter 2" Pleated (16" x 25" x 2")	X	X	
9	7004-026	Air Filter 2" Pleated (16" x 30" x 2")			X
10	1171-022	1/4" Turn Fastener	X	X	X
11	1171-024	1/4" Turn Retainer	X	X	X
12	1171-023	1/4" Receptacle	X	X	X
13	1804-0385	High Pressure Switch (Flare)	X	X	X
13	1804-0386	Low Pressure Switch (Flare)	X	X	X
NS	CMA-28	Low Ambient Control (Flare)		X	X
NS	5201-021	Filter Drier	X	X	X
NS	6031-009	Coremax Valve Core	X	X	X

NS – Not Shown

CONTROL PANEL

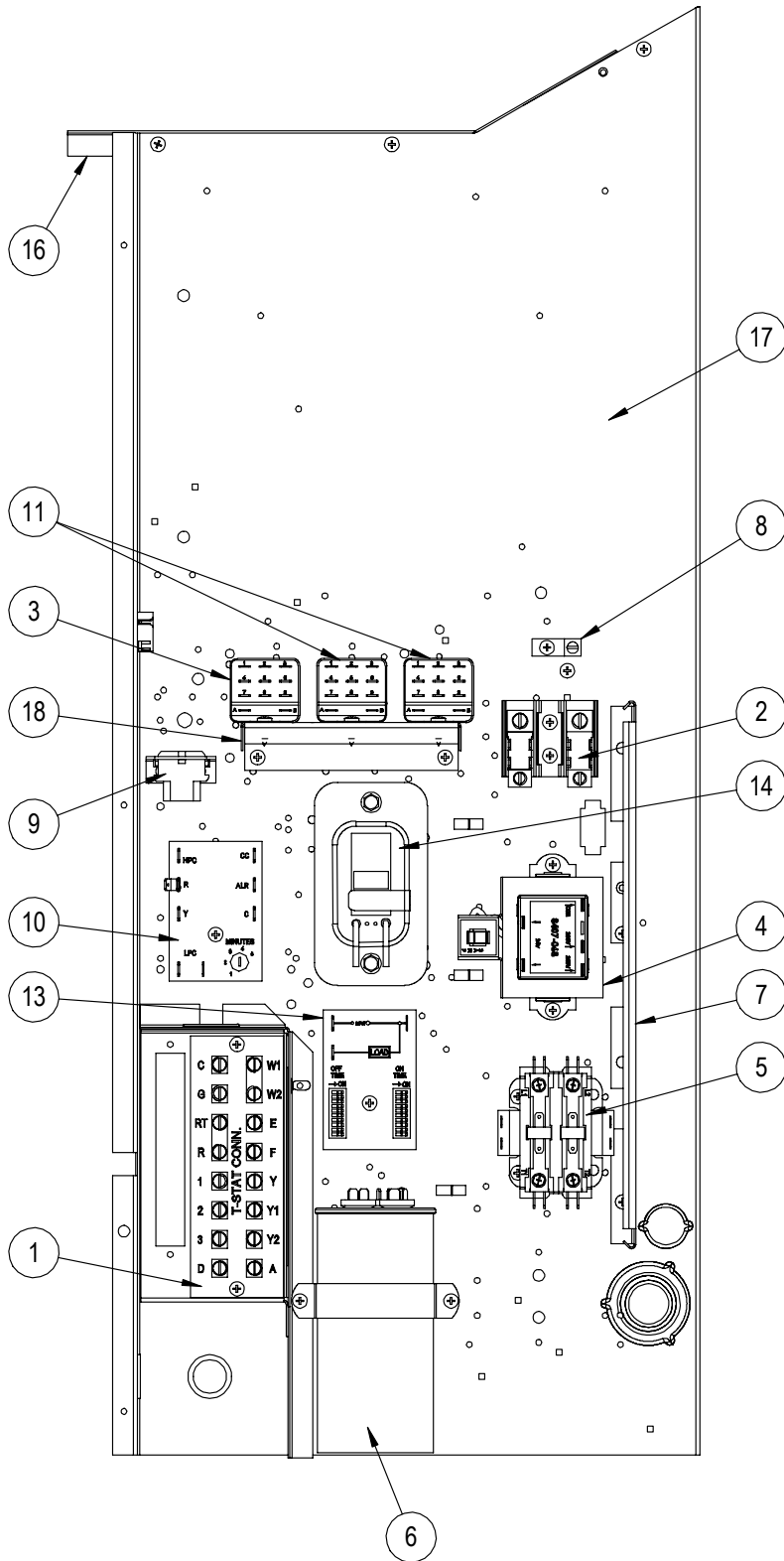

SEXP-895

CONTROL PANEL

Dwg No.	Part Number	Description	W18A2-A10HPD107	W24A2-A10HPD107	W30A2-A15HPD107
1	8607-034	Low Voltage Terminal Strip	X	X	X
2	8607-013	Terminal Block 2 Pole	X	X	X
3	8201-071	Blower Control Relay	X	X	X
4	8407-068	Transformer	X	X	X
5	8401-006	Compressor Contactor	X	X	X
6	8552-047	Compressor Capacitor 30+5/370V	X		
6	8552-051	Compressor Capacitor 40+5/370V		X	
6	8552-052	Compressor Capacitor 45+5/370V			X
7	135-122	Wire Shield	X	X	X
8	8611-006	Ground Terminal	X	X	X
9	3000-968	6 Pin Connector	X	X	X
10	8201-157	Compressor Control Module	X	X	X
11	8201-048	Blower Relay	2	2	2
13	8201-135	Relay Cycle Timer*	X	X	X
14	8612-031	Motor Speed Control	X	X	
14	8612-032	Motor Speed Control			X
16	117X137	Control Panel Top	X	X	X
17	117X123	Control Panel	X	X	X
18	141-392	Relay Plate	X	X	X
NS	4095-171	Wiring Diagram	X	X	
NS	4095-172	Wiring Diagram			X

* Off time must be set to 32 min. and On time must be set to 4 min. to meet damper ventilation requirements per FEMA standards.

NS = Not Shown

BLOWER ASSEMBLY

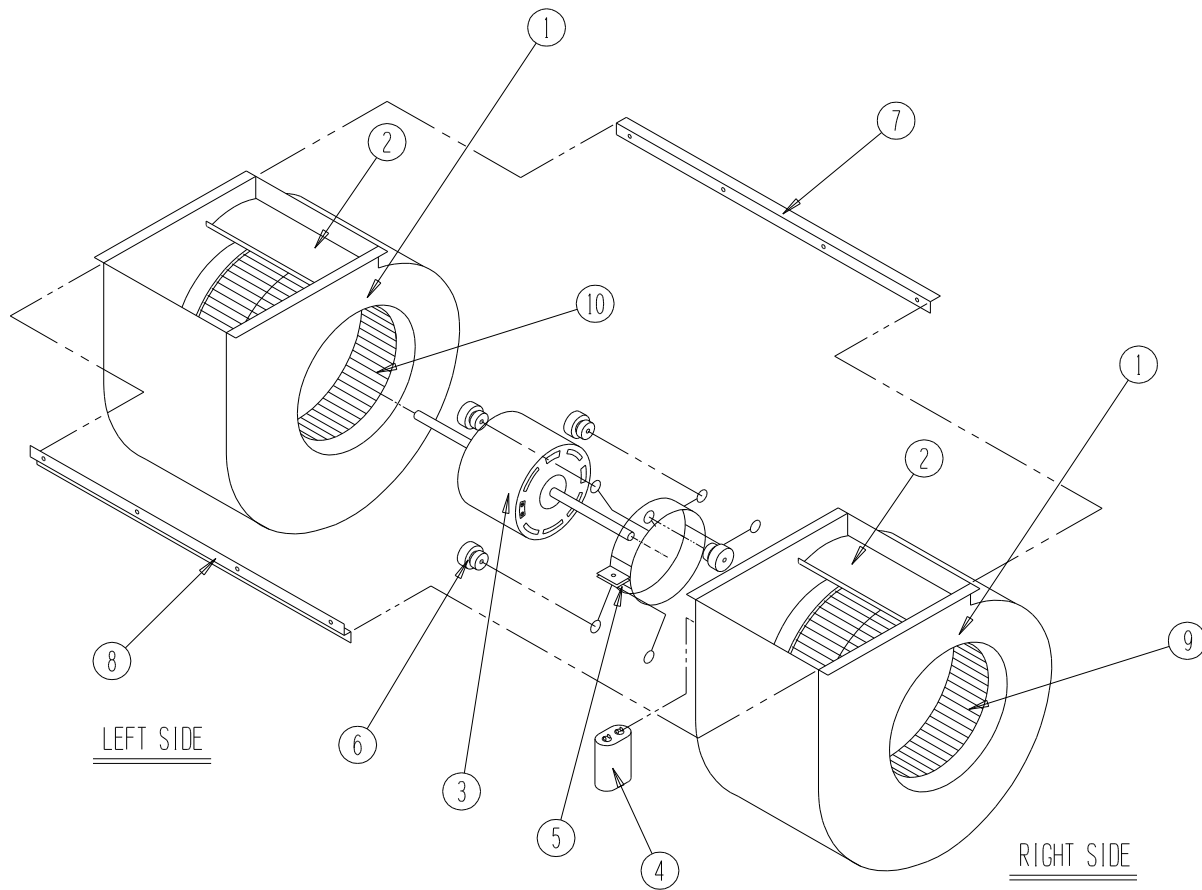

SEXP-346

Dwg No.	Part Number	Description	S900-326	S900-291	S900-231
1	151-115	Housing	2	2	
1	151-111	Housing			2
2	144-183	Diffuser	2	2	
2	144-174	Diffuser			2
3	8102-016	Blower Motor (230/208)	X		
3	8102-014	Blower Motor (230/208)		X	
3	8105-029	Blower Motor (230/208)			X
4	8552-002	Capacitor		X	X
4	8552-004	Capacitor	X		
5	8200-031	Motor Mount	X	X	X
6	5451-011	Grommets	6	6	6
7	105-1061	Back Brace	X	X	
7	105-870	Back Brace			X
8	103-435	Front Brace	X	X	
8	103-401	Front Brace			X
9	5152-092	Wheel 9-6 CW	X	X	
9	5152-090	Wheel 9-7 CW			X
10	5152-093	Wheel 9-6 CCW	X	X	
10	5152-091	Wheel 9-7 CCW			X

VENTILATION PACKAGE

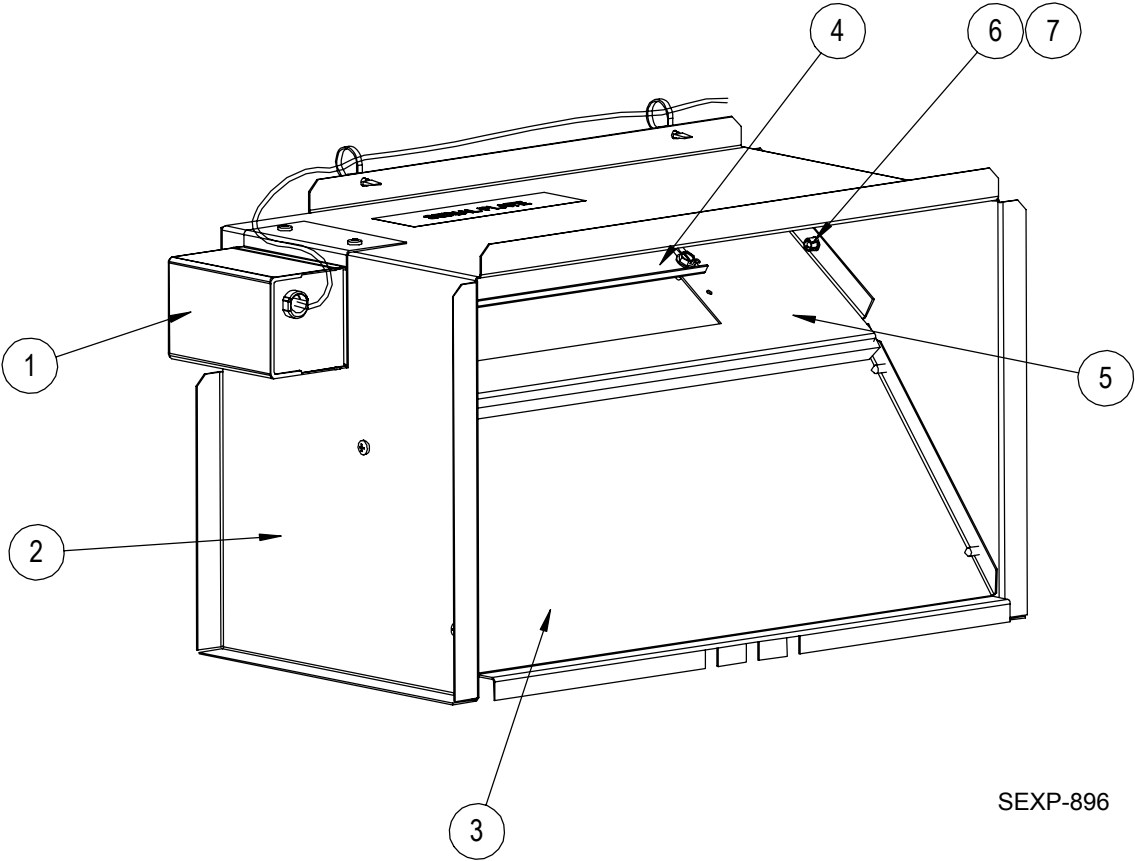

SEXP-896

Dwg No.	Part Number	Description	920-0139 (W18/W24)	920-0403 (W30)
1	8110-001	Actuator Motor	X	X
2	139-279	Vent Wrapper	X	X
3	139-280	Vent Partition	X	X
4	139-282	Damper Shutter*	X	X
5	139-281	Damper Blade	X	X
6	8611-057	Bushing 3/16"	X	X
7	8311-059	Canoe Clip	X	X

* If damper shutter is replaced, it must be re-installed in the correct position in order to meet damper ventilation requirements per FEMA standards.