

---

# Replacement Parts Manual

# Wall Mounted Package Air Conditioner

**Models: WL421, WL482,  
WL602**

---

## General Notes

- Revised and/or additional pages may be issued from time to time.
- A complete and current manual consists of pages shown in the following contents section.

## Important

- Contact the installing and/or local Bard distributor for all parts requirements. Make sure you have the complete model and serial number available from the unit rating plates.

## Contents

| Description           | Page |
|-----------------------|------|
| Cabinet Components    |      |
| ♦ Exploded View ..... | 1    |
| ♦ Usage List .....    | 2    |
| Functional Components |      |
| ♦ Exploded View ..... | 3    |
| ♦ Usage List .....    | 4    |
| Control Panel         |      |
| ♦ Exploded View ..... | 5    |
| ♦ Usage List .....    | 6    |
| Blower Assembly       |      |
| ♦ Exploded View ..... | 7    |
| ♦ Usage List .....    | 7    |



**BARD MANUFACTURING COMPANY**  
Bryan, Ohio 43506

*Since 1914...Moving ahead, just as planned.*

Manual: 2110-419  
File: 2150-004, Tab 16  
Date: 05/25/96

# Cabinet Components

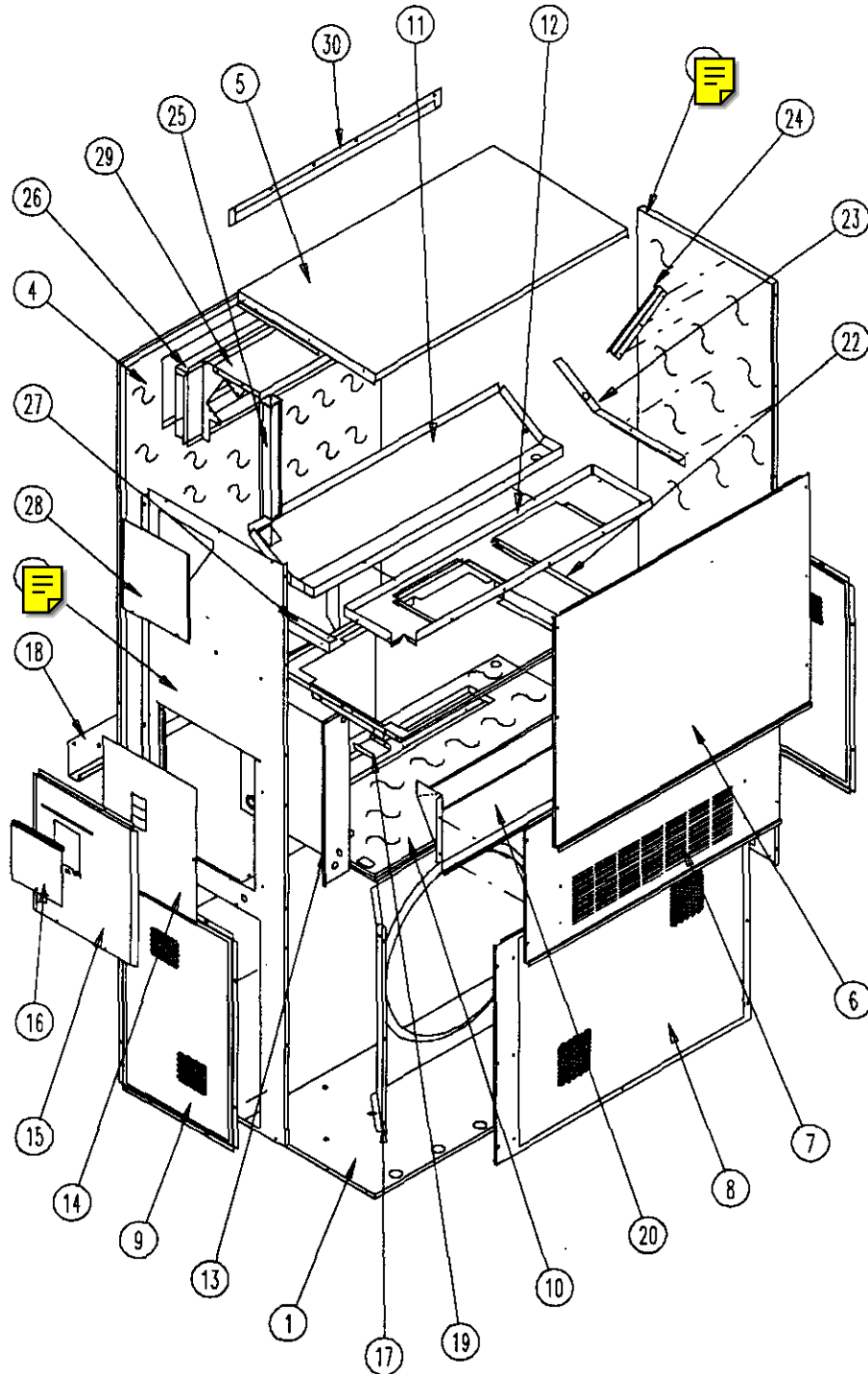

SDP-234

# Cabinet Components

| Drawing No. | Part No.               | Description                                     | WL421-A, B | WL421-C | WL482-A, B | WL482-C | WL602-A, B | WL602-C, F |
|-------------|------------------------|---|------------|---------|------------|---------|------------|------------|
| 1           | S127Y214               | Lower Base                                      | •          | •       | •          | •       | •          | •          |
| 2           | S500-320-* ①           | Left Side                                       | •          | •       | •          | •       | •          | •          |
| 3           | S500-319-* ①           | Right Side                                      | •          | •       | •          | •       | •          | •          |
| 4           | S508-098               | Back  | •          | •       | •          | •       | •          | •          |
| 5           | S506-142-* ①           | Top   | •          | •       | •          | •       | •          | •          |
| 6           | S514-077-* ①           | Upper Front                                     | •          | •       | •          | •       | •          | •          |
| 7           | S552-224-* ①           | Service Door                                    | •          | •       | •          | •       | •          | •          |
| 8           | 118-031-* ①            | Condenser Grille                                | •          | •       | •          | •       | •          | •          |
| 9           | 118-032-* ①            | Side Grille                                     | 2          | 2       | 2          | 2       | 2          | 2          |
| 10          | S520Y258               | Condenser Partition                             | •          | •       | •          | •       | •          | •          |
| 11          | 123-091                | Drain Pan                                       | •          | •       | •          | •       | •          | •          |
| 12          | 121Y216                | Blower Partition                                | •          | •       | •          | •       | •          | •          |
| 13          | Control Panel Assembly | See Control Panel Assembly Drawing & Parts List | •          | •       | •          | •       | •          | •          |
| 14          | S133-114               | Control Panel Cover (Inner)                     | •          |         | •          |         | •          |            |
| 14          | S133-115               | Control Panel Cover (Inner)                     |            | •       |            | •       |            | •          |
| 15          | S533-140-* ①           | Control Panel Cover (Outer)                     | •          | •       | •          | •       | •          | •          |
| 16          | S153-218-* ①           | Disconnect Access Door                          | •          | •       | •          | •       | •          | •          |
| 17          | 125-024                | Fan Shroud                                      | •          | •       | •          | •       | •          | •          |
| 18          | 113-140                | Bottom Mounting Bracket                         | •          | •       | •          | •       | •          | •          |
| 19          | 137-209                | Fill  | •          | •       | •          | •       | •          | •          |
| 20          | 960024                 | Fresh Air Damper Assembly                       | •          | •       | •          | •       | •          | •          |
| 22          | 131Y099                | Filter Tray                                     | •          | •       | •          | •       | •          | •          |
| 23          | 105Y878                | Left Side Support                               | •          | •       | •          | •       | •          | •          |
| 24          | 147-046-* ①            | Left Evaporator Support                         | •          | •       | •          | •       | •          | •          |
| 25          | 135-128                | Raceway   | 2          | 2       | 2          | 2       | 2          | 2          |
| 26          | 111Y034                | Outlet Airframe Assembly                        | •          | •       | •          | •       | •          | •          |
| 27          | 105Y877                | Right Side Support                              | •          | •       | •          | •       | •          | •          |
| 28          | S143-042-* ①           | Right Side Cover Plate (Outer)                  | •          | •       | •          | •       | •          | •          |
| 29          | 135-129                | Heat Shield                                     | •          | •       | •          | •       | •          | •          |
| 30          | 113-150-* ①            | Top Rain Flashing                               | •          | •       | •          | •       | •          | •          |

① NOTE: Exterior cabinet parts are manufactured with various paint color options. To insure that you receive the proper paint color, you must include the complete model and serial number of the unit for which cabinet parts are being ordered.

# Functional Components

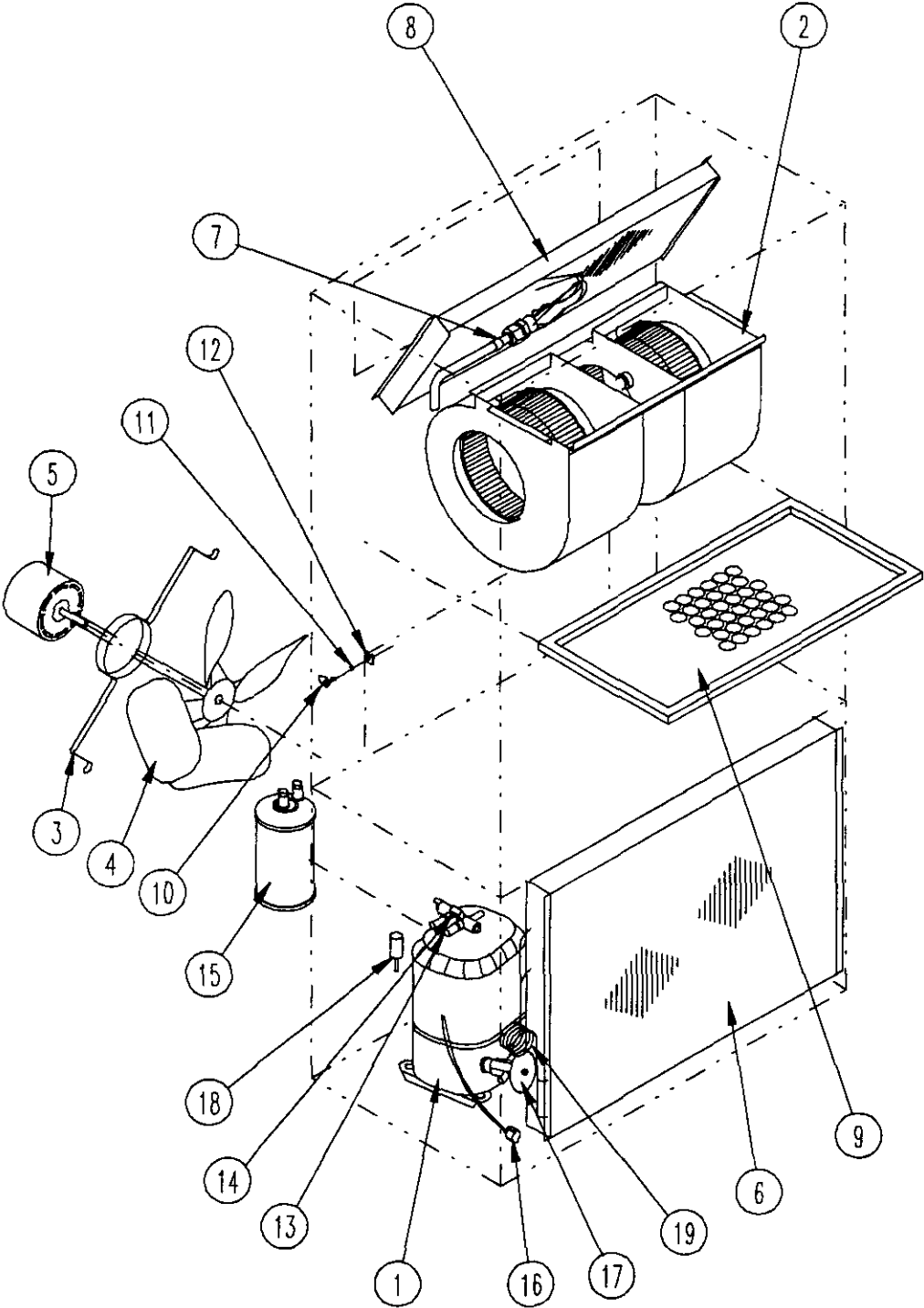

SEP-237

# Functional Components

| Dwg. No. | Part No.  | Description                    | WL421-A | WL421-B | WL421-C | WL482-A | WL482-B | WL482-C | WL602-A | WL602-B | WL602-C | WL602F |
|----------|-----------|--------------------------------|---------|---------|---------|---------|---------|---------|---------|---------|---------|--------|
| 1        | 8000-153  | Compressor                     |         |         |         |         |         |         | •       |         |         |        |
| 1        | 8000-154  | Compressor                     |         |         |         |         |         |         |         | •       |         |        |
| 1        | 8000-155  | Compressor                     |         |         |         |         |         |         |         |         | •       | •      |
| 1        | 8000-126  | Compressor                     | •       |         |         |         |         |         |         |         |         |        |
| 1        | 8000-127  | Compressor                     |         | •       |         |         |         |         |         |         |         |        |
| 1        | 8000-128  | Compressor                     |         |         | •       |         |         |         |         |         |         |        |
| 1        | 8000-149  | Compressor                     |         |         |         | •       |         |         |         |         |         |        |
| 1        | 8000-156  | Compressor                     |         |         |         |         | •       |         |         |         |         |        |
| 1        | 8000-157  | Compressor                     |         |         |         |         |         | •       |         |         |         |        |
| 2        | S900-183  | Blower Assembly                | •       | •       |         | •       | •       |         |         |         |         |        |
| 2        | S900-184  | Blower Assembly                |         |         | •       |         |         | •       |         |         |         |        |
| 2        | S900-185  | Blower Assembly                |         |         |         |         |         |         | •       | •       |         | •      |
| 2        | S900-186  | Blower Assembly                |         |         |         |         |         |         |         |         | •       |        |
| 3        | 8200-004  | Fan Motor Mount                | •       | •       | •       | •       | •       | •       | •       | •       | •       | •      |
| 4        | 5151-027  | Fan Blade                      | •       | •       | •       | •       | •       | •       | •       | •       | •       | •      |
| 5        | 8105-030  | Condenser Motor                |         |         | •       |         |         | •       |         |         | •       |        |
| 5        | 8105-039  | Condenser Motor                | •       | •       |         | •       | •       |         | •       | •       |         | •      |
| 6        | 5051-0    | Condenser Coil                 |         |         |         | •       | •       | •       | •       | •       | •       | •      |
| 6        | 5051-0    | Condenser Coil                 | •       | •       | •       |         |         |         |         |         |         |        |
| 7        | 800-020   | Cooling Capillary Assembly     |         |         |         | •       | •       | •       |         |         |         |        |
| 7        | 800-0203  | Cooling Capillary Assembly     | •       | •       | •       |         |         |         |         |         |         |        |
| 7        | 800-0232  | Cooling Capillary Assembly     |         |         |         |         |         |         | •       | •       | •       | •      |
| 8        | 5060-070  | Evaporator Coil                | •       | •       | •       | •       | •       | •       |         |         |         |        |
| 8        | 5060-082  | Evaporator Coil                |         |         |         |         |         |         | •       | •       | •       | •      |
| 9        | 7004-016  | Air Filter 1" Throw-Away       | •       | •       | •       | •       | •       | •       | •       | •       | •       | •      |
| 9        | 7003-030  | Air Filter 1" Washable         | •       | •       | •       | •       | •       | •       | •       | •       | •       | •      |
| 9        | 7004-027  | Air Filter 2" Pleated          | •       | •       | •       | •       | •       | •       | •       | •       | •       | •      |
| 10       | 1171-022  | 1/4" Tum Fastener              | •       | •       | •       | •       | •       | •       | •       | •       | •       | •      |
| 11       | 1171-024  | 1/4" Tum Retainer              | •       | •       | •       | •       | •       | •       | •       | •       | •       | •      |
| 12       | 1171-023  | 1/4" Receptacle                | •       | •       | •       | •       | •       | •       | •       | •       | •       | •      |
| 13       | 8406-055  | High Pressure Switch (Solder)  | ①       | ①       | ①       | •       | •       | •       | •       | •       | •       | •      |
| NS       | 8406-061  | Low Pressure Switch (Solder) ① | •       | •       | •       | •       | •       | •       | •       | •       | •       | •      |
| NS       | 8406-062  | Low Ambient Control (Solder) ① | •       | •       | •       | •       | •       | •       | •       | •       | •       | •      |
| NS       | 1804-0106 | High Pressure Switch (Flare) ① | •       | •       | •       | •       | •       | •       | •       | •       | •       | •      |
| NS       | 1804-0107 | Low Pressure Switch (Flare) ①  | •       | •       | •       | •       | •       | •       | •       | •       | •       | •      |
| NS       | 1804-0108 | Low Ambient Control (Flare) ①  | •       | •       | •       | •       | •       | •       | •       | •       | •       | •      |

NS – Not Shown

① – Optional on these models

# Control Panel

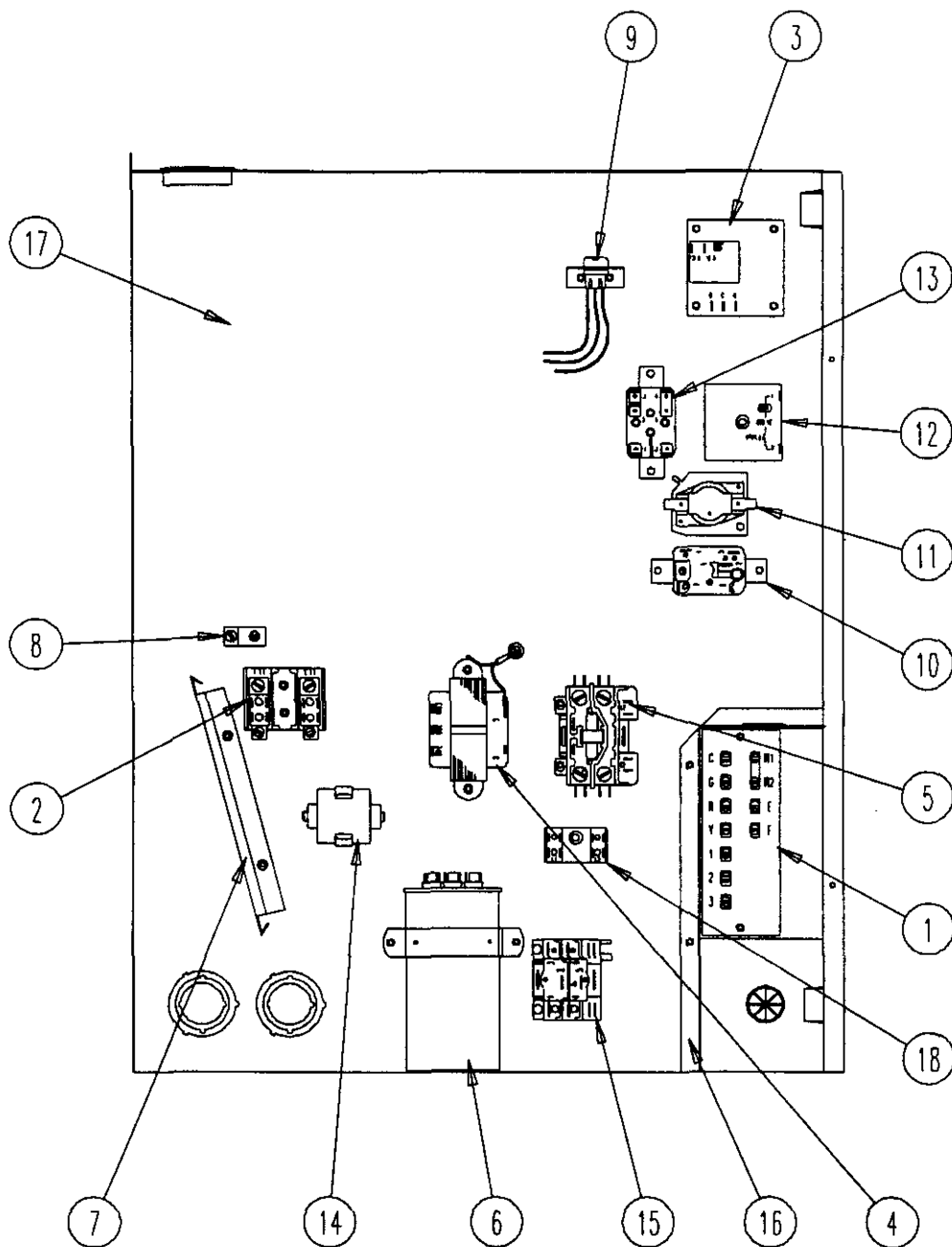

SEXP-238

# Control Panel

| Drawing No. | Part No. | Description                          | WL421-A | WL421-B | WL421-C | WL482-A | WL482-B | WL482-C | WL602-A | WL602-B | WL602-C | WL602-F |
|-------------|----------|--------------------------------------|---------|---------|---------|---------|---------|---------|---------|---------|---------|---------|
| 1           | 8607-020 | Low Voltage Terminal Strip           | •       | •       | •       | •       | •       | •       | •       | •       | •       | •       |
| 2           | 8607-013 | Terminal Block 2 Pole                | •       |         |         | •       |         |         | •       |         |         | 2       |
| 2           | 8607-014 | Terminal Block 3 Pole                |         | •       | •       |         | •       | •       |         | •       | •       |         |
| 2           | 8607-015 | Phelon Insulator                     |         |         | •       |         |         | •       |         |         | •       |         |
| 3           | 8201-056 | Blower Control                       | •       | •       |         | •       | •       |         | •       | •       |         | •       |
| 3           | 8201-032 | Blower Relay                         |         |         | •       |         |         | •       |         |         | •       |         |
| 4           | 8407-034 | Transformer                          | •       | •       |         | •       | •       |         | •       | •       |         | •       |
| 4           | 8407-042 | Transformer                          |         |         | •       |         |         | •       |         |         | •       |         |
| 5           | 8401-002 | Compressor Contactor                 |         | •       | •       |         | •       | •       |         | •       | •       | •       |
| 5           | 8401-007 | Compressor Contactor                 | •       |         |         |         |         |         |         |         |         |         |
| 5           | 8401-016 | Compressor Contactor                 |         |         |         | •       |         |         | •       |         |         |         |
| 6           | 8552-005 | Outdoor Motor Capacitor              |         | •       |         |         | •       |         |         | •       |         | •       |
| 6           | 8552-026 | Outdoor Motor Capacitor              |         |         | •       |         |         | •       |         |         | •       |         |
| 6           | 8552-055 | Compressor Capacitor                 | •       |         |         |         |         |         |         |         |         |         |
| 6           | 8552-058 | Compressor Capacitor                 |         |         |         |         |         |         | •       |         |         |         |
| 6           | 8552-059 | Compressor Capacitor                 |         |         |         | •       |         |         |         |         |         |         |
| 7           | 135-130  | Wire Shield                          | •       | •       | •       | •       | •       | •       | •       | •       | •       | •       |
| 8           | 8611-006 | Ground Terminal                      | •       | •       | •       | •       | •       | •       | •       | •       | •       | •       |
| 9           | 3000-978 | 6 Pin Connector                      | •       | •       | •       | •       | •       | •       | •       | •       | •       | •       |
| 10          | 8201-034 | Lockout Relay                        | ①       | ①       | ①       | •       | •       | •       | •       | •       | •       | •       |
| 11          | 8201-065 | Low Pressure Bypass (TDR) (Optional) | •       | •       | •       | •       | •       | •       | •       | •       | •       | •       |
| 12          | 8201-050 | Compressor TDR (Optional)            | •       | •       | •       | •       | •       | •       | •       | •       | •       | •       |
| 12          | 8201-067 | Compressor TDR Adj (Optional)        | •       | •       | •       | •       | •       | •       | •       | •       | •       | •       |
| 13          | 8201-062 | Alarm Relay (Optional)               | •       | •       | •       | •       | •       | •       | •       | •       | •       | •       |
| 14          | 8551-005 | Start Device (PTRC) (Optional)       | •       |         |         |         |         |         |         |         |         |         |
| 15          | 8201-032 | Outdoor Fan Relay (Optional)         |         |         | •       |         |         | •       |         |         | •       |         |
| 16          | 117-139  | Low Voltage Box                      | •       | •       | •       | •       | •       | •       | •       | •       | •       | •       |
| 17          | 117-143  | Control Panel                        | •       | •       | •       | •       | •       | •       | •       | •       | •       | •       |
| 18          | 8607-017 | Terminal Block (Optional)            | •       | •       |         | •       | •       |         | •       | •       |         | •       |
|             | 4095-110 | Wiring Diagram                       | •       |         |         |         |         |         |         |         |         |         |
|             | 4095-112 | Wiring Diagram                       |         |         |         | •       |         |         | •       |         |         |         |
|             | 4095-210 | Wiring Diagram                       |         | •       |         |         |         |         |         |         |         |         |
|             | 4095-212 | Wiring Diagram                       |         |         |         |         | •       |         |         | •       |         |         |
|             | 4095-310 | Wiring Diagram                       |         |         | •       |         |         |         |         |         |         |         |
|             | 4095-313 | Wiring Diagram                       |         |         |         |         |         | •       |         |         | •       |         |
|             | 4095-611 | Wiring Diagram                       |         |         |         |         |         |         |         |         |         | •       |

# Blower Assembly

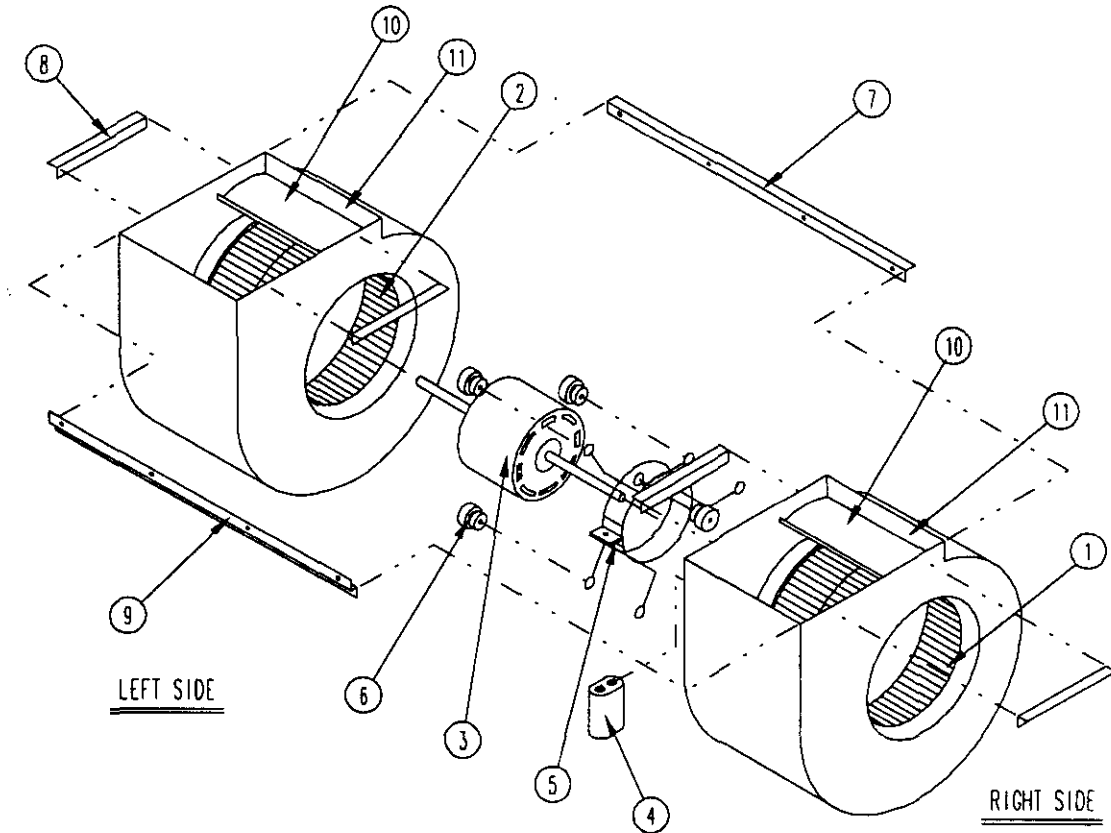

| Drawing No. | Part No.                 | Description            | 900-183 | 900-184 | 900-185 | 900-186 |
|-------------|--------------------------|------------------------|---------|---------|---------|---------|
|             |                          |                        |         |         |         |         |
| 1           | 5152-011                 | 10 inch Wheel (CW)     |         |         | •       | •       |
| 1           | 5152-057                 | 9 inch Wheel (CW)      | •       | •       |         |         |
| 2           | 5152-012                 | 10 inch Wheel (CCW)    |         |         | •       | •       |
| 2           | 5152-058                 | 9 inch Wheel (CCW)     | •       | •       |         |         |
| 3           | 8105-030 <i>8105-030</i> | Blower Motor (230/208) | •       |         | •       |         |
| 3           | 8105-025 <i>8105-025</i> | Blower Motor (460)     |         | •       |         | •       |
| 4           | 8552-005                 | Capacitor              | •       | •       | •       | •       |
| 5           | 8200-040                 | Motor Mount            | •       | •       | •       | •       |
| 6           | 5451-011                 | Grommets               | 6       | 6       | 6       | 6       |
| 7           | 105-880                  | Back Brace             | •       | •       | •       | •       |
| 8           | 105-881                  | Side Angle             | 4       | 4       | 4       | 4       |
| 9           | 103-389                  | Front Brace            | •       | •       | •       | •       |
| 10          | 151-101                  | Housing                | 2       | 2       | 2       | 2       |
| 11          | 144-166                  | Diffuser               | 2       | 2       | 2       | 2       |