

REPLACEMENT PARTS MANUAL

WALL MOUNTED PACKAGE HEAT PUMP MODEL 36WH7 (SUFFIX D016 MODELS)

Manual 2110-509

Revision B

Date 06-07-91

Supersedes 2-20-91

* GENERAL NOTES *

*Revised and/or additional pages may be issued from time to time.
*A complete and current manual consists of pages dated as shown in the following index.

** INDEX **

| <u>Page Description</u> | <u>Page</u> | <u>Date</u> | <u>Supersedes</u> |
|---|-------------|-------------|-------------------|
| Cabinet Components--Exploded View | 1 | 1-24-91 | |
| " " --Usage List | 2 | 1-24-91 | |
| Functional Components--Exploded View | 3 | 2-20-91 | 1-24-91 |
| " " --Usage List | 4 | 2-20-91 | 1-24-91 |
| Control Panel W/Circuit Breaker--Layout | 5 | 1-24-91 | |
| " " --Usage List | 6 | 2-20-91 | 1-24-91 |
| Control Panel W/O Circuit Breaker--Layout | 7 | 6-07-91 | |
| " " --Usage List | 8 | 6-07-91 | |
| Blower Assembly--Exploded View | 9 | 6-07-91 | 1-24-91 |
| " " --Usage List | 10 | 6-07-91 | 1-24-91 |

*** IMPORTANT ***

Contact the installing and/or local Bard distributor for all parts requirements. Make sure you have the complete model and serial number available from the unit rating plate.

CABINET COMPONENTS

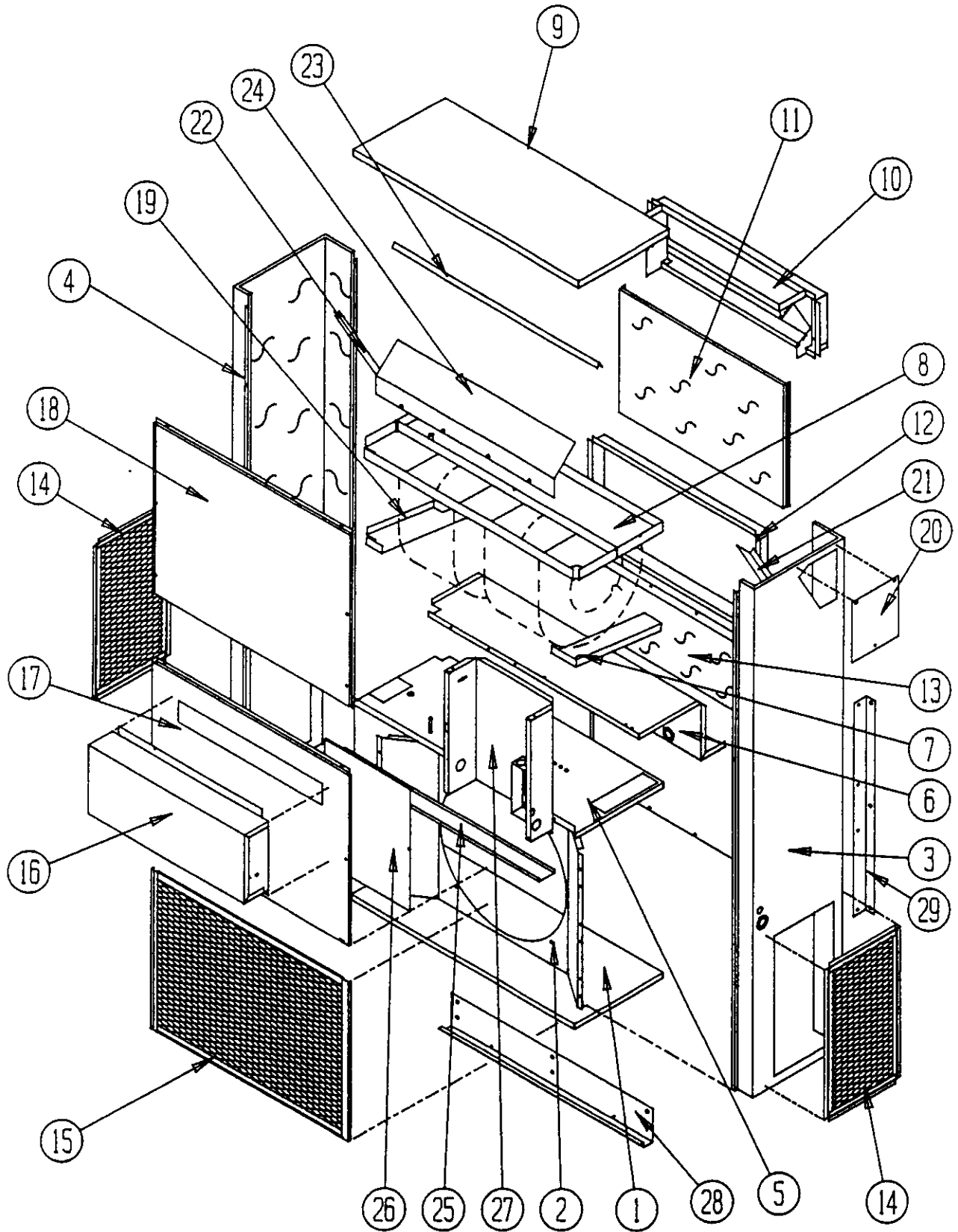

CABINET COMPONENTS

| Dwg. No. | Part No. | Description | S T A N D A R D |
|----------|------------------------|---|--------------------------------------|
| 1 | 126-003 | Lower Base | x |
| 2 | 124-019 | Fan Shroud | x |
| 3 | 501-224 | Right Side | x |
| 4 | 501-225 | Left Side | x |
| 5 | 127-098 | Compressor Base | x |
| 6 | 520-097 | Compressor Partition | x |
| 7 | 130-076 | Filter Bracket (Right) | x |
| 8 | 521-004 | Blower Partition/Drain Pan Assembly | x |
| 9 | 506-095 | Top | x |
| 10 | 111-017 | Outlet Airframe Assembly | x |
| 11 | 508-056 | Upper Back | x |
| 12 | 111-018 | Inlet Air Frame Assembly | x |
| 13 | 508-057 | Lower Back | x |
| 14 | 119-004 | Side Grille | 2 |
| 15 | 119-003 | Condenser Grille | x |
| 16 | 962004 | Fresh Air Damper Assembly FAD25B | x |
| 17 | 552-107 | Service Door | x |
| 18 | 514-046 | Upper Front | x |
| 19 | 130-077 | Filter Bracket (Left) | x |
| 20 | 542X004 | Right Side Cover Plate | x |
| 21 | 141-006 | Right Evaporator Support | x |
| 22 | 141-007 | Left Evaporator Support | x |
| 23 | 134-072 | Evaporator Fill Plate | x |
| 24 | 134-008 | Air Baffle | x |
| 25 | 136-130 | Condenser Coil Spacer | x |
| 26 | Cntrl.Cvr. | See Control Panel Assembly Drawing and Parts List | x |
| 27 | Cntrl.Pnl. Assembly | See Control Panel Assembly Drawing and Parts List | x |
| 28 | 112-006 | Bottom Mounting Bracket | x |
| 29 | 112-002 | Side Mounting Bracket | 2 |

Date: 1-24-91
Supersedes:

FUNCTIONAL COMPONENTS

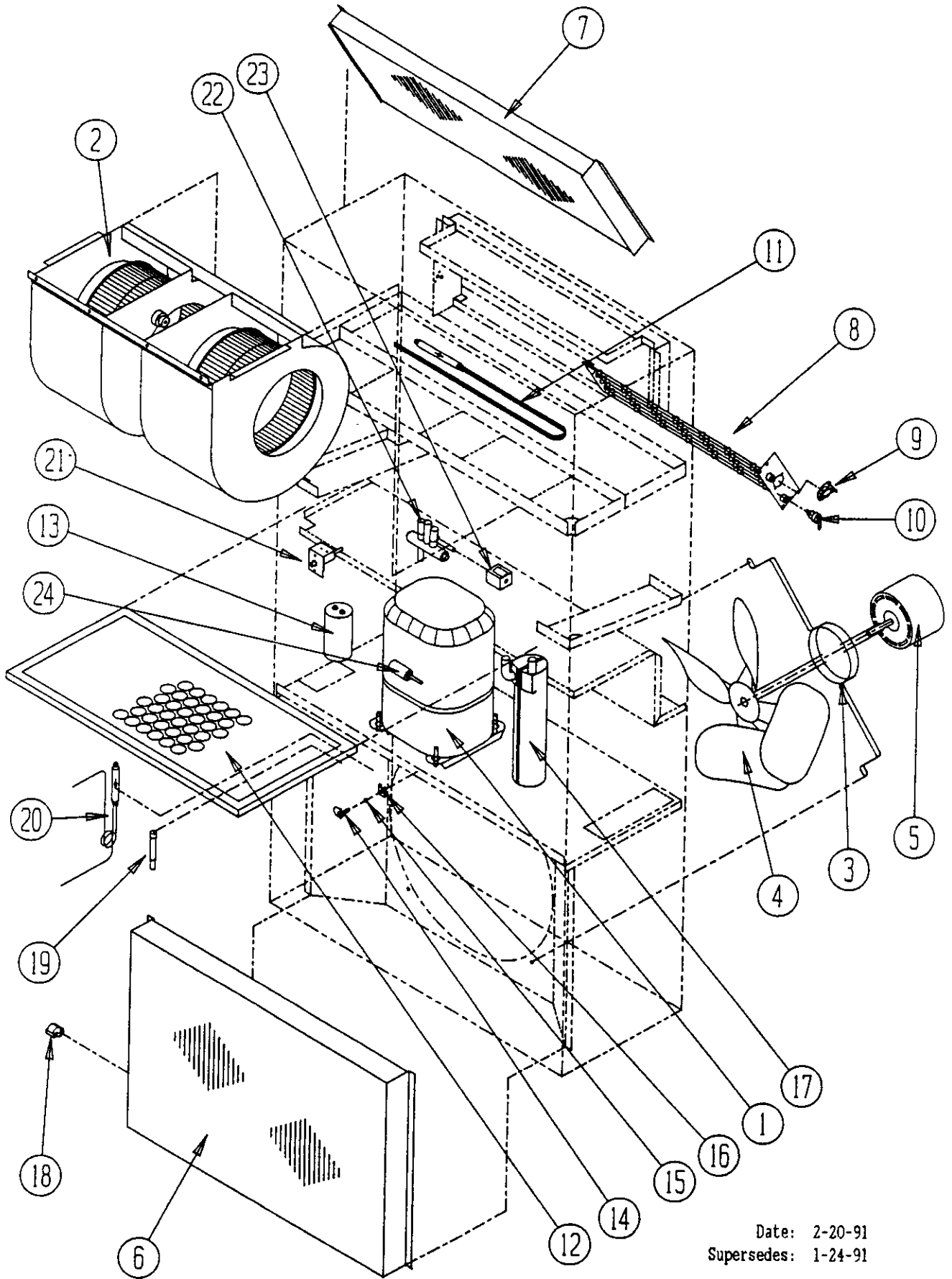

Date: 2-20-91
Supersedes: 1-24-91

FUNCTIONAL COMPONENTS

| Dwg. No. | Part No. | Description | 3 6 W H 7 A 0 0 C | 3 6 W H 7 A 0 5 C | 3 6 W H 7 A 1 0 C | 3 6 W H 7 A 1 5 C | 3 6 W H 7 B 0 0 C | 3 6 W H 7 B 0 6 C | 3 6 W H 7 B 0 9 C | 3 6 W H 7 B 1 5 C | 3 6 W H 7 C 0 0 C | 3 6 W H 7 C 0 9 C | 3 6 W H 7 C 1 5 C |
|----------|----------|----------------------------|--|--|--|--|--|--|--|--|--|--|--|
| 1 | 8000-087 | Compressor R23A383ABCA | x | x | x | x | | | | | | | |
| 1 | 8000-059 | Compressor CRJ3-0300-TF5 | | | | | x | x | x | x | | | |
| 1 | 8000-060 | Compressor CRJ3-0300-TFD | | | | | | | | | x | x | x |
| 2 | 900-039 | Blower Assembly (Complete) | x | x | x | x | x | x | x | x | | | |
| 2 | 900-070 | Blower Assembly (Complete) | | | | | | | | | x | x | x |
| 3 | 8200-001 | Motor Mount (Condenser) | x | x | x | x | x | x | x | x | x | x | x |
| 4 | 5151-032 | Fan Blade | x | x | x | x | x | x | x | x | x | x | x |
| 5 | 8103-019 | Condenser Motor | x | x | x | x | x | x | x | x | | | |
| 5 | 8103-014 | Condenser Motor | | | | | | | | | x | x | x |
| 6 | 5051-053 | Condenser Coil | x | x | x | x | x | x | x | x | x | x | x |
| 7 | 5060-052 | Evaporator Coil | x | x | x | x | x | x | x | x | x | x | x |
| 8 | 8604-089 | Heat Strip | | x | | | | | | | | | |
| 8 | 8604-091 | Heat Strip | | | x | | | | | | | | |
| 8 | 8604-047 | Heat Strip | | | | x | | | | | | | |
| 8 | 8604-048 | Heat Strip | | | | | | x | x | | | | |
| 8 | 8604-049 | Heat Strip | | | | | x | | x | | | | |
| 8 | 8604-072 | Heat Strip | | | | | | | | | x | x | |
| 8 | 8604-079 | Heat Strip | | | | | | | | | | | x |
| 9 | 8402-031 | Limit Control | | x | x | x | | x | x | x | | | |
| 9 | 8402-060 | Limit Control | | | | | | | | | | x | x |
| 10 | 8402-030 | Thermal Cut-Off | | | | | | | | | | | |
| 10 | 8402-032 | Thermal Cut-Off | | x | 2 | 3 | | 2 | 2 | 4 | | | |
| 10 | 8402-059 | Thermal Cut-Off | | | | | | | | | | 2 | 4 |
| 11 | 800-0118 | Cooling Capillary Assembly | x | x | x | x | x | x | x | x | x | x | x |
| 12 | 7003-025 | Air Filter Assembly | x | x | x | x | x | x | x | x | x | x | x |
| 13 | 8552-028 | Capacitor 35/440 | x | x | x | x | | | | | | | |
| 14 | 1171-019 | 1/4 Turn Fastener | x | x | x | x | x | x | x | x | x | x | x |
| 15 | 1171-021 | Fastener Retainer | x | x | x | x | x | x | x | x | x | x | x |
| 16 | 1171-020 | Fastener Receptacle | x | x | x | x | x | x | x | x | x | x | x |
| 17 | 5202-016 | Accumulator | x | x | x | x | x | x | x | x | x | x | x |
| 18 | 8408-016 | Defrost Thermostat | x | x | x | x | x | x | x | x | x | x | x |
| 19 | 5651-036 | Check Valve | x | x | x | x | x | x | x | x | x | x | x |
| 20 | 800-0144 | Heating Capillary Assembly | x | x | x | x | x | x | x | x | x | x | x |
| 21 | 8406-010 | High Pressure Switch | x | x | x | x | x | x | x | x | x | x | x |
| 22 | 5650-013 | Reversing Valve | x | x | x | x | x | x | x | x | x | x | x |
| 23 | 5650-008 | Solenoid Coil | x | x | x | x | x | x | x | x | x | x | x |
| 24 | 8406-049 | Low Pressure Switch | x | x | x | x | x | x | x | x | x | x | x |

Date: 2-20-91
Supersedes: 1-24-91

2110-509

CONTROL PANEL WITH CIRCUIT BREAKER

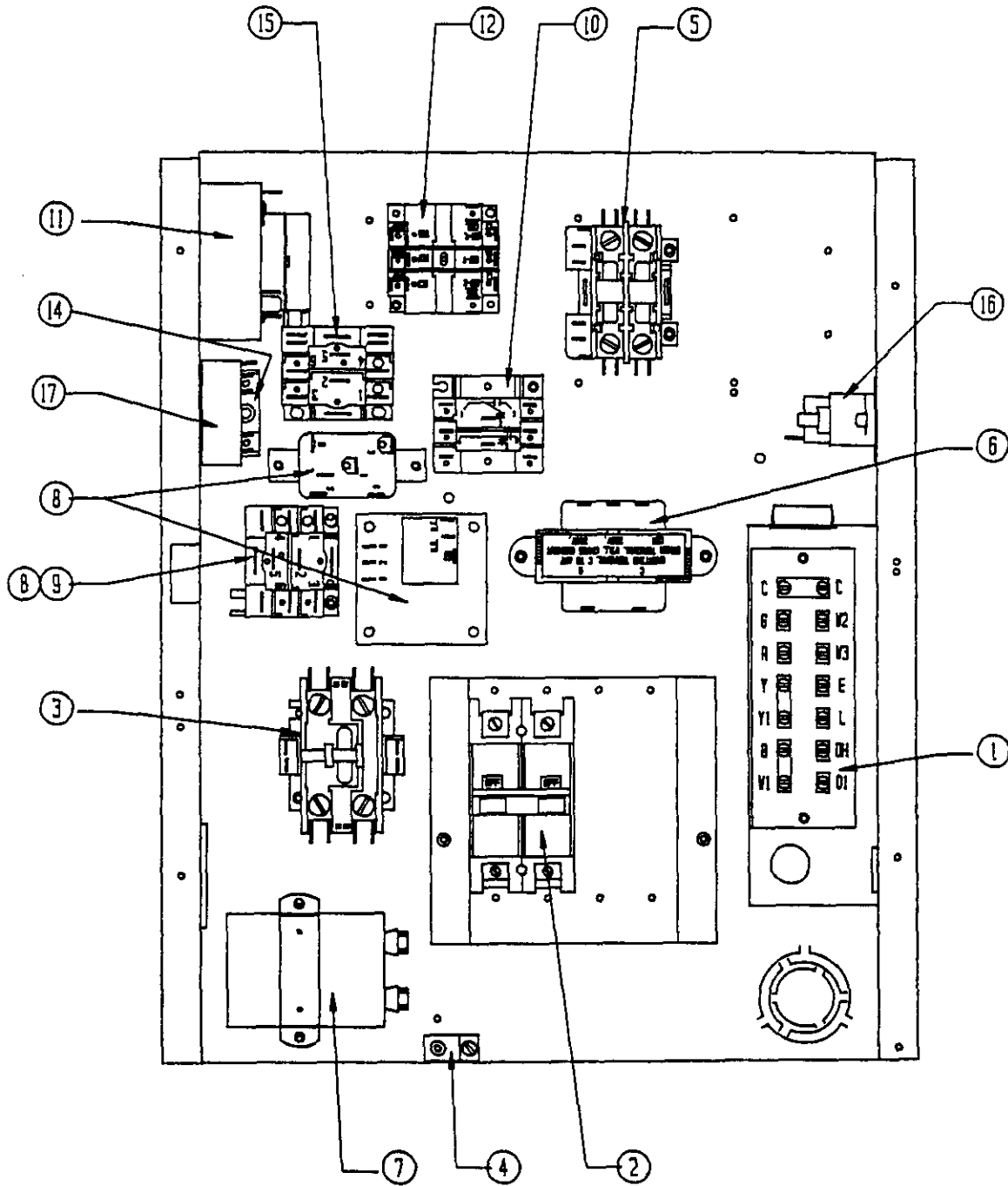

Date: 1-24-91
Supersedes:

CONTROL PANEL
WITH CIRCUIT BREAKER

| Dwg. No. | Part No. | Description | 3 6 W H 7 A O O C | 3 6 W H 7 A O 5 C | 3 6 W H 7 A O 1 C | 3 6 W H 7 A O 5 C | 3 6 W H 7 B O 0 C | 3 6 W H 7 B O 9 C | 3 6 W H 7 B O 5 C | 3 6 W H 7 C O 0 C | 3 6 W H 7 C O 9 C | 3 6 W H 7 C O 1 C |
|----------|----------|-------------------------------|--|--|--|--|--|--|--|--|--|--|
| 1 | 8607-019 | Low Voltage Terminal Strip | x | x | x | x | x | x | x | x | x | x |
| 2 | 8615-015 | Circuit Breaker | x | | | | | | | | | |
| 2 | 8615-016 | Circuit Breaker | | x | x | 2 | | | | | | |
| 2 | 8615-013 | Circuit Breaker | | | x | | | | | | | |
| 2 | 8615-020 | Circuit Breaker | | | | | x | | | | | |
| 2 | 8615-011 | Circuit Breaker | | | | | x | x | | | | |
| 2 | 8615-029 | Circuit Breaker | | | | | | | x | | | |
| 2 | 8615-032 | Circuit Breaker | | | | | | | | x | x | |
| 3 | 8401-007 | Compressor Contactor | x | x | x | x | | | | | | |
| 3 | 8401-002 | Compressor Contactor | | | | | x | x | x | x | x | x |
| 4 | 8611-006 | Ground Terminal | x | x | 2 | 2 | x | x | x | x | x | x |
| 5 | 8401-006 | Heat Contactor | | x | x | 2 | | x | 2 | | | |
| 5 | 8401-002 | Heat Contactor | | | | | | | | | x | 2 |
| 6 | 8407-035 | Transformer | x | x | x | x | x | x | x | | | |
| 6 | 8407-040 | Transformer | | | | | | | | x | x | x |
| 7 | 8552-002 | Condenser Fan Capacitor | x | x | x | x | x | x | x | x | x | x |
| 8 | 8201-032 | Blower Relay | | | | | | | | x | x | x |
| 8 | 8201-009 | Blower Relay | x | x | x | x | | | | | | |
| 8 | 8201-056 | Blower Control | | | | | x | x | x | | | |
| 9 | 8201-024 | Compressor Fault Relay | x | x | x | x | | | | | | |
| 10 | 8201-013 | Emergency Heat Relay | | | | x | | | x | | | x |
| 11 | 8612-012 | Defrost Timer | x | x | x | x | x | x | x | x | x | x |
| 12 | 8201-047 | Defrost Relay | x | x | x | x | x | x | x | x | x | x |
| 14 | 8607-017 | Motor Speed Terminal Block | | | | | | | | x | x | x |
| 15 | 8201-032 | Blower Relay | | | | | | | | x | x | x |
| 16 | 8201-045 | Time Delay Relay | | | | | | | | x | x | x |
| 17 | 8201-050 | Time Delay Relay (Compressor) | x | x | x | x | x | x | x | x | x | x |
| | 4013-112 | Wiring Diagram | x | | | | | | | | | |
| | 4013-122 | Wiring Diagram | | x | | | | | | | | |
| | 4013-132 | Wiring Diagram | | | x | | | | | | | |
| | 4013-142 | Wiring Diagram | | | | x | | | | | | |
| | 4013-212 | Wiring Diagram | | | | | x | | | | | |
| | 4013-222 | Wiring Diagram | | | | | | x | | | | |
| | 4013-232 | Wiring Diagram | | | | | | | x | | | |
| | 4013-312 | Wiring Diagram | | | | | | | | x | | |
| | 4013-324 | Wiring Diagram | | | | | | | | | x | |
| | 4013-332 | Wiring Diagram | | | | | | | | | | x |
| | 132-050 | Control Panel Cover | | | | | | | | x | x | x |
| | 132-098 | Control Panel Cover | x | x | x | x | x | x | | | | |

Date: 2-20-91
Supersedes: 1-24-91

2110-509

CONTROL PANEL WITHOUT CIRCUIT BREAKERS

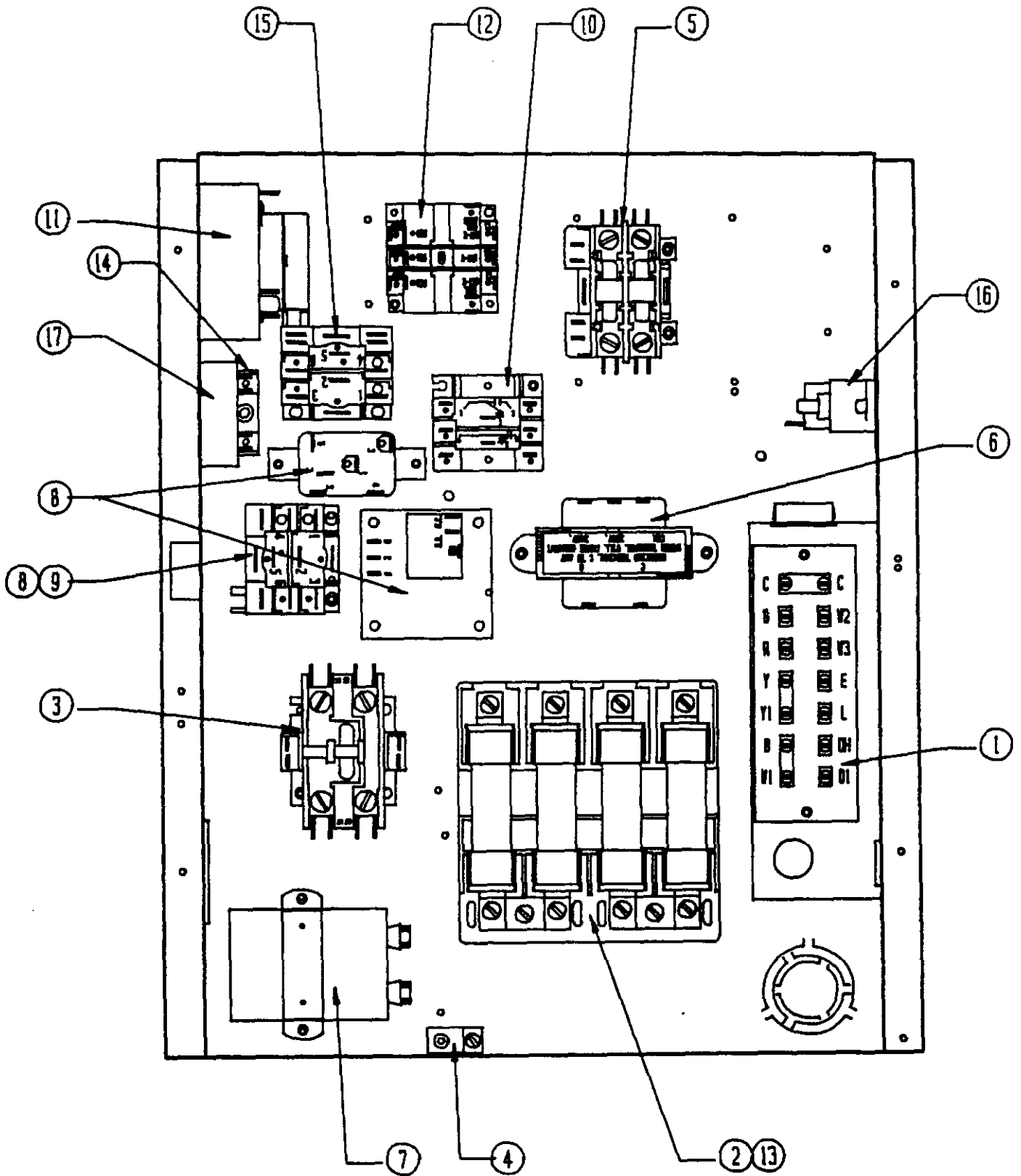

Date: 6-07-91
Supersedes:

CONTROL PANEL
WITHOUT CIRCUIT BREAKERS

| Dwg. No. | Part No. | Description | 3 6 W H 7 C O O N, N, |
|-------------|----------|-------------------------------|---|
| 1 | 8607-019 | Low Voltage Terminal Strip | x |
| 2 | 8607-014 | Terminal Block | x |
| 3 | 8401-002 | Compressor Contactor | x |
| 4 | 8611-006 | Ground Terminal | x |
| 6 | 8407-040 | Transformer | x |
| 7 | 8552-002 | Condenser Fan Capacitor 5/370 | x |
| 8 | 8201-032 | Blower Relay | x |
| 11 | 8612-012 | Defrost Timer | x |
| 12 | 8201-047 | Defrost Relay | x |
| 13 | 8607-015 | Phenolic Insulator | x |
| 14 | 8607-017 | Motor Speed Terminal Block | x |
| 15 | 8201-032 | Defrost Relay | x |
| 16 | 8201-045 | Time Delay Relay | x |
| 17 | 8201-050 | Time Delay Relay | x |
| | 4013-313 | Wiring Diagram | x |
| | 132-003 | Control Panel Cover | x |

Date: 6-07-91
Supersedes:

BLOWER ASSEMBLY

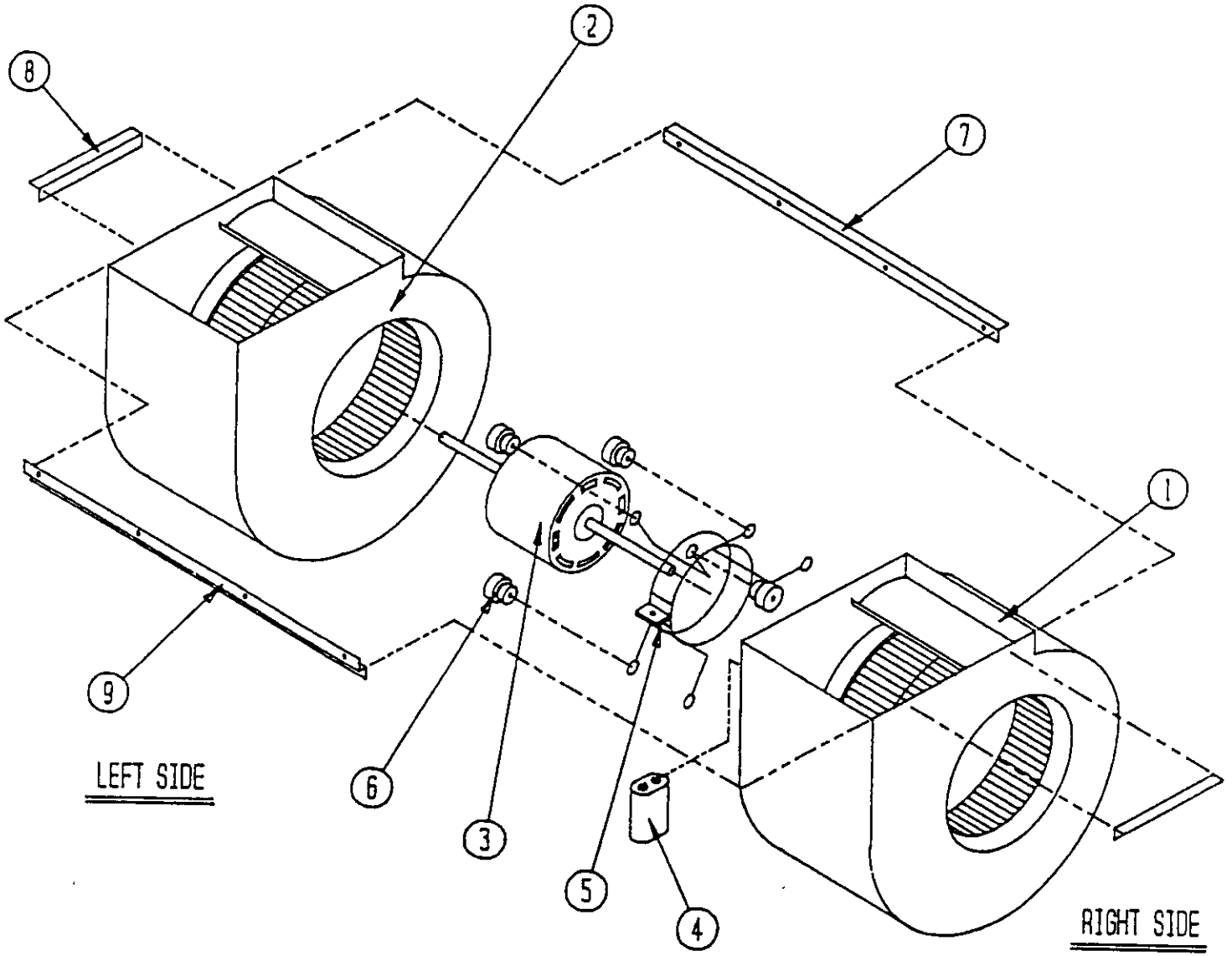

Date: 6-07-91
Supersedes: 1-24-91

BLOWER ASSEMBLY

| Dwg. No. | Part No. | Description | 9 0 0 0 3 9 | 9 0 0 0 7 0 |
|----------|----------|--------------------------------|----------------------------|----------------------------|
| 1 | 5152-051 | Housing, Wheel and Cutoff (CW) | x | x |
| 2 | 5152-052 | Housing, Wheel and Cutoff | x | x |
| 3 | 8105-029 | Blower Motor (230/208) | x | |
| 3 | 8105-033 | Blower Motor (460) | | x |
| 4 | 8552-002 | Capacitor | x | x |
| 5 | 8200-031 | Motor Mount | x | x |
| 6 | 5451-011 | Grommets | 6 | 6 |
| 7 | 104-505 | Back Brace | x | x |
| 8 | 104-001 | Side Angle | 2 | 2 |
| 9 | 102-300 | Front Brace | x | x |

Date: 6-07-91
Supersedes: 1-24-91

