

# Replacement Parts Manual

# WALL MOUNT GAS ELECTRICS

Models:  
WAG30C WAG36C  
WAG40C

## General Notes

- Revised and/or additional pages may be issued from time to time.
- A complete and current manual consists of pages shown in the following contents section.

## Important

- Contact the installing and/or local Bard distributor for all parts requirements. Make sure you have the complete model and serial number available from the unit rating plate.

## Contents

Description	Page
Cabinet Components	
♦ Exploded View .....	1
♦ Usage List .....	2
Functional Components	
♦ Exploded View .....	3
♦ Usage List .....	4
Control Panel Components	
♦ Layout View .....	5
♦ Usage List .....	6



**BARD MANUFACTURING COMPANY**  
Bryan, Ohio 43506

*Since 1914...Moving ahead, just as planned.*

Manual: 2110-8011  
Supersedes: Rev H  
File: Vol III Tab 20  
Date: 11-15-96

# CABINET COMPONENTS

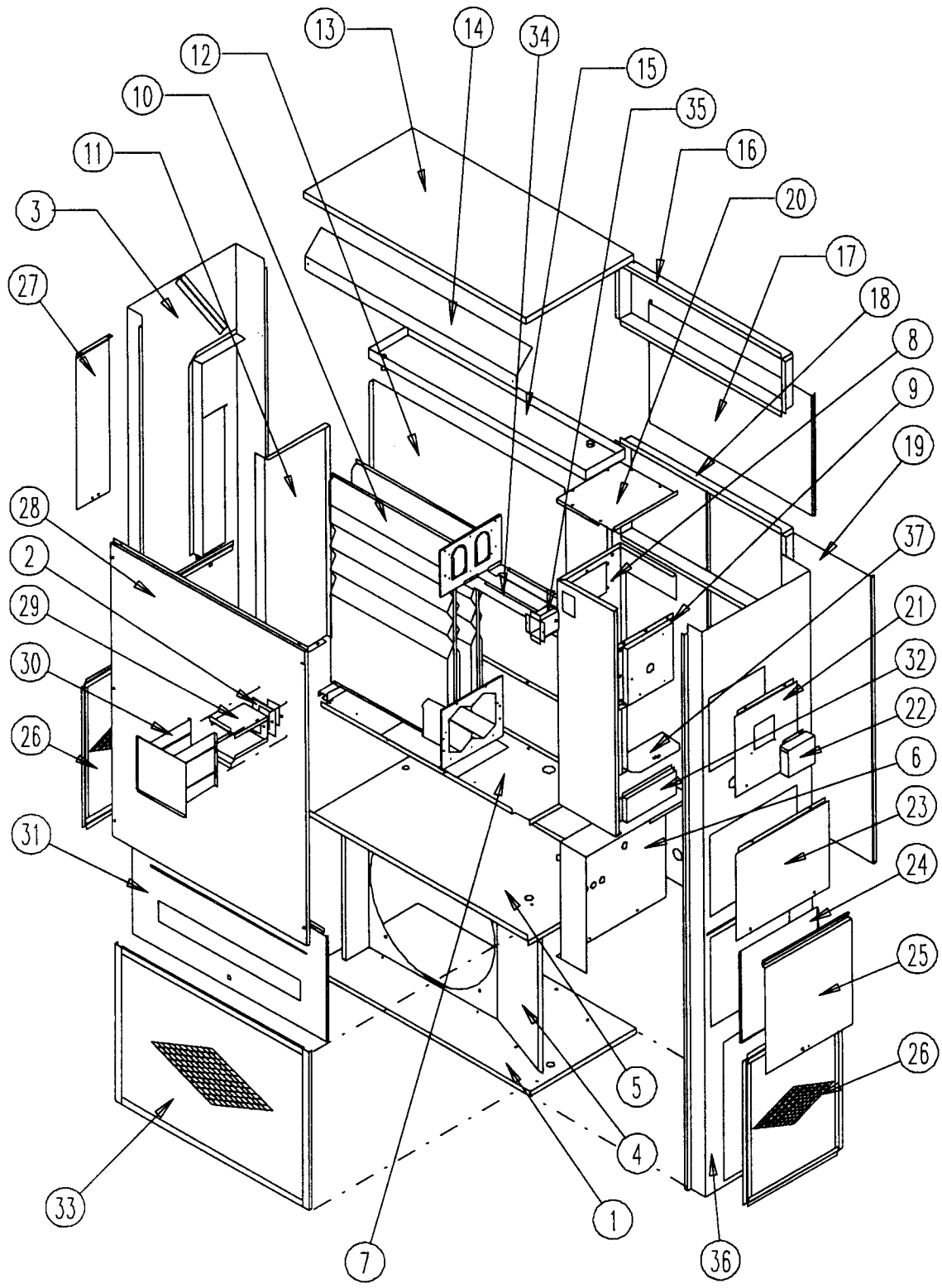

# CABINET COMPONENTS

Drawing No.	Part No.	Description	WAG30C-A54C	WAG36C-A54C	WAG36C-B54C	WAG36C-C54C	WAG40C-A54C	WAG40C-B54C	WAG40C-C54C
1	127-216	Lower Base	X	X	X	X	X	X	X
2	1921-017	Vent Terminal Gasket <i>1921-017</i>	X	X	X	X	X	X	X
3	501-179-* (1)	Left Side Assembly	X	X	X	X	X	X	X
4	124-016	Fan Shroud	X	X	X	X	X	X	X
5	520-108	Condenser Partition	X	X	X	X	X	X	X
6	Control Panel	(See Control Panel Assembly Drawing & Parts List)							
7	127-143	Blower Base	X	X	X	X	X	X	X
8	520-110	Heat Exchanger Partition	X	X	X	X	X	X	X
9	913-0018	Flue Collector Box Assembly	X	X	X	X	X	X	X
10	171-152	Heat Exchanger Assembly	X	X	X	X	X	X	X
11	520-111	Side Partition Assembly	X	X	X	X	X	X	X
12	520-109	Vertical Partition	X	X	X	X	X	X	X
13	506-107-* (1)	Top	X	X	X	X	X	X	X
14	134-096	Air Baffle	X	X	X	X	X	X	X
15	123-067	Water Pan Assembly	X	X	X	X	X	X	X
16	111-025	Outlet Air Frame	X	X	X	X	X	X	X
17	508-056	Upper Back	X	X	X	X	X	X	X
18	111-018	Inlet Air Frame	X	X	X	X	X	X	X
19	508-069	Lower Back Assembly	X	X	X	X	X	X	X
20	506-108	Heat Exchanger Partition Top	X	X	X	X	X	X	X
21	552-138-* (1)	Induced blower Door	X	X	X	X	X	X	X
22	135-097-* (1)	Induced Blower Hood	X	X	X	X	X	X	X
23	152-139-* (1)	Burner Door	X	X	X	X	X	X	X
24	132-096	Inner Control Cover	X	X	X		X	X	
24	132-116	Inner Control Cover				X			X
25	152-136-* (1)	Outer Control Cover	X	X	X	X	X	X	X
26	119-020-* (1)	Side Condenser Grille	X	X	X	X	X	X	X
27	552-137-* (1)	Filter Access	X	X	X	X	X	X	X
28	514-062-* (1)	Upper Front <i>514-123</i>	X	X	X	X	X	X	X
29	168-029-* (1)	Inner Vent Terminal <i>168-106</i>	X	X	X	X	X	X	X
30	169-030-* (1)	Outer Vent Terminal <i>169-107</i>	X	X	X	X	X	X	X
31	514-080-* (1)	Lower Front	X	X	X	X	X	X	X
32	168-003	Secondary Air Baffle	X	X	X	X	X	X	X
33	119-003-* (1)	Front Condenser Grille	X	X	X	X	X	X	X
34	168-002	Flue Baffle	X	X	X	X	X	X	X
35	169-026	Flue Transition <i>169-107</i>	X	X	X	X	X	X	X
36	501-178-* (1)	Right Side Assembly	X	X	X	X	X	X	X
37	140-164	Switch Support	X	X	X	X	X	X	X

*820  
147*

(1) Exterior cabinet parts are manufactured with various color options. To insure that you receive the proper color, you must include the complete model and serial number of the unit for which parts are being ordered.

SEXP-009

# FUNCTIONAL COMPONENTS

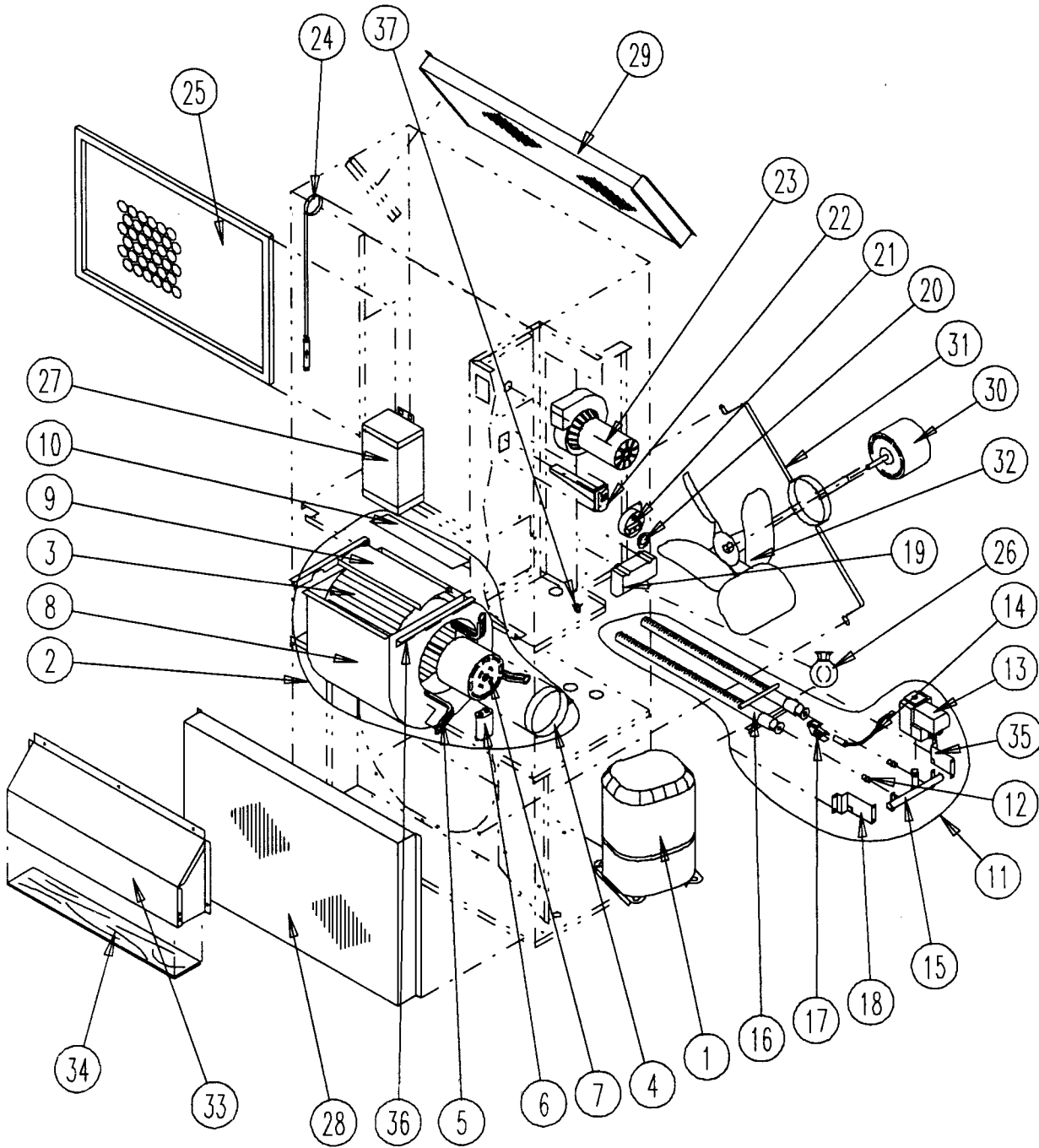

SEXP-010

# FUNCTIONAL COMPONENTS

Drawing No.	Part No.	Description	WAG30C-A54C	WAG36C-A54C	WAG36C-B54C	WAG36C-C54C	WAG40C-A54C	WAG40C-B54C	WAG40C-C54C
1	8000-132	Compressor	X						
1	8000-125	Compressor		X					
1	8000-133	Compressor			X				
1	8000-134	Compressor				X			
1	8000-126	Compressor					X		
1	8000-127	Compressor						X	
1	8000-128	Compressor							X
2	900-123	Blower Assembly (Complete)	X	X	X	X	X	X	X
3	5152-059	Blower Wheel	X	X	X	X	X	X	X
4	8200-033	Motor Mount Band	X	X	X	X	X	X	X
5	8200-036	Motor Mount Arm	3	3	3	3	3	3	3
6	8552-002	Capacitor	X	X	X	X	X	X	X
7	8105-031	Blower Motor	X	X	X	X	X	X	X
8	151-083	Blower Housing	X	X	X	X	X	X	X
9	144-129	Diffuser	X	X	X	X	X	X	X
10	104-752	Blower Seal	X	X	X	X	X	X	X
11	901-0072	Burner Assembly (Complete)	X	X	X	X	X	X	X
12	9010-043	High Rate Orifice (Nat. #36)	2	2	2	2	2	2	2
13	5651-080	Gas Valve	X	X	X	X	X	X	X
14	8600-010	Ignition Wire	X	X	X	X	X	X	X
15	5818-023	Burner Manifold	X	X	X	X	X	X	X
16	9010-036	Burner (2 Cell)	X	X	X	X	X	X	X
17	8620-038	Pilot Burner	X	X	X	X	X	X	X
18	112Y095	Left Manifold Bracket	2	2	2	2	2	2	2
19	5651-093	Ignition Module	X	X	X	X	X	X	X
20	5451-015	Rubber Grommet	X	X	X	X	X	X	X
21	8406-052	Pressure Switch	X	X	X	X	X	X	X
22	8402-052	Limit Control	X	X	X	X	X	X	X
23	8109-002	Induced Draft Motor	X	X	X	X	X	X	X
24	800-0128	Capillary Assembly	X						
24	800-0129	Capillary Assembly		X	X	X			
24	800-0130	Capillary Assembly					X	X	X
25	7004-016	Air Filter	X	X	X	X	X	X	X
26	400-0027	Low Rate Orifice Kit (Nat. #40)	X	X	X	X	X	X	X
27	8407-003	460V Transformer				X			X
28	5051-035	Condenser Coil	X						
28	5051-054	Condenser Coil		X	X	X			
28	5051-050	Condenser Coil					X	X	X
29	5060-037	Evaporator Coil	X						
29	5060-050	Evaporator Coil		X	X	X	X	X	X
30	8103-019	Condenser Motor	X						
30	8105-034	Condenser Motor		X	X	X	X	X	X
31	8200-037	Fan Motor Mount	X	X	X	X	X	X	X
32	5151-038	Fan Blade	X						
32	5151-028	Fan Blade		X	X	X	X	X	X
33	913-0068	Fresh Air Damper Assembly	X	X	X	X	X	X	X
34	7003-036	Air Filter	X	X	X	X	X	X	X
35	112X095	Right Manifold Bracket	X	X	X	X	X	X	X
36	104-971	Blower Angles	2	2	2	2	2	2	2
37	8406-046	Flame Rollout Switch	X	X	X	X	X	X	X
NS	8620-040	Pilot Gas Tube w/Fittings	X	X	X	X	X	X	X
NS	5153-030	Tee/Orifice Assembly	X	X	X	X	X	X	X

# CONTROL PANEL COMPONENTS

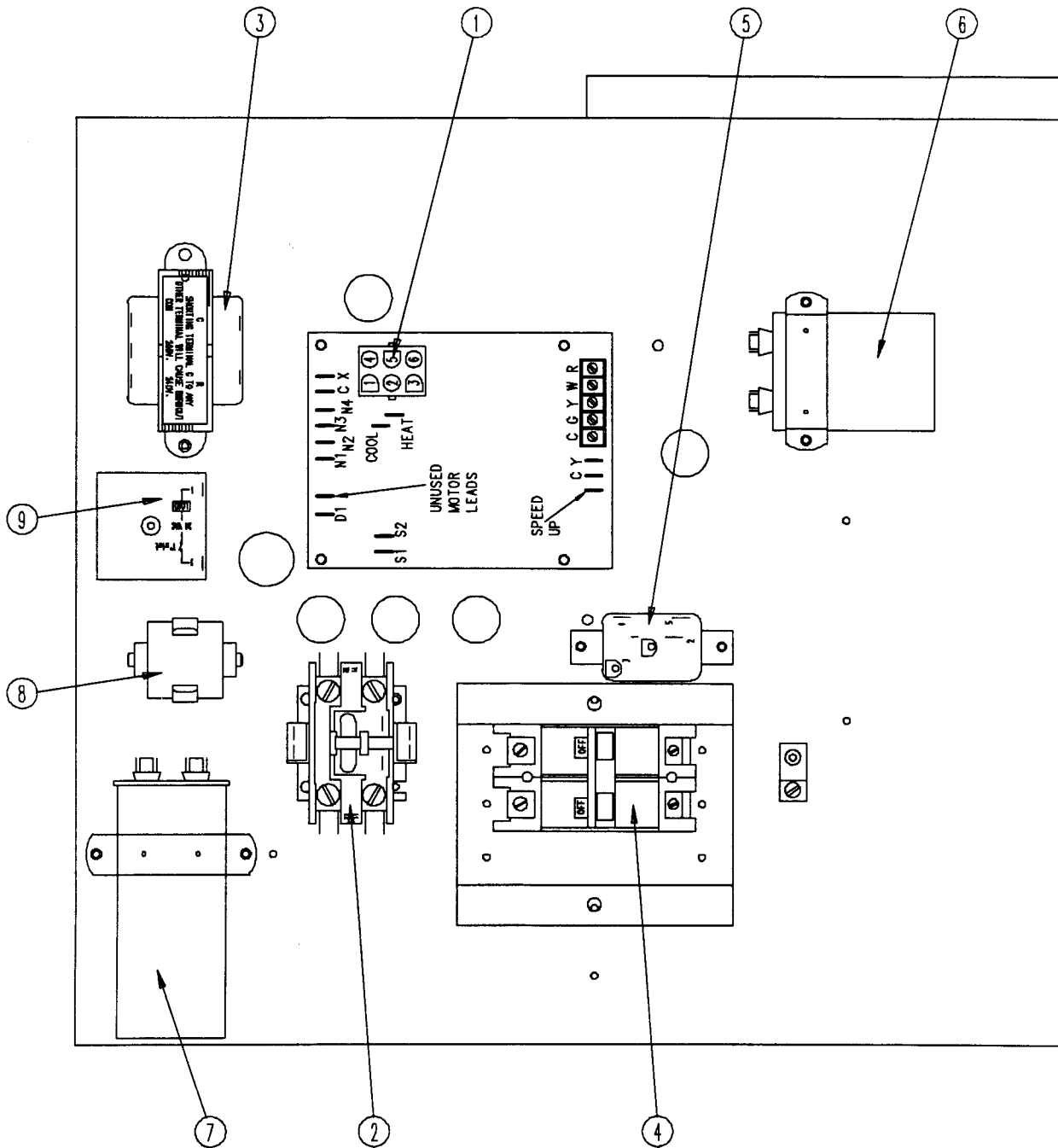

# CONTROL PANEL COMPONENTS

Drawing			WAG30C-A54C	WAG36C-A54C	WAG36C-B54C	WAG36C-C54C	WAG40C-A54C	WAG40C-B54C	WAG40C-C54C
No.	Part No.	Description							
1	8201-076	Blower <del>Coil</del> <i>Coil</i>	X	X	X	X	X	X	X
2	8401-007	Contactator Coil	X	X			X		
2	8401-002	Contactator Coil			X	X		X	X
3	8407-046	Transformer	X	X	X	X	X	X	X
4	8615-038	Circuit Breaker	X						
4	8615-055	Circuit Breaker		X					
4	8615-052	Circuit Breaker			X				
4	8615-040	Circuit Breaker					X		
4	8615-042	Circuit Breaker						X	
4	8615-053	Pull Disconnect				X			X
5	8201-008	Outdoor Fan Relay				X			X
6	8552-005	Fan Capacitor			X	X		X	X
7	8552-048	Compressor/Fan Capacitor	X						
7	8552-055	Compressor/Fan Capacitor		X			X		
8		Low Voltage Kit	↔ Field Installed ↔						
9		Compressor Anti Cycle Relay	↔ Field Installed ↔						
	4085-112	Wiring Diagram	X	X			X		
	4085-212	Wiring Diagram			X			X	
	4085-312	Wiring Diagram				X			X