

REPLACEMENT PARTS MANUAL

HIGH EFFICIENCY GAS FURNACE

MODELS : DCL065D36A, DCL080D48A,
DCL095D60A, DCL110D60A

Manual 2110-867

Revision B

Date 12-15-94

Supersedes 07-18-94

* GENERAL NOTES *

*Revised and/or additional pages may be issued from time to time.
*A complete and current manual consists of pages dated as shown in the following index.

** INDEX **

<u>Page</u>	<u>Description</u>	<u>Page</u>	<u>Date</u>	<u>Supersedes</u>
Cabinet	Components--Exploded View	1	02-01-94	
"	" --Usage List	2	12-15-94	02-01-94
"	" --Usage List	3	12-15-94	02-01-94
Functional	Components--Exploded View	4	07-18-94	02-01-94
"	" --Usage List	5	07-18-94	02-01-94
Control	Panel Wire Assemblies--Exploded View	6	02-01-94	
"	" --Usage List	7	07-18-94	02-01-94

*** IMPORTANT ***

Contact the installing and/or local Bard distributor for all parts requirements. Make sure you have the complete model and serial number available from the unit rating plate.

BARD MANUFACTURING COMPANY

BRYAN, OHIO 43506

CABINET COMPONENTS

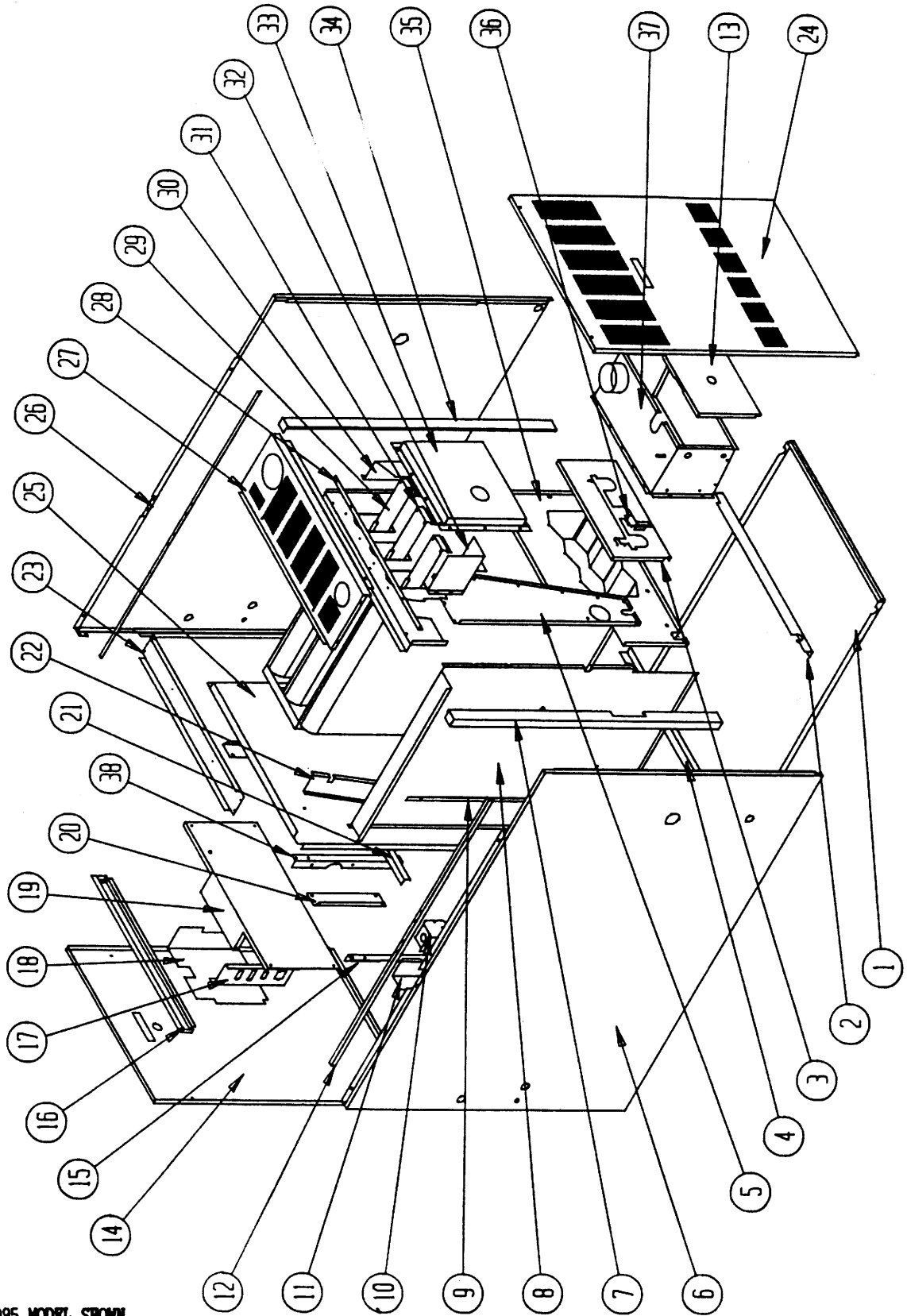

DC1080/095 MODEL SHOWN

Date: 02-01-94
Supersedes:

2110-867
Page: 1

CABINET COMPONENTS

Dwg. No.	Part No.	Description	D	D	D	D
			C	C	C	C
			L	L	L	L
			O	O	O	O
			6	8	9	1
			5	0	5	0
			D	D	D	D
			3	4	6	6
			6	8	0	0
			A	A	A	A
1	S126-232	Base Assembly	x			
1	S126-233	Base Assembly		x	x	
1	S126-234	Base Assembly				x
2	104-917	Front Base Angle	x			
2	104-918	Front Base Angle		x	x	
2	104-919	Front Base Angle				x
3	168-050	Secondary Air Restrictor	x			
3	168-055	Secondary Air Restrictor		x	x	
3	168-060	Secondary Air Restrictor				x
4	104-920	Rear Base Angle	x			
4	104-921	Rear Base Angle		x	x	
4	104-922	Rear Base Angle				x
5	520-227	Coil Partition Assembly	x	x	x	x
6	500-283	Left Side Assembly	x	x	x	x
7	S104-889	Left Side Angle	x	x	x	x
8	S120-270	Internal Coil Partition	x	x	x	x
9	134-142	Coil Air Deflector	x	x	x	x
10	116-130	Junction Box	x	x	x	x
11	132-107	Junction Box Cover	x	x	x	x
12	104-934	Side Top Support Angle	x	x	x	x
13	S168-052	Burner Box Cover	x			
13	S168-058	Burner Box Cover		x	x	
13	S168-063	Burner Box Cover				x
14	S552-233	Blower Door Assembly	x			
14	S552-234	Blower Door Assembly		x	x	
14	S552-235	Blower Door Assembly				x
15	104Y925	Left Blower Angle			x	x
15	104Y926	Left Blower Angle	x	x		
16	108-104	Upper Back	x			
16	108-105	Upper Back		x	x	
16	108-106	Upper Back				x
17	116-166	Control Panel Plug Support	x	x	x	x
18	132-123	Control Panel Cover	x	x	x	x
19	116-161	Control Panel	x			
19	116-160	Control Panel		x	x	
19	116-163	Control Panel				x
20	116-164	Control Panel Support	2	2	2	2
21	104-936	Filter Support Angle	x			
21	104-935	Filter Support Angle		x	x	
21	104-937	Filter Support Angle				x
22	S136-272	Internal Coil Fill	x	x	x	x

Date: 12-15-94
Supersedes: 02-01-94

CABINET COMPONENTS

Dwg. No.	Part No.	Description	D C L O 6 5 D 3 6 A	D C L O 8 0 D 4 8 A	D C L O 9 5 D 6 0 A	D C L O 1 1 0 D 6 0 A
23	164-545	Top Channel	x			
23	164-546	Top Channel		x	x	
23	164-547	Top Channel				x
24	S152-209	Vestibule Door	x			
24	S152-216	Vestibule Door		x	x	
24	S152-217	Vestibule Door				x
25	520-261	Blower Partition Assembly	x			
25	520-262	Blower Partition Assembly		x	x	
25	520-263	Blower Partition Assembly				x
26	500-282	Right Side Assembly	x	x	x	x
27	S106-152	Top Fill Assembly	x			
27	S106-151	Top Fill Assembly		x	x	
27	S106-153	Top Fill Assembly				x
28	104-895	Top Fill Angle	x			
28	104-896	Top Fill Angle		x	x	
28	104-897	Top Fill Angle				x
29	168-002	Internal Flue Baffle	2	3	3	2
30	134-121	Intake Air Shield	x			
31	168-013	Internal Flue Baffle				2
32	134-120	Vent Air Shield	x	x	x	x
33	S168-054	Collector Box Assembly	x			
33	S168-081	Collector Box Assembly		x	x	
33	S168-064	Collector Box Assembly				x
34	S104-903	Right Side Angle	x	x	x	x
35	171-216	Heat Exchanger Assembly	x			
35	171-217	Heat Exchanger Assembly		x	x	
35	171-218	Heat Exchanger Assembly				x
36	112-147	Ignitor Bracket	x	x	x	x
37	913-0066	Burner Box Assembly	x			
37	913-0067	Burner Box Assembly		x	x	
37	913-0070	Burner Box Assembly				x
38	104X925	Right Blower Angle			x	x
38	104X926	Right Blower Angle	x	x		

Date: 12-15-94
Supersedes: 02-01-94

FUNCTIONAL COMPONENTS

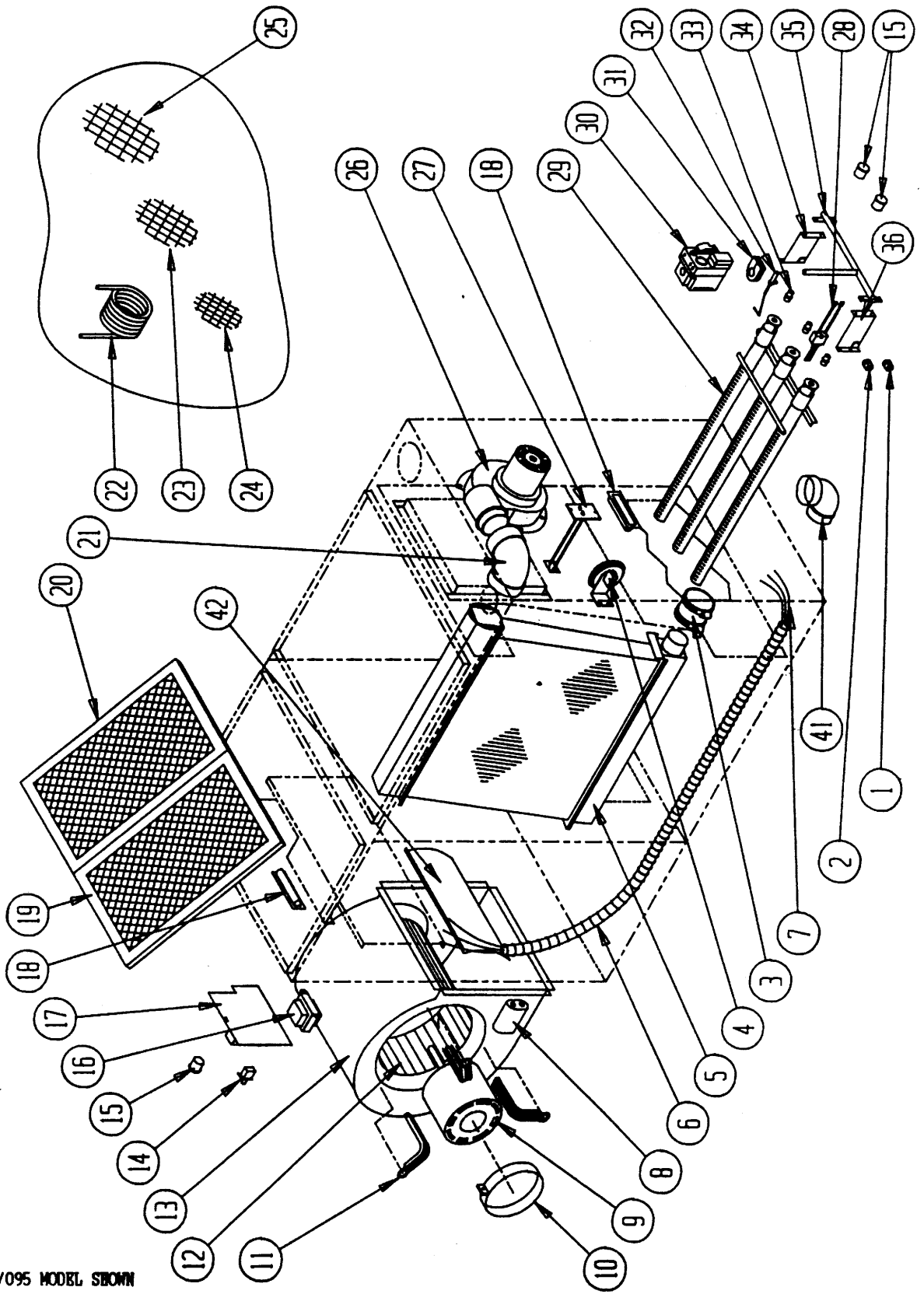

DC1080/095 MODEL SHOWN

Date: 07-18-94
Supersedes: 02-01-94

2110-867
Page: 4

FUNCTIONAL COMPONENTS

Dwg. No.	Part No.	Description	D C L O 6 5 D 3 6 A	D C L O 8 0 D 4 8 A	D C L O 9 5 D 6 0 A	D C L O 1 1 0 D 6 0 A
1	8611-074	Double Terminal Bushing	X	X	X	X
2	8611-073	Single Terminal Bushing	X	X	X	X
3	6093-007	No-Hub Connector	X	X	X	X
4	8406-069	Pressure Switch	X			
4	8406-070	Pressure Switch		X	X	X
5	5055-004	Coil Assembly		X		
5	5055-003	Coil Assembly	X		X	X
6	S8611-089	Plastic Wire Channel	X	X	X	X
7	3000-1014	Wire Harness	X	X	X	X
8	8552-002	Capacitor 5 MFD 370V	X			
8	8552-004	Capacitor 7-1/2 MFD 370V		X		
8	8552-026	Capacitor 15 MFD 370V			X	
8	8552-034	Capacitor 15 MFD 440V				X
9	8105-037	1/3 HP Motor 115V	X			
9	8106-033	1/2 HP Motor 115V		X		
9	8107-007	3/4 HP Motor 115V			X	
9	8107-008	3/4 HP Motor 115V				X
10	8200-033	Motor Mount Band	X	X	X	X
11	8200-034	Motor Mount Arm	X	X		
11	8200-035	Motor Mount Arm			X	X
12	5152-013	Blower Wheel	X			
12	5152-059	Blower Wheel		X		
12	5152-053	Blower Wheel			X	
12	5152-072	Blower Wheel				X
12	5152-073	Blower Wheel				X
13	151-085	Blower Housing	X			
13	151-082	Blower Housing		X		
13	5152-050	Blower Housing (1)			X	
13	151-102	Left Blower Housing				X
13	151-103	Right Blower Housing				X
14	8406-047	Door Switch	X	X	X	X
15	8611-075	Sight Glass	X	X	X	X
16	8407-039	Transformer 40VA	X	X	X	X
17	5651-084	Furnace Control	X	X	X	X
18	1171-025	Door Pull	X	X	X	X
19	7003-023	9.5 x 20 Permanent Filter	2			
19	7003-016	13 x 20 Permanent Filter		1	1	2
20	7003-021	10 x 20 Permanent Filter		1	1	
21	6095-006	High Temperature Elbow	X	X	X	X
22	5452-005-6000	Vinyl Drain Hose	X	X	X	X

(1) Drawing No. 13 part No.5152-050 includes housing, diffuser, and wheel part No. 5152-053.

Date: 07-18-94
Supersedes: 02-01-94

2110-867
Page: 5

CONTROL PANEL WIRE ASSEMBLIES

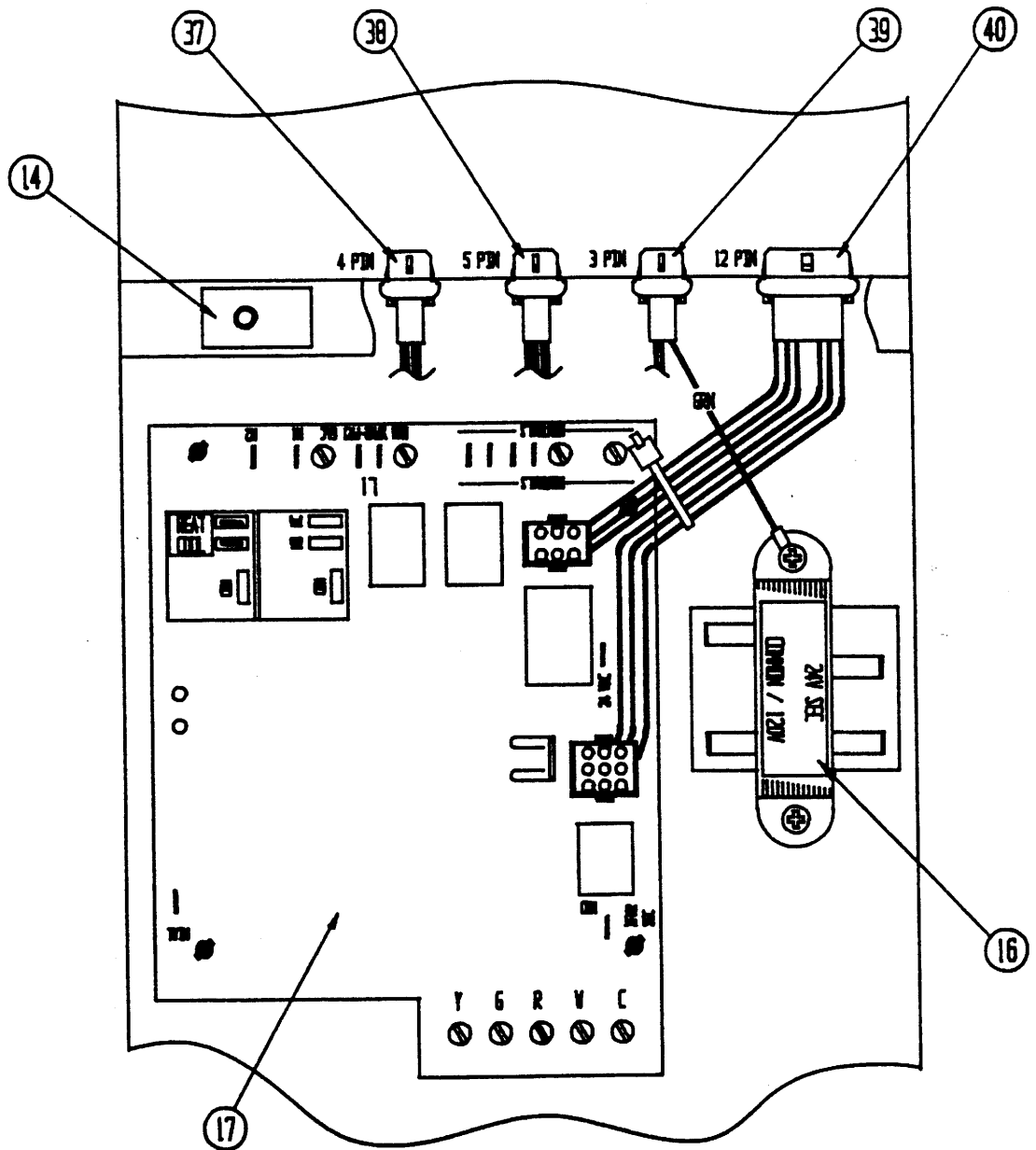

Date: 02-01-94
Supersedes:

2110-867
Page: 6

FUNCTIONAL COMPONENTS

Dwg. No.	Part No.	Description	D	D	D	D
			C	C	C	C
			L	L	L	L
			O	O	O	O
			6	8	9	1
			5	0	5	0
			D	D	D	D
			3	4	6	6
			6	8	0	0
			A	A	A	A
23	7002-023	Bird Screen 2.875 Diameter	2			
24	7002-022	Bird Screen 2.375 Diameter	2			
25	7002-024	Bird Screen 3.500 Diameter	2	2	2	
25	7002-025	Bird Screen 4.500 Diameter				2
26	8620-084	Induced Draft Blower	x	x	x	x
27	8402-089	Limit 230 degree F	x			
27	8402-078	Limit 175 degree F		x	x	x
28	8553-003	Ignitor	x	x	x	x
29	9010-061	Burner 2 cell	x			
29	9010-062	Burner 3 cell		x	x	
29	9010-063	Burner 4 cell				x
30	5651-083	Gas Valve	x			
30	5651-089	Gas Valve		x	x	
30	5651-106	Gas Valve				x
31	5451-017	Manifold Grommet	x	x	x	x
32	8554-016	Sensor	x	x	x	x
33	9010-043	Gas Orifice #36	2			
33	9010-057	Gas Orifice 2.45MM		3		
33	9010-052	Gas Orifice 2.70MM			3	
33	9010-010	Gas Orifice #38				4
34	S112X194	Right Manifold Bracket	x	x	x	x
35	5818-028	Gas Manifold	x			
35	5818-029	Gas Manifold		x	x	
35	5818-030	Gas Manifold				x
36	S112Y194	Left Manifold Bracket	x	x	x	x
37	3000-1019	4 Pin Wire Assenbly	x	x	x	x
38	3000-1018	5 Pin Wire Assenbly	x	x	x	x
39	3000-1016	3 Pin Wire Assenbly	x	x	x	x
40	3000-1013	12 Pin Wire Assenbly	x	x	x	x
41	6095-005	2" PVC Street Elbow	x	x	x	
41	6095-008	2" ABS Street Elbow				x
42	144-127	Diffuser	x			
42	144-129	Diffuser		x		
42	(1) N/A	Diffuser			x	
42	144-167	Diffuser				x

(1) Drawing No. 13 part No. 5152-050 includes diffuser.

Date: 07-18-94
Supersedes: 02-01-94

2110-867

Page: 7