Replacement Parts Manual

HIGH EFFICIENCY GAS FURNACE

Models:

DCL065D36D DCL080D48D
DCL095D60D DCL110D60D

General Notes

- Revised and/or additional pages may be issued from time to time.
- A complete and current manual consists of pages shown in the following contents section.

Contents

Description	Page
Cabinet Components	
• Exploded View	1
• Usage List	2
• Usage List	3
• Blank Page.....	4
Functional Components and Control Panel Wire Assemblies	
◆ Exploded View	5
• Usage List	6
• Usage List	7
• Exploded View	8



BARD MANUFACTURING COMPANY
Bryan, Ohio 43506

Since 1914...Moving ahead, just as planned.

Manual: 211 Q-878
Supersedes:
Date: 06-19-98

CABINET COMPONENTS

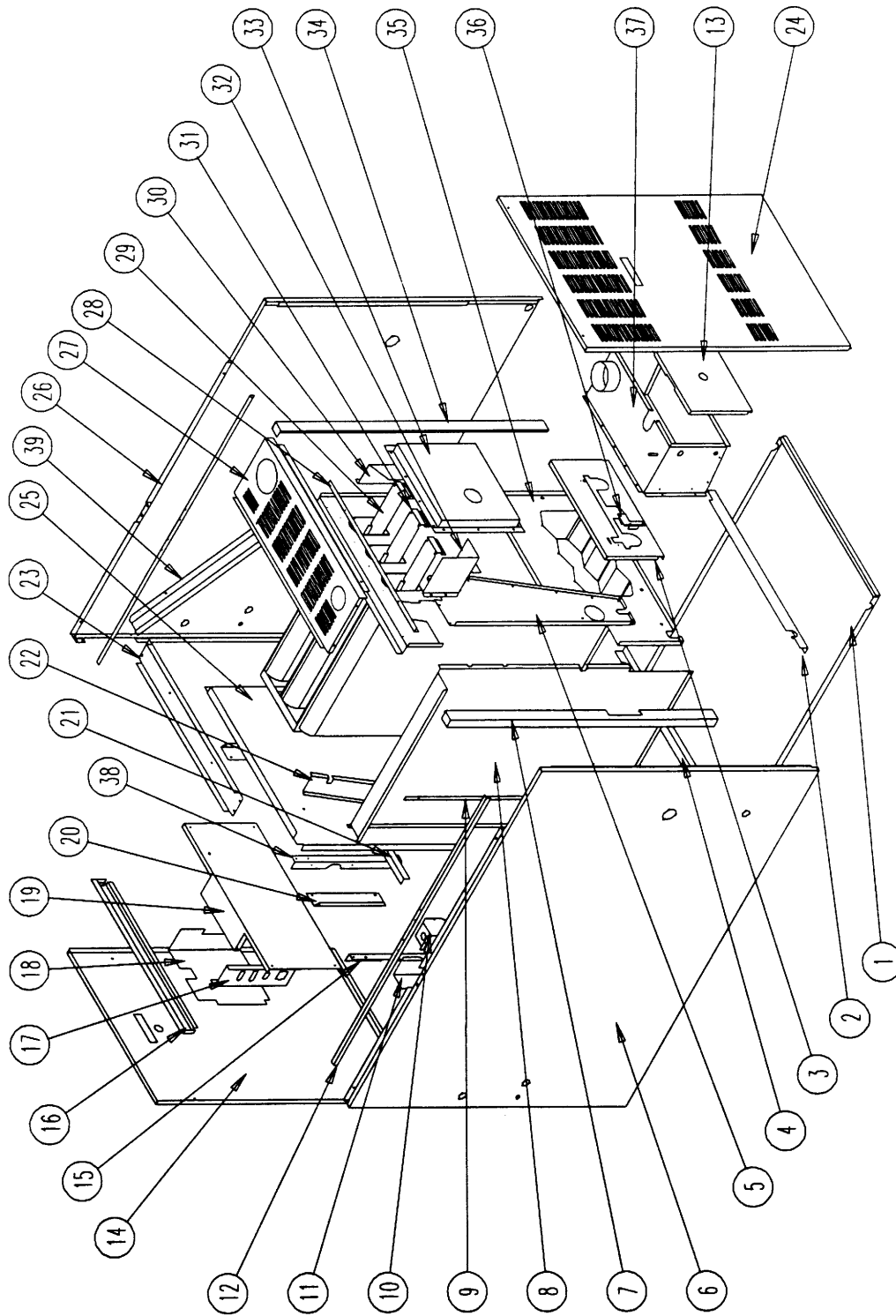

SEXP-207

This Exploded View references the Tables on Page 2 & 3

CABINET COMPONENTS

Drawing No.	Part No.	Description	DCLO65D36D	DCLO80D48D	DCLO95D60D	DCL110D60D
1	S126-232	Base Assembly	X			
1	S126-233	Base Assembly		X	X	
1	S126-234	Base Assembly				X
2	104-917	Front Base Angle	X			
2	104-918	Front Base Angle		X	X	
2	104-919	Front Base Angle				X
3	168-050	Secondary Air Restrictor	X			
3	168-055	Secondary Air Restrictor		X	X	
3	168-060	Secondary Air Restrictor				X
4	104-920	Rear Base Angle	X			
4	104-921	Rear Base Angle		X	X	
4	104-922	Rear Base Angle				X
5	520-227	Coil Partition Assembly	X	X	X	X
6	500-283	Left Side Assembly	X	X	X	X
7	S104-889	Left Side Angle	X	X	X	X
8	S120-270	Internal Coil Partition	X	X	X	X
9	134-142	Coil Air Deflector	X	X	X	X
10	116-130	Junction Box	X	X	X	X
11	132-107	Junction Box Cover	X	X	X	X
12	104-934	Side Top Support Angle	X	X	X	X
13	S168-052	Burner Box Cover	X			
13	S168-058	Burner Box Cover		X	X	
13	S168-063	Burner Box Cover				X
14	S552-233	Blower Door Assembly	X			
14	S552-234	Blower Door Assembly		X	X	
14	S552-235	Blower Door Assembly				X
15	104Y925	Lower Blower Angle			X	X
15	104Y926	Lower Blower Angle	X	X		
16	108-104	Upper Back	X			
16	108-105	Upper Back		X	X	
16	108-106	Upper Back				X
17	116-166	Control Panel Plug Support	X	X	X	X
18	132-219	Control Panel Cover	X	X	X	X
19	116-217	Control Panel	X			
19	116-211	Control Panel		X	X	
19	116-218	Control Panel				X
20	116-164	Control Panel Support	2	2	2	2

This Table references Exploded View on Page 1

CABINET COMPONENTS

Drawing No.	Part No.	Description	DCLO65D36D	DCLO80D48D	DCLO95D60D	DCL110D60D
21	104-936	Filter Support Angle	X			
21	104-935	Filter Support Angle		X	X	
21	104-937	Filter Support Angle				X
22	S136-272	Internal Coil Fill	X	X	X	X
23	164-545	Top Channel	X			
23	164-546	Top Channel		X	X	
23	164-547	Top Channel				X
24	S152-209	Vestibule Door	X			
24	S152-216	Vestibule Door		X	X	
24	S152-217	Vestibule Door				X
25	520-261	Blower Partition Assembly	X			
25	520-262	Blower Partition Assembly		X	X	
25	520-263	Blower Partition Assembly				X
26	500-282	Right Side Assembly	X	X	X	X
27	S106-152	Top Fille Assembly	X			
27	S106-151	Top Fille Assembly		X	X	
27	S106-153	Top Fille Assembly				X
28	104-895	Top Fill Angle	X			
28	104-896	Top Fill Angle		X	X	
28	104-897	Top Fill Angle				X
29	168-002	Internal Flue Baffle	2	3	3	2
30	134-121	Intake Air Shield	X			
31	168-013	Internal Flue Baffle				2
32	134-120	Vent Air Shield	X	X	X	X
33	S168-054	Collector Box Assembly	X			
33	S168-081	Collector Box Assembly		X	X	
33	S168-064	Collector Box Assembly				X
34	S104-903	Right Side Angle	X	X	X	X
35	171-216	Heat Exchanger Assembly	X			
35	171-217	Heat Exchanger Assembly		X	X	
35	171-218	Heat Exchanger Assembly				X
36	112-147	Ignitor Bracket	X	X	X	X
37	913-0066	Burner Box Assembly	X			
37	913-0067	Burner Box Assembly		X	X	
37	913-0070	Burner Box Assembly				X
38	104X925	Right Blower Angle			X	X
38	104X926	Right Blower Angle	X	X		
39	130-108	Filter Support	2	2	2	
39	130-109	Filter Support				2

This Table references Exploded View on Page 1

FUNCTIONAL COMPONENTS

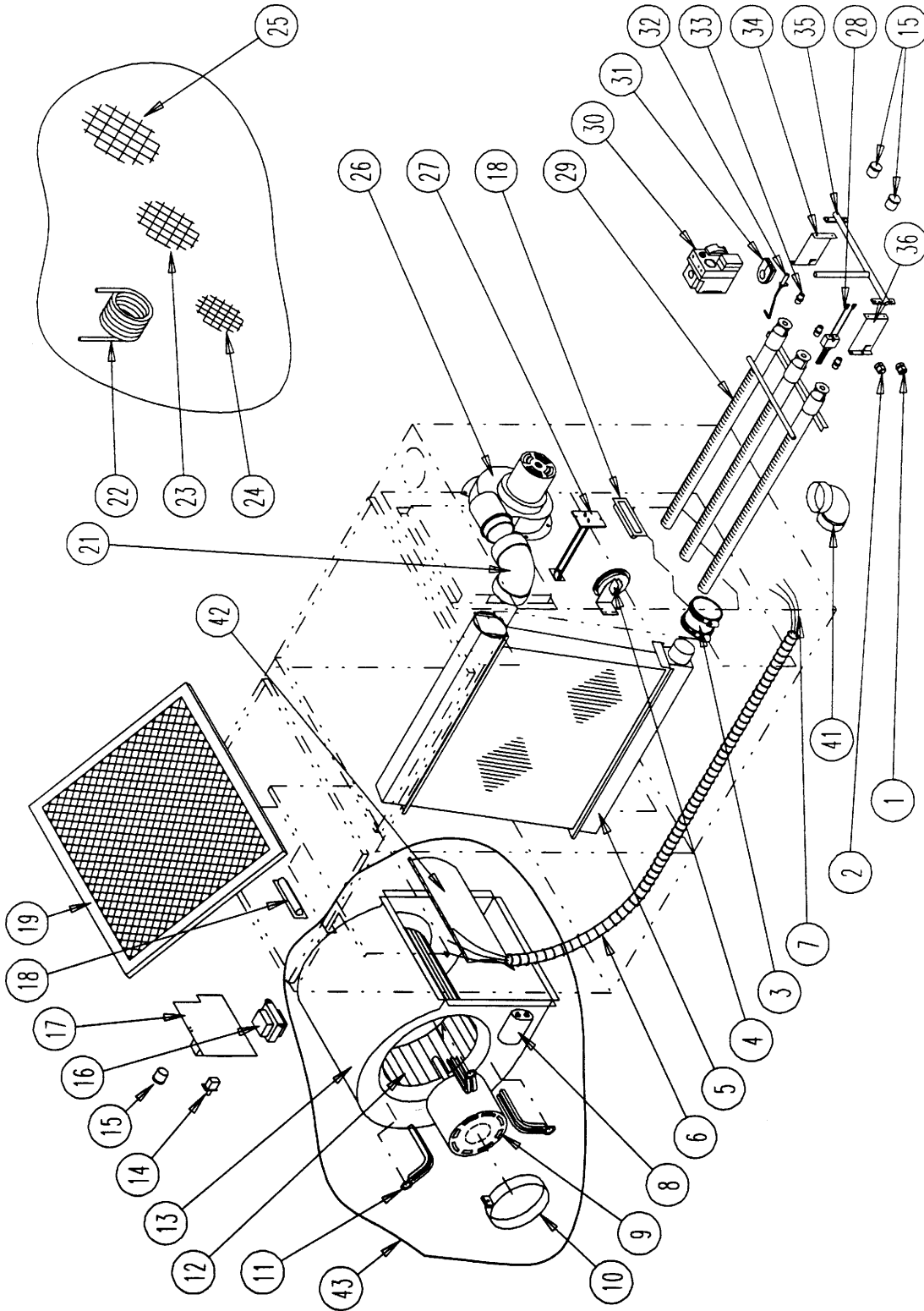

SEXP-208

This Exploded View references the Tables on Page 6 & 7

FUNCTIONAL COMPONENTS and CONTROL PANEL WIRES

Drawing No.	Part No.	Description	DCLO65D36D	DCLO80D48D	DCLO95D60D	DCL110D60D
1	8611-074	Double Terminal Bushing	X	X	X	X
2	8611-073	Single Terminal Bushing	X	X	X	X
3	6093-007	No-Hub Connector	X	X	X	X
4	8406-099	Pressure Switch	X			
4	8406-100	Pressure Switch		X	X	X
5	5055-004	Coil Assembly		X		
5	5055-003	Coil Assembly	X		X	X
6	S8611-089	Plastic Wire Channel	X	X	X	X
7	3000-1014	Wire Harness	X	X	X	X
8	8552-002	Capacitor 5 MFD 370V	X			
8	8552-004	Capacitor 7-1/2 MFD 370V		X		
8	8552-026	Capacitor 15 MFD 370V			X	
8	8552-034	Capacitor 15 MFD 440V				X
9	8105-041	1/3 HP Motor 115V	X			
9	8106-033	1/2 HP Motor 115V		X		
9	8107-007	3/4 HP Motor 115V			X	
9	8107-008	3/4 HP Motor 115V				X
10	8200-033	Motor Mount Band	X	X	X	X
11	8200-034	Motor Mount Arm	X	X		
11	8200-035	Motor Mount Arm			X	X
12	5152-013	Blower Wheel	X			
12	5152-059	Blower Wheel		X		
12	5152-053	Blower Wheel			X	
12	5152-072	Blower Wheel				X
12	5152-073	Blower Wheel				X
13	151-085	Blower Housing	X			
13	151-082	Blower Housing		X		
13	5152-050	Blower Housing (1)			X	
13	151-102	Left Blower Housing				X
13	151-103	Right Blower Housing				X
14	8406-047	Door Switch	X	X	X	X
15	8611-075	Sight Glass	X	X	X	X
16	8407-045	Transformer 40VA	X	X	X	X
17	5651-144	Furnace Control	X	X	X	X
18	1171-025	Door Pull	X	X	X	X
19	7003-040	16 x 20 Washable Filter	X			
19	7003-041	20 x 20 Washable Filter		X	X	
19	7003-042	20 x 25 Washable Filter				X
21	6095-006	High Temperature Elbow	X	X	X	X
22	5452-005-6000	Vinyl Drain Hose	X	X	X	X

(1) Drawing No. 13 part no. 5152-050 includes housing, diffuser, and wheel part no. 5152-053.

This Table references Exploded Views on Page 5 & Page 8

FUNCTIONAL COMPONENTS and CONTROL PANEL WIRES

Drawing No.	Part No.	Description	DCLO65D36D	DCLO80D48D	DCLO95D60D	DCL110D60D
23	7002-023	Bird Screen 2.875 Diameter	2			
24	7002-022	Bird Screen 2.375 Diameter	2			
25	7002-024	Bird Screen 3.500 Diameter	2	2	2	
25	7002-025	Bird Screen 4.500 Diameter				2
26	8620-084	Induced Draft Blower	X	X	X	X
27	8402-089	Limit 230 degrees F	X			
27	8402-078	Limit 175 degrees F		X	X	X
28	8553-003	Ignitor	X	X	X	X
29	9010-070	Burner 2 cell	X			
29	9010-071	Burner 3 cell		X	X	
29	9010-072	Burner 4 cell				X
30	5651-083	Gas Valve	X			
30	5651-089	Gas Valve		X	X	
30	5651-106	Gas Valve				X
31	5451-017	Manifold Grommet	X	X	X	X
32	8554-016	Sensor	X	X	X	X
33	9010-043	Gas Orifice #36	2			
33	9010-057	Gas Orifice 2.45mm		3		
33	9010-052	Gas Orifice 2.70mm			3	
33	9010-010	Gas Orifice #38				4
34	S112X194	Right Manifold Bracket	X	X	X	X
35	5818-028	Gas Manifold	X			
35	5818-029	Gas Manifold		X	X	
35	5818-030	Gas Manifold				X
36	S112Y194	Left Manifold Bracket	X	X	X	X
37	3000-1087	4 Pin Wire Assembly	X	X	X	X
38	3000-1018	5 Pin Wire Assembly	X	X	X	X
39	3000-1016	3 Pin Wire Assembly	X	X	X	X
40	3000-1013	12 Pin Wire Assembly	X	X	X	X
41	6095-005	2" PVC Street Elbow	X	X	X	
41	6095-008	2" ABS Street Elbow				X
42	144-127	Diffuser	X			
42	144-129	Diffuser		X		
42	N/A (1)	Difuser			X	
42	144-167	Diffuser				X
43	S900-202	Blower Assembly	X			
43	S900-203	Blower Assembly		X		
43	S900-204	Blower Assembly			X	
43	S900-205	Blower Assembly				X

(1) Drawing no. 13 part no. 5152-050 includes diffuser.

This Table references Exploded Views on Page 5 & Page 8

CONTROL PANEL WIRE ASSEMBLIES

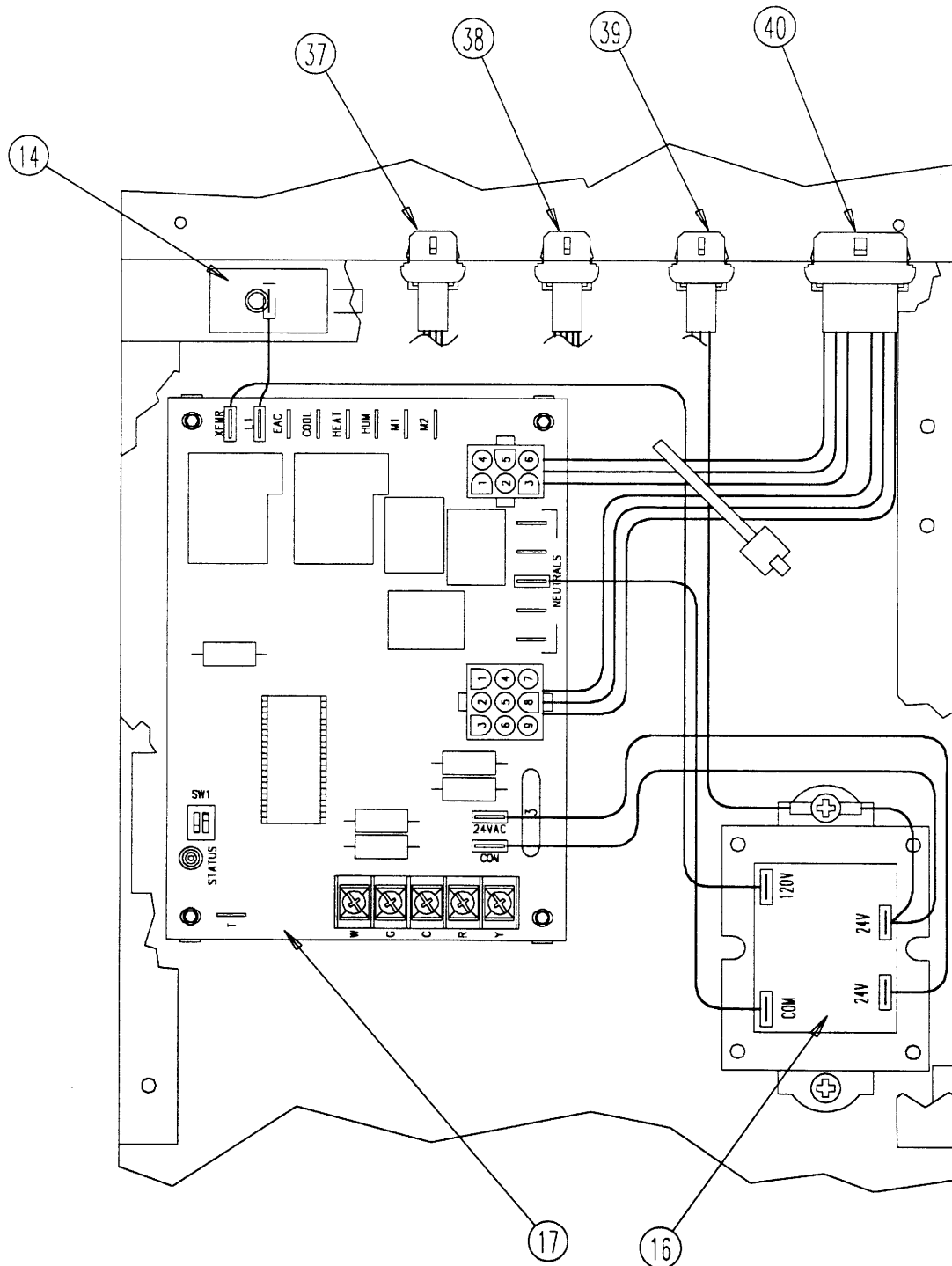

SEXP-299