

REPLACEMENT PARTS MANUAL

OIL FIRED FURNACE MODELS OS95D36A, OS125D48A, OS140B48A, OS196B60A

Manual 2110-906

Revision --

Date 12-21-89

Supersedes

* GENERAL NOTES *

*Revised and/or additional pages may be issued from time to time.
*A complete and current manual consists of pages dated as shown in the following index.

** INDEX **

<u>Page Description</u>	<u>Page</u>	<u>Date</u>	<u>Supersedes</u>
Functional Components--Exploded View	1	12-21-89	
" " --Usage List	2	12-21-89	
Burner Components --Exploded View	3	12-21-89	
" " --Usage List	4	12-21-89	
Cabinet Components --Usage List	5	12-21-89	

*** IMPORTANT ***

Contact the installing and/or local Bard distributor for all parts requirements. Make sure you have the complete model and serial number available from the unit rating plate.

FUNCTIONAL COMPONENTS

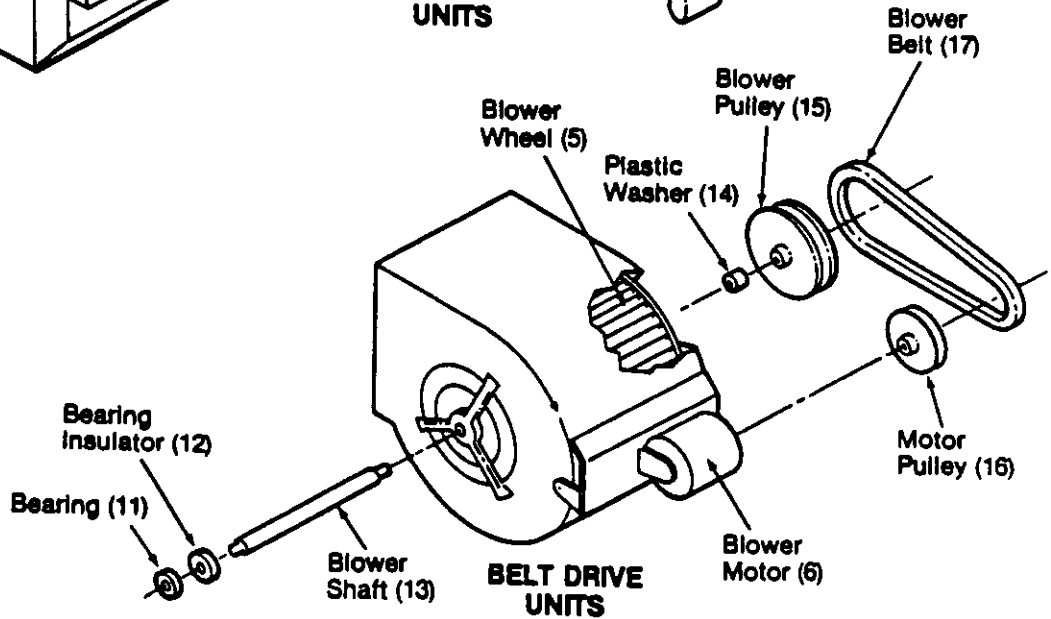
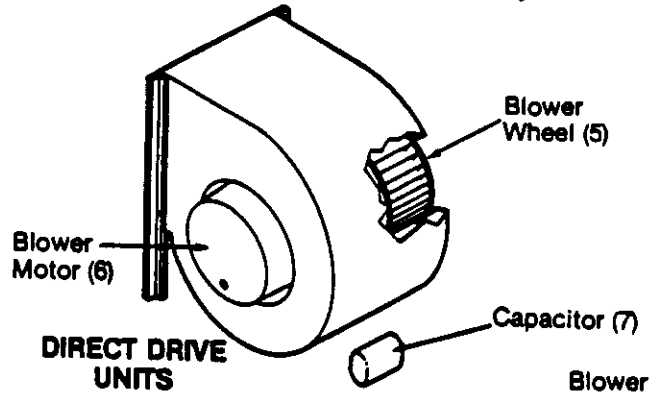
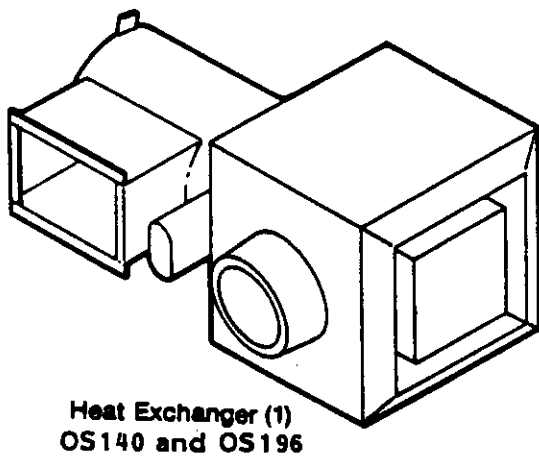
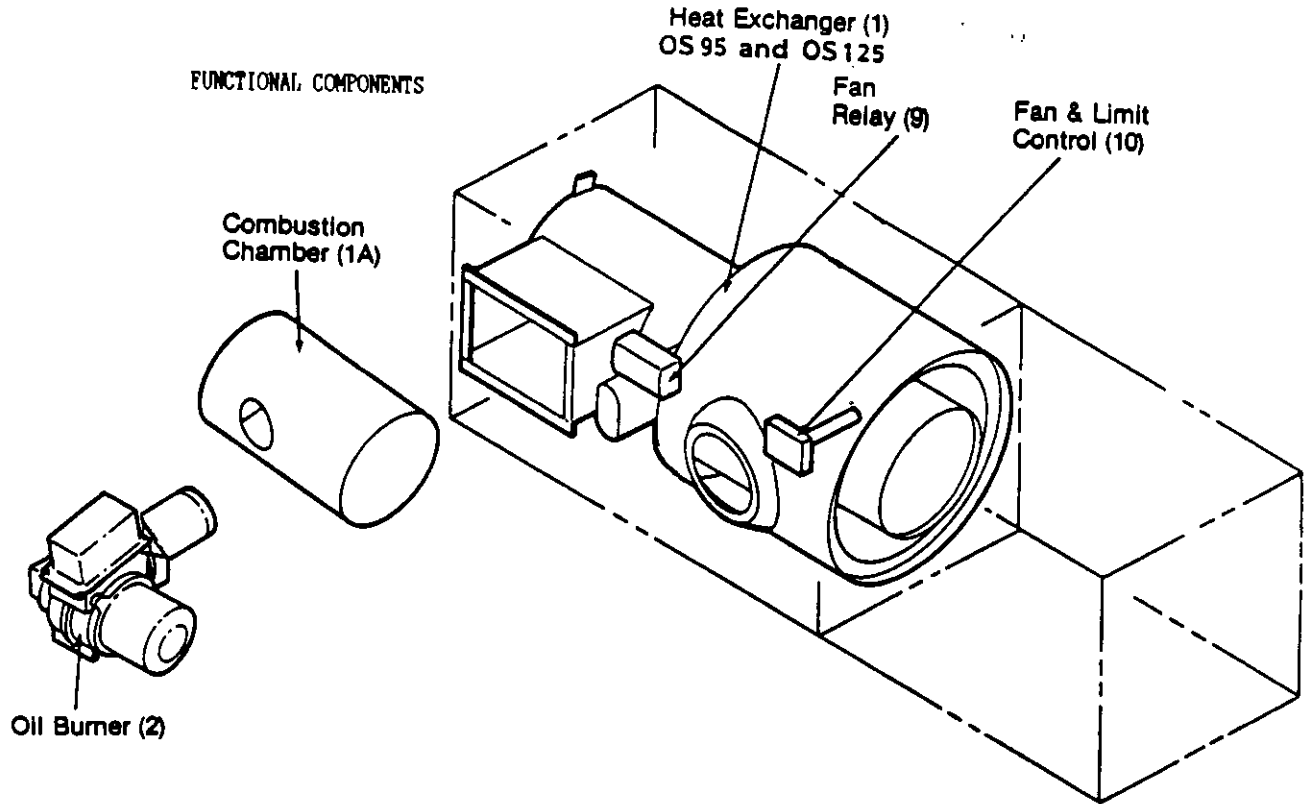

Date: 12-21-89
Supersedes:

FUNCTIONAL COMPONENTS

Dwg. No.	Part No.	Description	OS95D36A	OS125D48A	OS140B48A	OS196B60A
1	9045-009	Heat Exchanger Assembly	X			
1	9045-010	Heat Exchanger Assembly		X		
1	9045-042	Heat Exchanger Assembly			X	
1	9045-043	Heat Exchanger Assembly				X
NS	9045-044	Cover Radiator Cleanout			X	X
NS	9045-016	Gasket Cover Cleanout			X	X
1A	9045-138	Combustion Chamber Wet Pack	X			
1A	9045-139	Combustion Chamber Wet Pack		X		
1A	9045-045	Combustion Chamber			X	
1A	9045-046	Combustion Chamber				X
2	9045-018	Oil Burner 1-Stage	X	X		
2	9045-047	Oil Burner 1-Stage			X	
2	9045-048	Oil Burner 1-Stage				X
5	5152-013	Blower Wheel 10-8DD	X			
5	5152-014	Blower Wheel 10-9 DD		X		
5	5152-006	Blower Wheel 10-10 BD			X	
5	5152-005	Blower Wheel 12-12BD				X
6	9045-001	Motor 1/3 hp D.D. 1075 2-Speed	X			
6	9045-002	Motor 1/2 hp D.D. 1050 3-Speed		X		
6	8107-001	Motor 3/4 hp B.D. 1725 RPM 5/8"			X	X
7	8552-001	Capacitor 4 MFD 370V	X			
7	8552-002	Capacitor 5 MFD 370V		X		
9	8201-006	40VA Transformer & Relay	X	X	X	X
10	8402-001	Fan/Limit Control 11"	X	X	X	X
11	9045-025	Bearing 3/4"			2	2
12	9045-026	Insulator--Bearing			2	2
13	9045-028	Blower Shaft 15-5/8"			1	
13	9045-080	Blower Shaft 18"				1
14	9045-031	Washer--Plastic			2	2
15	5501-017	Blower Pulley 5 x 3/4			X	X
16	5501-003	Motor Pulley 4 x 1/2			X	
16	9045-036	Motor Pulley 3-1/4 x 5/8				X
17	5601-005	Belt 40"			X	
17	5601-007	Belt 42"				X
NS	8200-033	D.D. Motor Mount--Band	X	X		
NS	9045-039	D.D. Motor Mount--Arms	3	3		

NS--Not Shown

Date: 12-21-89
Supersedes:

Beckett

Burner Replacement Parts

Oil Burners

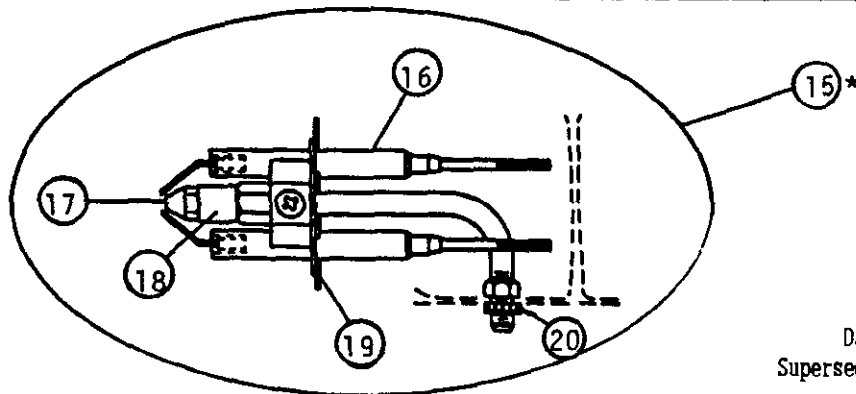
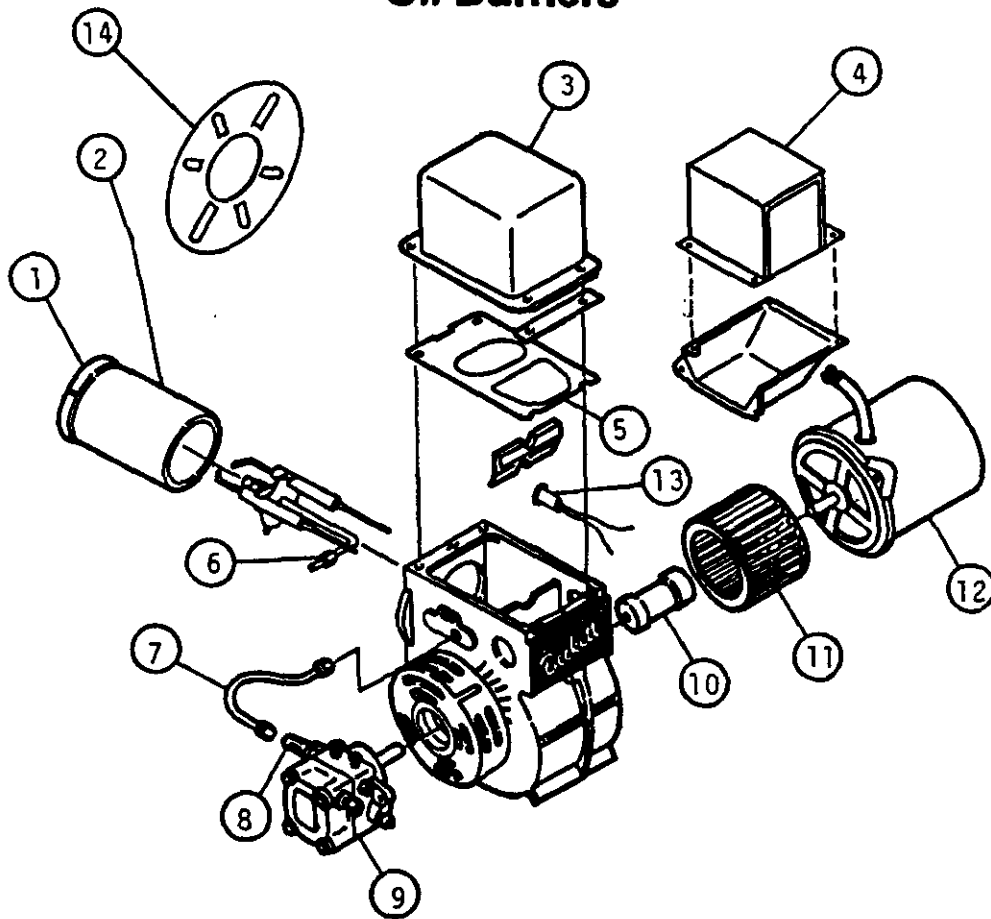

Nozzle Line Electrode Assembly

*Nozzle is not included in assembly.

Date: 12-21-90
Supersedes:

2110-906
Page 3

BURNER COMPONENTS

Dwg. No.	Part No.	Beckett Part No.	Description	O S 9 5 D 3 6 A	O S 1 2 5 D 4 8 A	O S 1 4 0 B 4 8 A	O S 1 9 6 B 4 8 A
1	9022-026	F12	Head			X	X
1	9022-025	R4	Head	X	X		
2	9022-027	3294058K	Air Tube and Flange Assembly 9"	X	X		
2	9022-028	3294071BK	Air Tube			X	
2	9022-029	3294091BK	Air Tube				X
3	9022-022	5878U	Transformer w/Gasket AFG	X	X	X	X
4	8400-001		Primary Control	X	X	X	X
5	9022-006	31405	Transformer Gasket	X	X	X	X
6	9022-007	571801	Bulkhead Fitting	X	X	X	X
7	9022-008	5636	Connector Tube	X	X	X	X
8	9022-009	2256	Pump Outlet Elbow	X	X	X	X
9	9022-010	2460U	Pump, Single Stage	X	X	X	X
10	9022-011	2454	Coupling	X	X	X	X
11	9022-012	2459U	Blower	X	X	X	X
12	9022-013	2456U	Motor 1/7 HP 3450 RPM	X	X	X	X
13	9022-020	5963001	Cad Cell	X	X	X	X
14	9022-021	3811	Mounting Flange Gasket	X	X		
14	9022-030	3416	Gasket			X	X
15	9022-032	NL65X0	Nozzle Line Electrode Assembly			X	
15	9022-033	NL85X0	Nozzle Line Electrode Assembly				X
15	9022-031	NL53XZ	Nozzle Line Electrode Assembly	X	X		
16	9022-017	5780	Electrode Assembly (set of 2)	X	X	X	X
17	9011-002		Nozzle .85 GPH 80 degree A	X			
17	9011-004		Nozzle 1.10 GPH 80 degree A		X		
17	9045-023		Nozzle 1.25 GPH 70 Degree Solid			X	
17	9045-024		Nozzle 1.75 GPH 70 Degree Solid				X
18	9022-016	213U	Nozzle Adapter, Single	X	X	X	X
19	9022-023	3384P	Static Plate 3-3/8"	X	X	X	X
20	9022-018	3666	Bulkhead Fitting Locknut	X	X	X	X

Date: 12-21-89
Supersedes:

CABINET COMPONENTS

Part No.	Vendor Number	Description	O S 9 5 D 3 6 A	O S 1 2 5 D 4 8 A	O S 1 4 0 B 4 8 A	O S 1 9 6 B 6 0 A	B C 1 9 6
*	28786C1	Blower Access Door	2				
*	28786C3	Blower Access Door		2			
*	2089C4	Blower Access Doors			2		
9045-065	2089C7	Blower Access Doors					2
*	30863B	Warm Air Cap Assembly	X				
9045-142	30864B	Warm Air Cap Assembly		X			
*	28796C	Cold Air Cap Assembly	X				
*	28797C	Cold Air Cap Assembly		X			
*	28804B7	Front Panel	X				
*	28804B8	Front Panel		X			
*	34278C2	Front Panel			2		
*	34277C2	Front Panel				2	2
9045-137	28787B	Rear Panel	X				
*	28788B	Rear Panel		X			
*	34278C1	Rear Panel			X		
*	34277C1	Rear Panel				X	X
*	28789B	Top and Bottom Panels	2				
9045-141	31090B	Top and Bottom Panels		2			
9045-098	33449C1	Top and Bottom Panels			2		
9045-063	2901C	Top and Bottom Panels				2	
*	2906C	Top and Bottom Panels					2
*	28793C	Blower Division Panel	X				
*	28794C	Blower Division Panel		X			
*	2087C2	Blower Division Panel			X		
*	2087C4	Blower Division Panel				X	
9045-073	32203C	Blower Division Panel					X
*	2127B2	Inspection Door			X	X	
9045-105	30394A	Observation Door	X	X			
*	2094C2	Corner Posts			2		
9045-072	2094C3	Corner Posts					2
*	3128A3	Cleanout Cover Assembly			2	2	
9045-066	7404D1	Carton					X
9045-067	7403D1	Carton				X	

*Contact factory for information.

Date: 01-18-90
Supersedes: